



Northumberland  
Properties

**Narrowgate, Alnwick**  
**£275,000**





## 22 Narrowgate

Alnwick

Council Tax band: TBD

Tenure: Leasehold

- Duplex apartment arranged over two spacious floors
- Three generous double bedrooms
- Stunning views towards Alnwick Castle
- French doors opening to a Juliet balcony
- Immaculately presented throughout
- Spacious living room with stone fireplace and log-burning stove
- Successful holiday let with investment pot
- Prime town centre location within walking distance of amenities and attractions











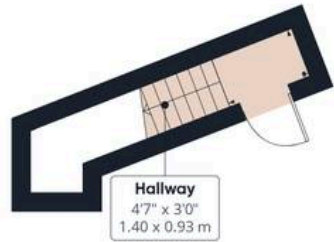

**First Floor**



**Floor 1**



**Floor 2**



**Approximate total area<sup>(1)</sup>**

1446 ft<sup>2</sup>

134.5 m<sup>2</sup>

(1) Excluding balconies and terraces

Reduced headroom

----- Below 5 ft/1.5 m

Calculations reference the RICS IPMS 3C standard. Measurements are approximate and not to scale. This floor plan is intended for illustration only.

**GIRAFFE360**



Occupying a superb position in the very heart of Alnwick, Castle View is an exceptional three-bedroom duplex apartment enjoying magnificent views towards Alnwick Castle and offering beautifully presented accommodation arranged over two spacious floors.

The property presents a versatile opportunity for a range of purchasers, whether seeking a permanent residence, second home, investment property or lifestyle retreat within one of Northumberland's most popular market towns.

**Utilities:**

Gas central heating

Mains Waste

Mains Water

Mains Electric

**Grade II listed**



## Northumberland Properties

12 Market Street, Alnwick - NE66 1TL

01665660910 • [info@northumberlandproperties.co.uk](mailto:info@northumberlandproperties.co.uk) • [www.northumberlandproperties.co.uk](http://www.northumberlandproperties.co.uk)



Northumberland  
Properties