



Orchard Way, Goffs Oak



- POPULAR ROAD
- CLOSE TO JUNIOR SCHOOL
- QUIET LOCATION
- BEAUTIFULLY PRESENTED
- SUPER ROOM
- 4 BEDROOMS
- EN-SUITE SHOWER ROOM
- LUXURY BATHROOM WITH SHOWER



Orchard Way Goffs Oak EN7 5NW

Tucked away in a sought-after, tranquil setting just moments from Goffs Oak Primary School, this beautifully refurbished four-bedroom home blends contemporary elegance with exceptional comfort. Finished to an impeccable standard, it offers a superb modern lifestyle across three spacious levels. Step inside to a welcoming entrance hall, a stylish living room, and a sleek downstairs cloakroom. The heart of the home is the stunning open-plan kitchen/living/dining space—flooded with natural light and seamlessly connected to the terrace and landscaped rear garden via elegant bi-folding doors. Upstairs, the first floor hosts three well-proportioned bedrooms and a luxurious family bathroom with both bath and shower. The top floor is dedicated to the impressive principal suite, complete with a Juliet balcony offering far-reaching views and a beautifully appointed en-suite shower room.

Orchard Way is a pleasant cul de sac in the heart of Goffs Oak village, close to the shops and amenities of both Goffs Oak and Cuffley and a short distance from Cuffley Station with its overground rail link to London Moorgate via Finsbury Park and Highbury & Islington. Goffs Oak JMI is within walking distance, there is a choice of good primary and secondary schools locally

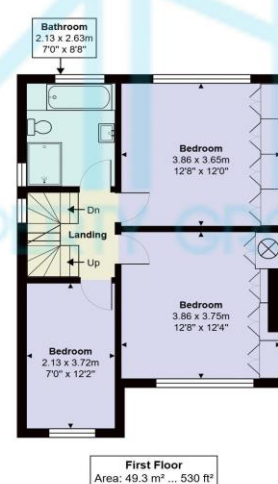

BANC
PROPERTY GROUP

Orchard Way, Goffs Oak, EN7 5NW
Total Area: 175.9 m² ... 1894 ft² (excluding garden)

All measurements are approximate and for display purposes only