



Greycoat Street, SW1P

£825,000

A contemporary apartment with good ceiling height, plenty of light and a balcony, two well-proportioned bedrooms with fitted storage, 2 bathrooms. This would make a good London home, pied-à-terre or rental investment.

Rowan House is an attractive building set in a pretty quiet tree lined street just a few minutes from Vincent Square. The block offers excellent security with a day-time porter a lift and private parking.

Features

- Two Double Bedrooms
- Parking
- Porter
- Lift
- Second Floor
- Balcony

Greycoat Street, London, SW1P

Second Floor

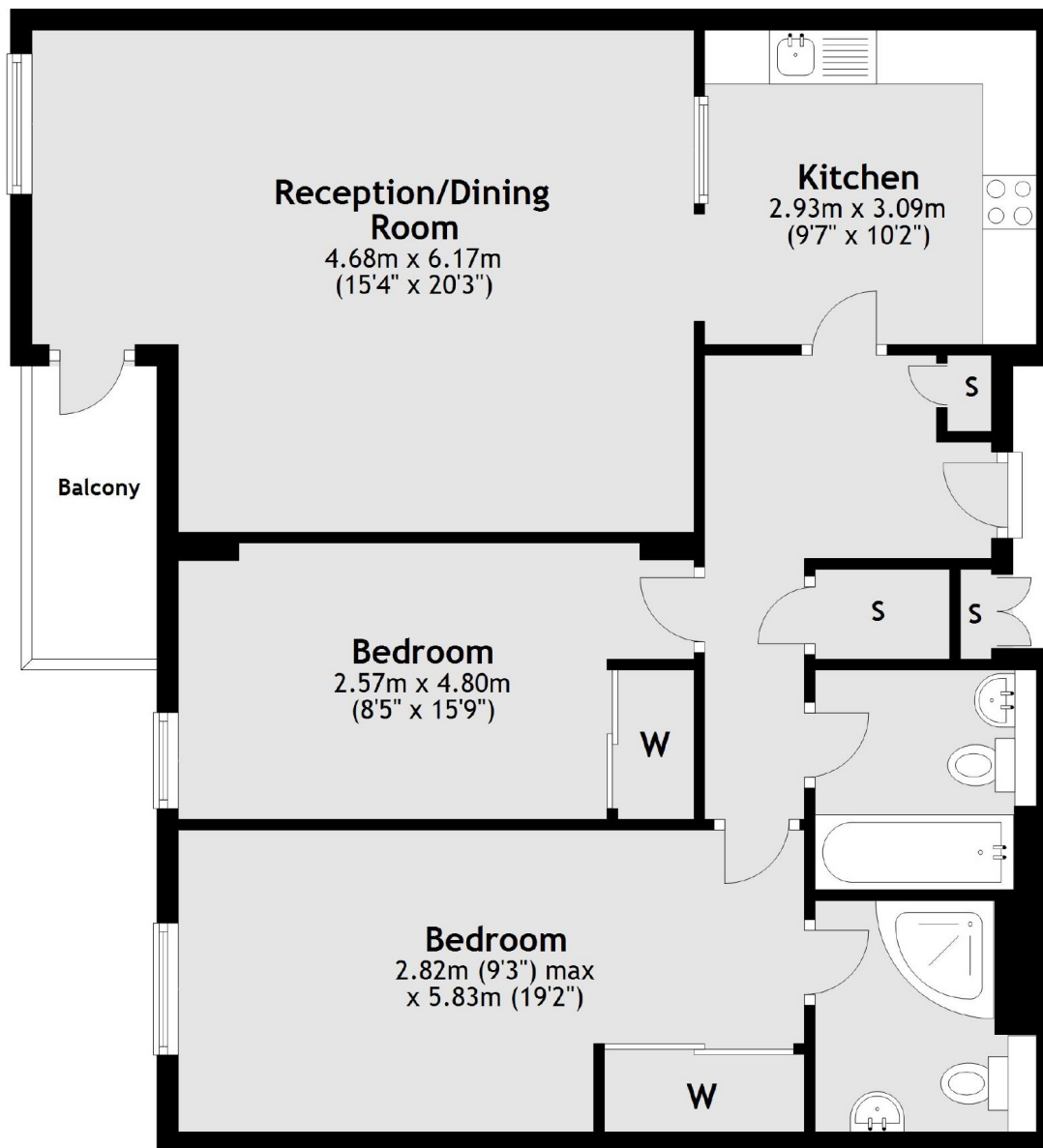

Total area: approx. 84.7 sq. metres (911.5 sq. feet)