



Carnation Way, Lavender Grange Aylesbury HP21 8TX

welcome to

Carnation Way, Lavender Grange Aylesbury

The property itself is arranged over two floors, the ground floor comprises lounge/diner with French doors to a private rear garden that is laid to lawn with patio area and timber shed. A fitted kitchen with eye and base units and space for appliances. On the first floor is the bathroom with three piece suite including bath, wash hand basin and WC, the two double bedrooms span both the front and rear of the house and the master room benefits from fitted wardrobes.



Accommodation Comprises

Entrance Hall

Lounge/dining room

15' 1" x 12' 3" (4.60m x 3.73m)

Kitchen

9' 4" x 5' 10" (2.84m x 1.78m)

First Floor & Landing

Bedroom One

9' 10" x 8' 6" (3.00m x 2.59m)

Bedroom Two

8' 10" x 9' 1" (2.69m x 2.77m)

Bathroom

Outside

Rear Garden

Parking

Please Note:

Property is currently tenanted.

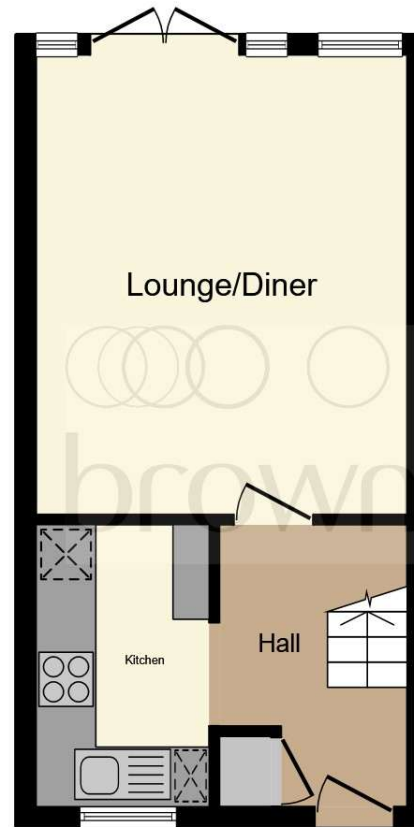

Ground Floor

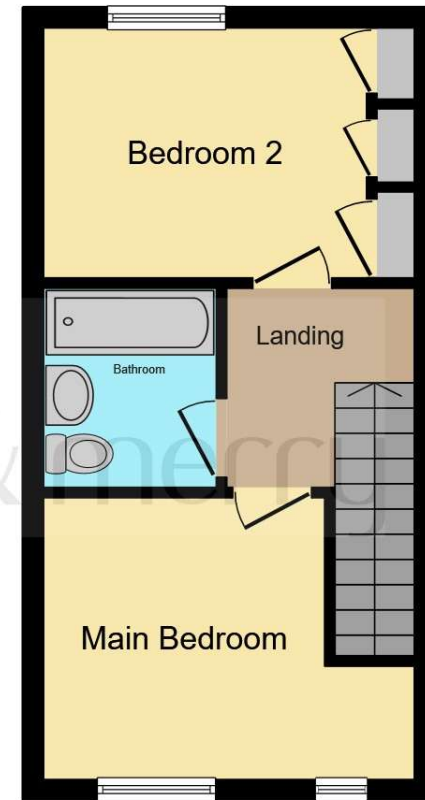

First Floor

This plan is for illustration purposes only and may not be representative of the property. Plan not to scale.

Powered by audioagent.com



view this property online brownandmerry.co.uk/Property/AYL115925



welcome to

Carnation Way, Lavender Grange Aylesbury

- TWO DOUBLE BEDROOM HOUSE
- POPULAR LAVENDER GRANGE DEVELOPMENT
- LOUNGE/ DINER
- KITCHEN
- BATHROOM
- REAR GARDEN
- OFF ROAD PARKING
- NO UPPER CHAIN

Tenure: Freehold EPC Rating: C
Council Tax Band: C

£279,250



view this property online [brownandmerry.co.uk/Property/AYL115925](https://www.brownandmerry.co.uk/Property/AYL115925)



Property Ref:
AYL115925 - 0006

1. MONEY LAUNDERING REGULATIONS Intending purchasers will be asked to produce identification documentation at a later stage and we would ask for your co-operation in order that there is no delay in agreeing the sale. 2. These particulars do not constitute part or all of an offer or contract. 3. The measurements indicated are supplied for guidance only and as such must be considered incorrect. Potential buyers are advised to recheck measurements before committing to any expense. 4. We have not tested any apparatus, equipment, fixtures or services and it is in the buyers interest to check the working condition of any appliances. 5. Where an EPC, or a Home Report (Scotland only) is held for this property, it is available for inspection at the branch by appointment. If you require a printed version of a Home Report, you will need to pay a reasonable production charge reflecting printing and other costs. 6. We are not able to offer an opinion either written or verbal on the content of these reports and this must be obtained from your legal representative. 7. Whilst we take care in preparing these reports, a buyer should ensure that his/her legal representative confirms as soon as possible all matters relating to title including the extent and boundaries of the property and other important matters before exchange of contracts.

Brown & Merry is a trading name of Sequence (UK) Limited which is registered in England and Wales under company number 4268443, Registered Office is Cumbria House, 16-20 Hockliffe Street, Leighton Buzzard, Bedfordshire, LU7 1GN. VAT Registration Number is 500 2481 05.

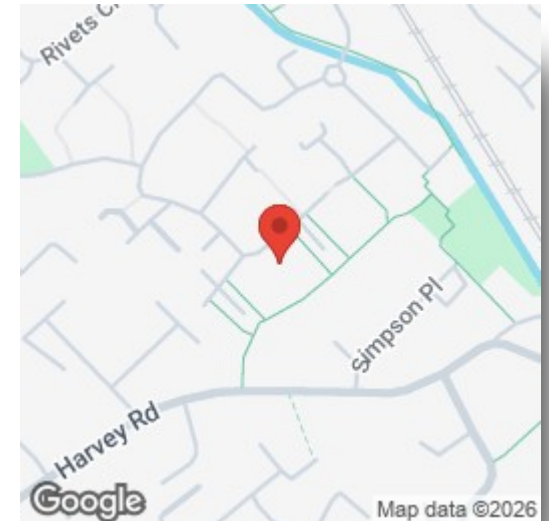

Please note the marker reflects the
postcode not the actual property

brown & merry



01296 488111



Aylesbury@brownandmerry.co.uk



5-7 Market Street, AYLESBURY,
Buckinghamshire, HP20 2PN



[brownandmerry.co.uk](https://www.brownandmerry.co.uk)