

FREEHOLD



House - Semi-Detached

# 1 YORK AVENUE, SIDCUP, DA15 7LJ

Asking price

## £650,000

### FEATURES

- FOUR BEDROOM SEMI-DETAHCED CHALET STYLE HOME
- VERY POPULAR AND DESIRABLE LOCATION
- IN NEED OF MODERNISATION
- LARGE CORNER PLOT
- DETACHED GARAGE PLUS DRIVEWAY



# 4 Bedroom House - Semi-Detached located in Sidcup

Westwood Sidcup are pleased to offer as a CHAIN FREE sale this extended four bedroom semi-detached chalet style home. Occupying a large corner plot on York and Gloucester Avenue the desirable location is close to Sidcup Train Station and a wealth of amenities. In brief the accommodation on offer comprises entrance hall, bay fronted living room, open plan kitchen/dining area overlooking the rear garden, ground floor fourth bedroom and a bathroom. The first floor includes three good size family bedrooms and a shower room. Although the home is in need of modernisation we believe it is a great opportunity for someone to make a beautiful home on a great road. Benefitting from gas central heating, double glazing and a detached garage we highly recommend an internal viewing.

Call us on

**020 8301 5511**

[sales@westwoodpropertyservices.co.uk](mailto:sales@westwoodpropertyservices.co.uk)

**Council Tax Band**

**F**

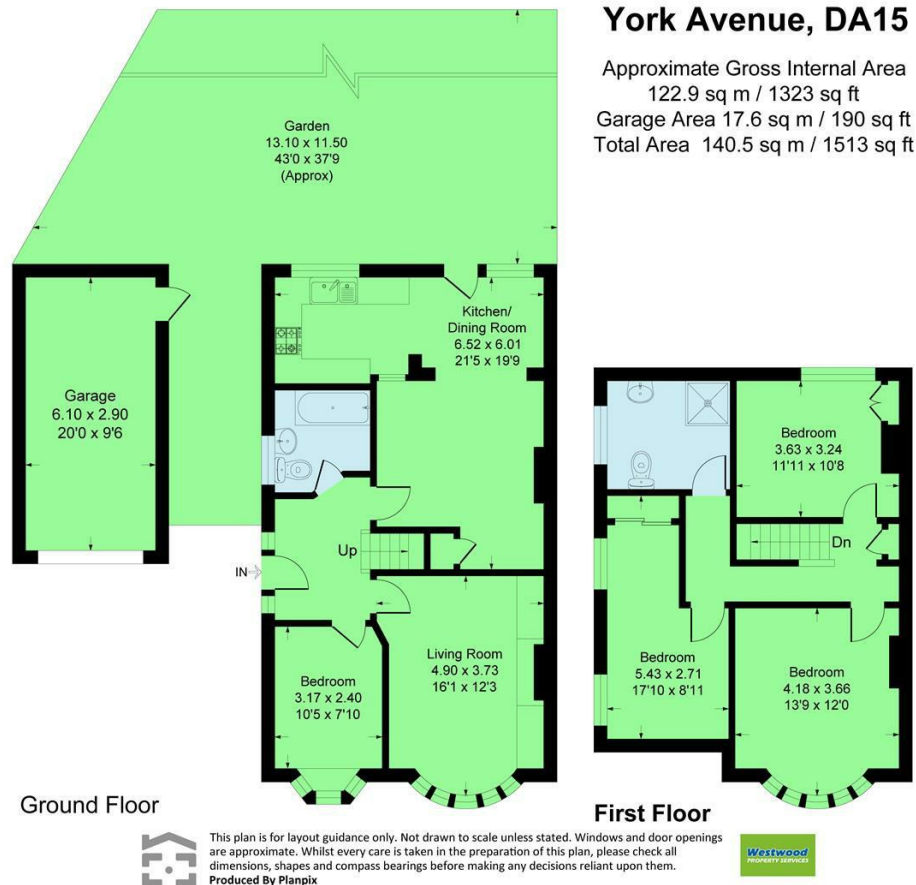

Energy Efficiency Rating		Current	Potential
<i>Very energy efficient - lower running costs</i>			
(92 plus)	A		
(81-91)	B		
(69-80)	C		
(55-68)	D		
(39-54)	E	53	68
(21-38)	F		
(1-20)	G		
<i>Not energy efficient - higher running costs</i>			
<b>England &amp; Wales</b>		EU Directive 2002/91/EC	

Agents Note: Whilst every care has been taken to prepare these particulars, they are for guidance purposes only. All measurements are approximate and are for general guidance purposes only and whilst every care has been taken to ensure their accuracy, they should not be relied upon and potential buyers are advised to recheck the measurements.

