



9 Lovejoy Lane, Windsor, Berkshire, SL4 4ND
Offers in excess of £255,000

 **HORLER**

9 Lovejoy Lane, Windsor, Berkshire, SL4 4ND

*** NO ONWARD CHAIN ***

A well-presented two-bedroom second-floor apartment, recently refurbished to a high standard. The accommodation comprises a spacious lounge, a fitted kitchen, two generously sized bedrooms, a family bathroom, a separate WC, and a large entrance hallway with ample storage.

Further benefits include well-maintained communal grounds and off-road parking. Early viewing is highly recommended.



Entrance

Enter through a communal front door with entry phone system and stairs rising to the second floor.

Hallway / study area

Wood effect laminate flooring and power points.

Living room

With two side aspect UPVC double glazed windows, radiator, power points and wood effect laminate flooring.

Kitchen

A range of eye and base level units with a complimentary work top, inset sink and drainer, a side aspect UPVC double glazed window, appliance space for a washing machine, dishwasher and fridge freezer. Integrated hob, oven and extractor fan, a wall mounted boiler, power points, tiled walls and flooring.

Master bedroom

A double bedroom with a rear aspect UPVC double glazed window, radiator, power points and space for freestanding furniture.

Bedroom two

A double bedroom with a rear aspect UPVC double glazed window, radiator, power points and space for freestanding furniture.

Bathroom

A fully tiled bathroom with a front aspect UPVC frosted double glazed window, panel enclosed bath with shower attachments and shower screen, a pedestal wash hand basin and heated towel rail.

Separate WC

A front aspect frosted UPVC double glazed window, low level WC and a wall mounted sink.

Lease information

Lease: 89

Service charge: To be confirmed

Ground rent: £10 approx

Legal note

Although these particulars are thought to be materially correct, their accuracy cannot be guaranteed and they do not form part of any contract.





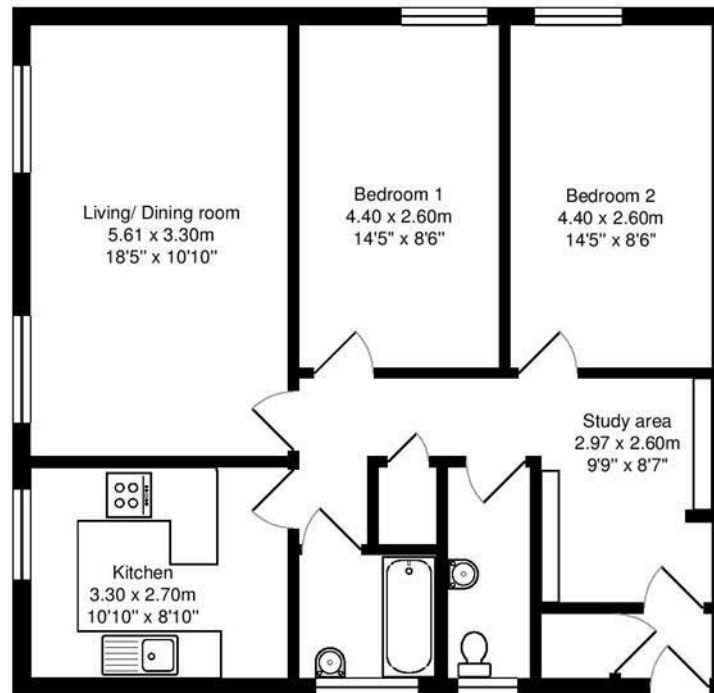

All measurements are approximate and for display purposes only.

Total approx floor area 750 sq. ft (69.7 sq.m)