

Floor Plan

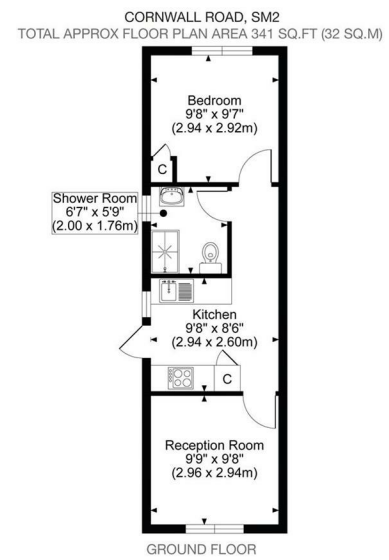

All measurements, walls, doors, windows, fittings and their appliances, their size and locations are shown conventionally and are approximate only and cannot be regarded as being a representation either by the seller or his agent.

optic
MEDIA
optimedia.co.uk

For illustration purposes only



All dimensions and measurements are approximate and for guidance only.

Just Centro's Opinion...

A well-presented self-contained annex situated on the sought-after Cornwall Road in Sutton, offering comfortable and private accommodation ideal for a single professional or a couple.

The property benefits from its own private side entrance and comprises a modern fitted kitchen with built-in appliances and a gas hob, a separate shower room, a spacious double bedroom, and a separate lounge, providing excellent living space and flexibility.

Located on a quiet and popular residential road, the property also benefits from free on-street parking. Sutton and Cheam stations are both within walking distance, offering excellent transport links, while a range of local shops, restaurants, and amenities are easily accessible nearby.

This attractive annex is suitable for either a single occupant or a couple and is available to view immediately. Early viewing is highly recommended.

Additional Photos

