

## Three bed Terraced House for sale - £89,950

North Street - Spennymoor



**Council Tax Band: A**

**EPC Rating:**

SUPERBLY presented, Generously proportioned Three Bedroom Mid-Terraced House within walking distance to the town centre and all the local amenities of Spennymoor Town Centre. Accommodation offers Entrance hallway into two large reception rooms, modern fitted kitchen with intergrated appliances, rear lobby into ground floor bathroom, spacious landing to three bedrooms. Externally an enclosed rear yard. The property is Double Glazed with gas fired central heating system.

**Bathrooms 1**

**Beds 3**



- SUPERB THREE BEDROOM TERRACED HOUSE
- TWO LARGE RECEPTION ROOMS
- GROUND FLOOR BATHROOM

- GAS FIRED CENTRAL HEATING SYSTEM
- DOUBLE GLAZING
- ENCLOSED REAR YARD

SCAN FOR DETAILS

### **Entrance Hallway**

UPVC double glazed entrance door.

### **Lounge 14' 0" x 15' 0" (4.26m x 4.57m)**

UPVC Double glazed window to front, double doors into dining room.

### **Dining Room 14' 0" x 15' 0" (4.26m x 4.57m)**

UPVC Double glazed window to rear, understairs storage cupboard housing boiler, double doors into Lounge.

### **Kitchen 8' 0" x 13' 0" (2.44m x 3.96m)**

UPVC Double glazed window to side, matching wall and base units, eye level oven and microwave with electric hob and extractor hood, stainless steel sink unit and mixer tap, space for fridge/freezer, integrated washing machine.

### **Rear Lobby**

UPVC Double glazed door to rear, door to ground floor bathroom.

### **Ground Floor Bathroom**

UPVC Double glazed window to side, bath with mixer tap shower over, W/C, hand basin vanity unit, chrome heated towel rail.

### **First Floor Landing**

UPVC Double glazed window to rear, loft access.

### **Bedroom One 15' 0" x 11' 0" (4.57m x 3.35m) into alcove**

UPVC Double glazed window to rear.

### **Bedroom Two 11' 0" x 15' 0" (3.35m x 4.57m)**

UPVC Double glazed window to front.

### **Bedroom Three 7' 0" x 12' 0" (2.13m x 3.65m)**

UPVC Double glazed window to front.

### **Externally**

Enclosed rear yard with timber gate.



These details are for guidance only and complete accuracy cannot be guaranteed. If there is at any point, which is of particular importance, verification should be obtained. They do not constitute a contract or part of a contract. All measurements are approximate. No guarantee can be given with regard to planning permissions or fitness for purpose. No apparatus, equipment, fixture or fitting has been tested. Items shown in photographs are NOT necessarily included. Interested Parties are advised to check availability and make an appointment to view before travelling to see a property.

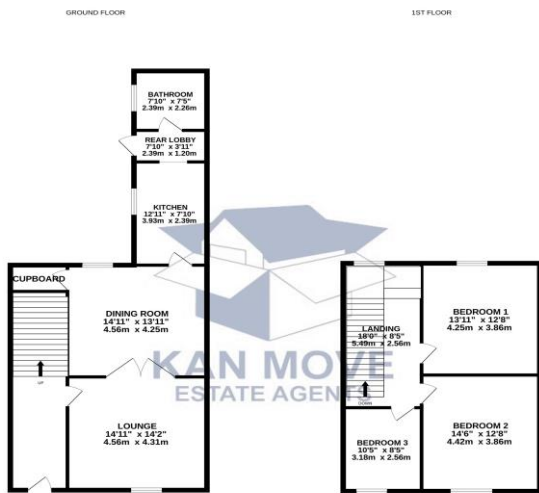

8 NORTH STREET

© Kan Move Sales Ltd 2024. All rights reserved. This floor plan is for information only and should not be used for any other purpose. Measurements are approximate and should be verified by a professional surveyor. The agent is not responsible for any errors or omissions. Map data © OpenStreetMap contributors, Imagery © Mapbox



**Kan Move Sales**  
 38 High Street, Spennymoor, Co. Durham DL16 6DB  
 01388 417270  
 info@kanmove.com  
 Kanmove.com