

Floorplan

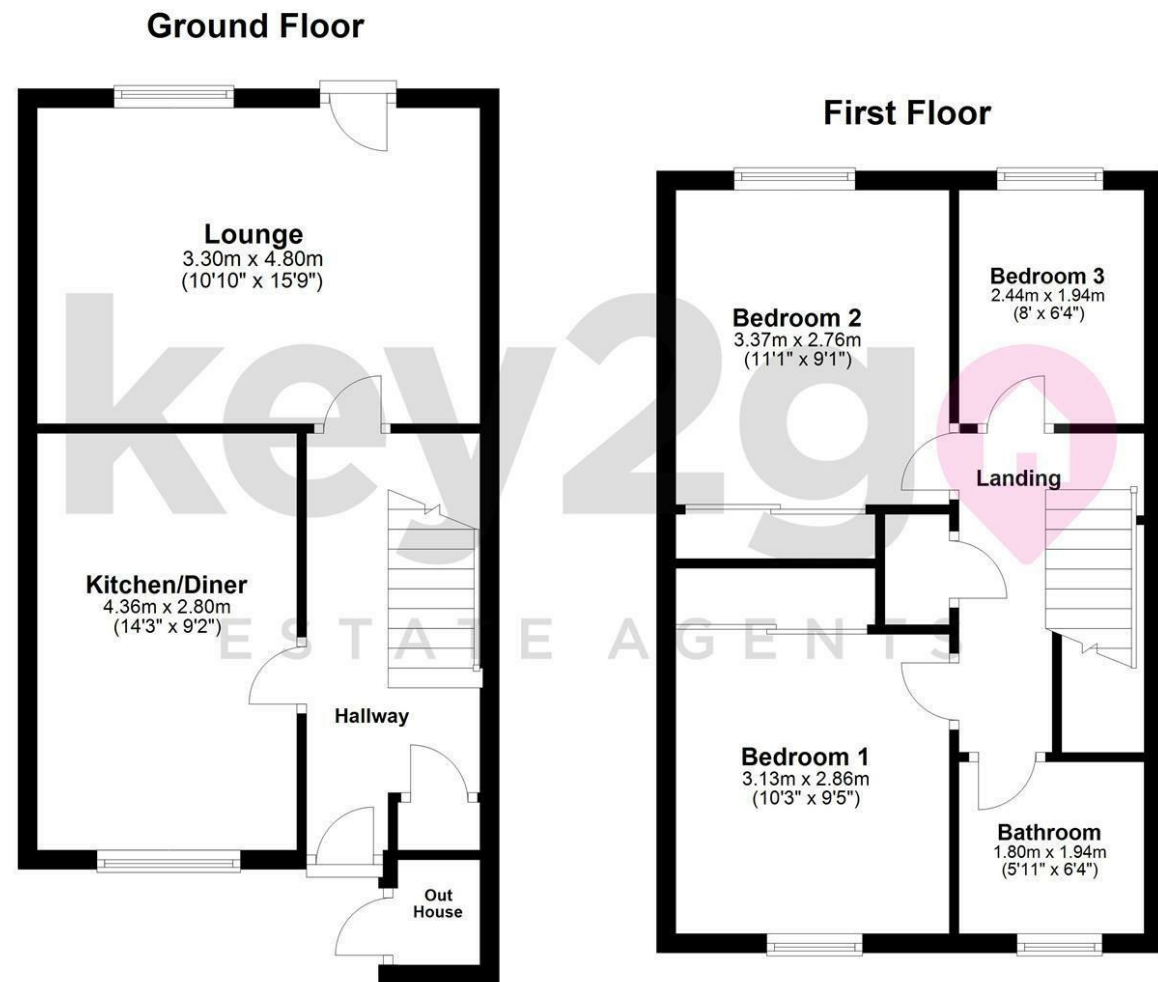

Area Map



Energy Efficiency Graph

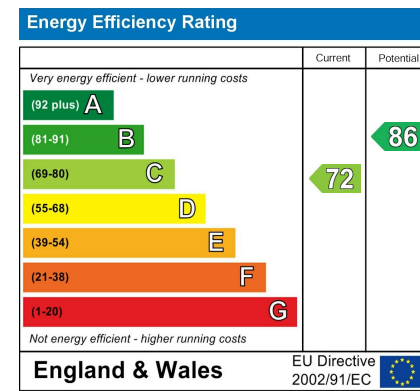

15 Wickfield Grove
Sheffield, S12 4TL

£995 PCM



Viewing

Please contact our Lettings Team Office on 0114 2478819 if you wish to arrange a viewing appointment for this property or require further information.

These particulars, whilst believed to be accurate are set out as a general outline only for guidance and do not constitute any part of an offer or contract. Intending purchasers should not rely on them as statements of representation of fact, but must satisfy themselves by inspection or otherwise as to their accuracy. No person in this firm's employment has the authority to make or give any representation or warranty in respect of the property.



15 Wickfield Grove

Sheffield, S12 4TL

£995 PCM



A beautifully presented three bedroom semi-detached home to rent in a popular area! The property offers a modern open plan kitchen/diner with white goods included, contemporary bathroom, two double bedrooms with built-in wardrobes, and one single bedroom. Externally, there is a driveway providing off-road parking for two cars, along with front and rear gardens!

