



# Turners Gardens

Wootton, Northampton

oriordanbond  
SALES & LETTINGS





GROUND FLOOR  
564 sq.ft. (52.4 sq.m.) approx.

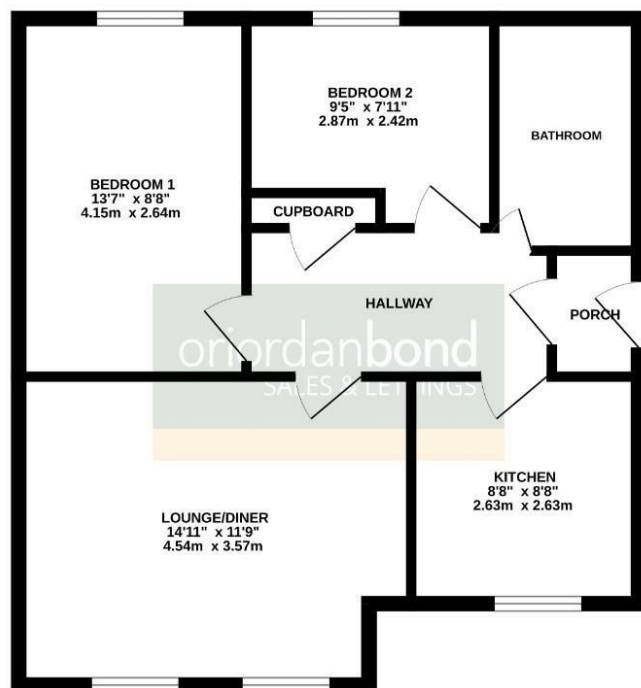

TOTAL FLOOR AREA: 564 sq.ft. (52.4 sq.m.) approx.  
Whilst every attempt has been made to ensure the accuracy of the floorplan contained here, measurements of doors, windows, rooms and any other items are approximate and no responsibility is taken for any error, omission or misstatement. This plan is for illustrative purposes only and should be used as such by any prospective purchaser. The services, systems and appliances shown have not been tested and no guarantee as to their operability or efficiency can be given.  
Made with Blueprints 3.0.0.0

## Turners Gardens

Wootton

NN4 6LZ

25% SHARED OWNERSHIP £45,000

O'Riordan Bond is delighted to bring to the market this well presented two bedroom first floor apartment, offered on a 25% shared ownership basis, situated in the popular area of Wootton, ideal for first time buyers looking to step onto the property ladder.

The accommodation comprises entrance hall, spacious dual aspect sitting/dining room, modern fitted kitchen with built-in oven and gas hob, two bedrooms and a three-piece bathroom suite with shower over bath. Benefits include uPVC double glazing, gas radiator heating and one allocated parking space. (A/564/-)

AGENTS NOTE: Under the Estate Agents Act 1979, we hereby notify you that the vendor is an employee (or relative of an employee) for the selling agents O'Riordan Bond

Leasehold Information: Lease Remaining - 102 years (as of 2026) / Rent on Remaining Share - £375 pcm (includes Service Charge)

### Additional information

- Council Tax Band: B
- Energy Efficiency Rating:

### Viewing

Viewing strictly by appointment – details below

### Disclaimer

O'Riordan Bond Estate Agents Limited has not tested apparatus, equipment, fittings or services and so cannot verify they are in working order. The buyer is advised to obtain verification from their solicitor or surveyor.

O'Riordan Bond Grange Park Sales  
01604 432007

grangepark@oriordanbond.co.uk

