

Brandon Court Rhyl LL18 3DG

£120,000

🛏 2 🚿 1 🚗 1



Presenting this well-appointed first floor two-bedroom flat, ideally located in this popular development. This property offers comfortable living within close proximity to a wide range of local amenities, ensuring everyday essentials and leisure needs are conveniently met. Enjoy excellent access to public transport links, providing easy connectivity to surrounding areas, and within walking distance of the Town Centre.

Key Features

- A two bedroom first floor flat
- Gas central heating
- Suited to a variety of purchasers
- Viewing advised
- Leasehold / EPC - C
- A fine example of a well presented Flat
- upvc double glazing
- First floor
- Garage and Allocated parking
- 23/10/2025

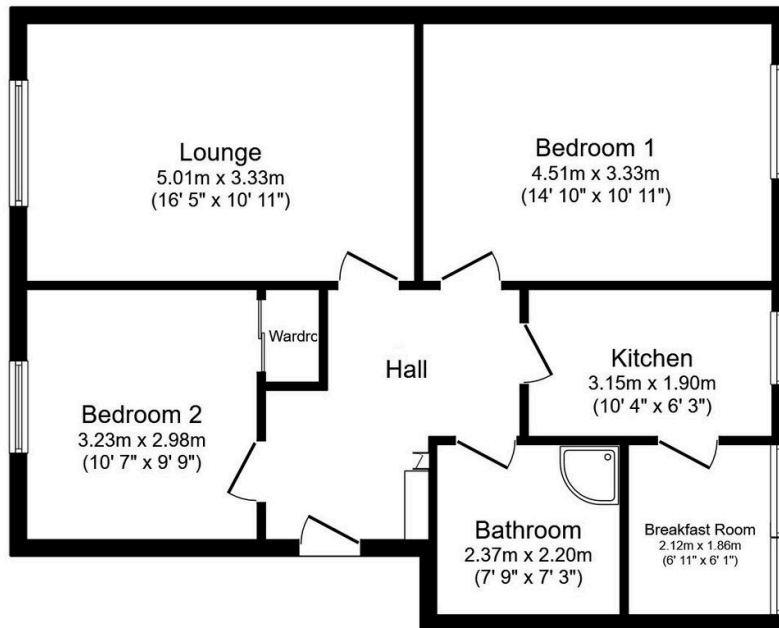

Floor Plan

Floor area 68.3 sq.m. (735 sq.ft.)

Total floor area: 68.3 sq.m. (735 sq.ft.)

This floor plan is for illustrative purposes only. It is not drawn to scale. Any measurements, floor areas (including any total floor area), openings and orientations are approximate. No details are guaranteed, they cannot be relied upon for any purpose and do not form any part of any agreement. No liability is taken for any error, omission or misstatement. A party must rely upon its own inspection(s). Powered by www.Propertybox.io