

## Alcester Road, Hollywood, Birmingham, B47 5NB

Offers Over £725,000

 5  5  3



**Beautifully Extended Five-Bedroom Family Residence with Modern Interiors and a Large Garden in Prime Hollywood Location**

### Key Features

- Beautifully extended five-bedroom property
- Impressive open-plan living and dining area
- Large rear garden offering excellent outdoor space
- Situated in a highly desirable Hollywood location
- Easy access to Birmingham, Solihull, M42 and Wythall Train Station
- Modern, stylish interiors throughout
- Spacious and flexible layout ideal for family living
- Well-presented bedrooms suitable for families, guests, or home working
- Close to well-regarded schools, shops, and local amenities

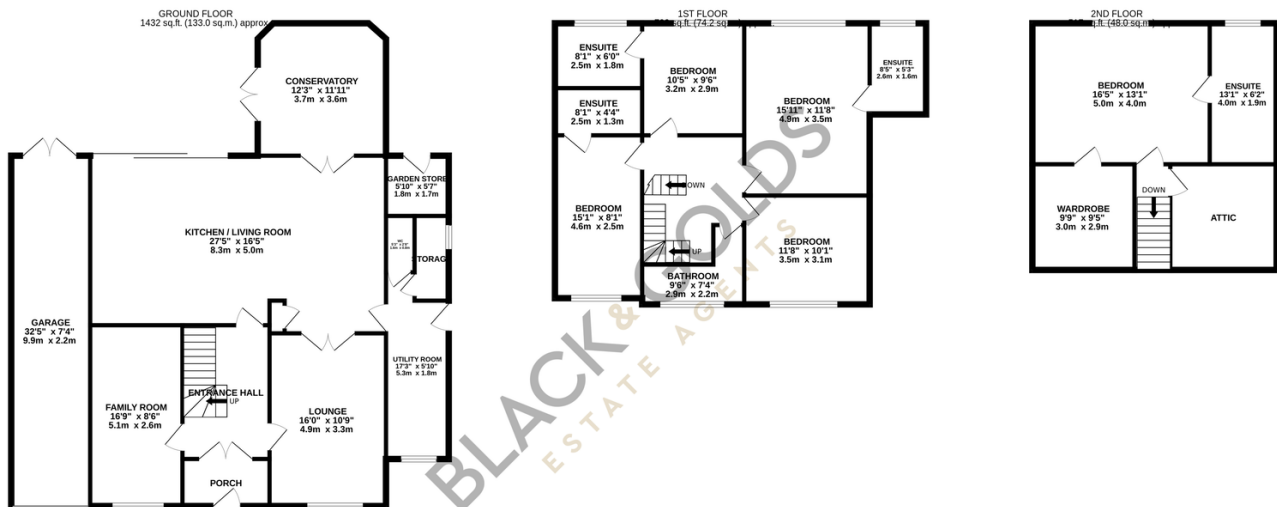

TOTAL FLOOR AREA: 2748 sq.ft. (255.3 sq.m.) approx.

Whilst every attempt has been made to ensure the accuracy of the floorplan contained here, measurements of doors, windows, rooms and any other items are approximate and no responsibility is taken for any error, omission or mis-statement. This plan is for illustrative purposes only and should be used as such by any prospective purchaser. The services, systems and appliances shown have not been tested and no guarantee as to their operability or efficiency can be given.

Made with Metropix ©2025