



12 Holme Close, Oakington, Cambridge, CB24 3AP

welcome to Holme Close, Oakington

A smart two-bedroom bungalow with a refitted bathroom and shower room tucked away in this private cul de sac with an enclosed rear private garden and parking alongside offering easy access into Cambridge and onto the guided busway.



GROUND FLOOR
507 sq.ft. (47.1 sq.m.) approx.

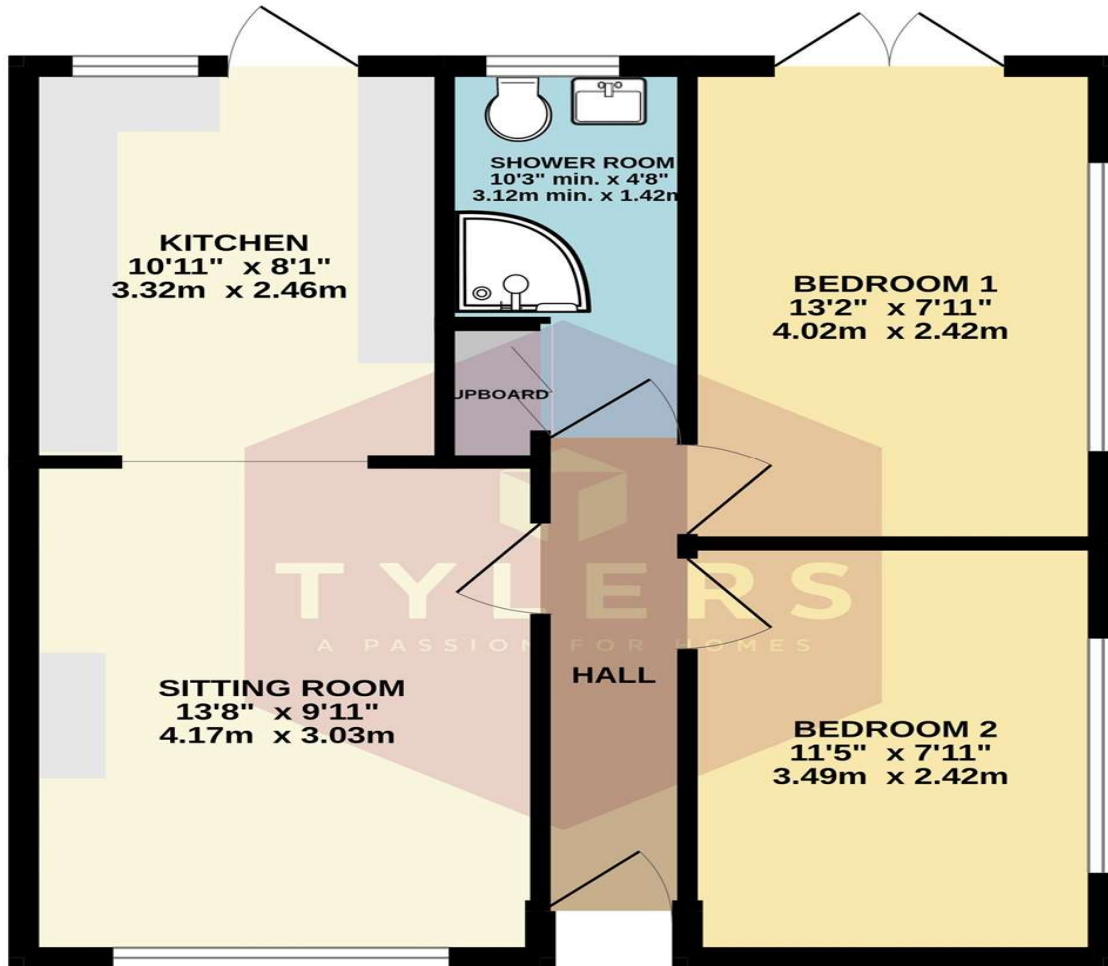

Open Shallow Storm Porch

Entrance Hall

Living Room

Kitchen

Bedroom One

Bedroom Two

Shower Room

Outside

Agents Notes

welcome to Holme Close, Oakington

- Two Bedroom Bungalow
- End of Terrace
- Car-Port Parking
- Rear Garden
- Easy Access onto the Guided Busway

Tenure: Freehold EPC Rating: C
Council Tax Band: C

offers in the region of
£310,000



Please note the marker reflects the
postcode not the actual property

view this property online [sequencehome.co.uk/Property/HIS100150](https://www.sequencehome.co.uk/Property/HIS100150)



Property Ref:
HIS100150 - 0004

1. MONEY LAUNDERING REGULATIONS Intending purchasers will be asked to produce identification documentation at a later stage and we would ask for your co-operation in order that there is no delay in agreeing the sale. 2. These particulars do not constitute part or all of an offer or contract. 3. The measurements indicated are supplied for guidance only and as such must be considered incorrect. Potential buyers are advised to recheck measurements before committing to any expense. 4. We have not tested any apparatus, equipment, fixtures or services and it is in the buyers interest to check the working condition of any appliances. 5. Where an EPC, or a Home Report (Scotland only) is held for this property, it is available for inspection at the branch by appointment. If you require a printed version of a Home Report, you will need to pay a reasonable production charge reflecting printing and other costs. 6. We are not able to offer an opinion either written or verbal on the content of these reports and this must be obtained from your legal representative. 7. Whilst we take care in preparing these reports, a buyer should ensure that his/her legal representative confirms as soon as possible all matters relating to title including the extent and boundaries of the property and other important matters before exchange of contracts.



01223 214400



histon@tylers.net



19 High Street, CAMBRIDGE, Cambridgeshire,
CB24 9JD



[sequencehome.co.uk](https://www.sequencehome.co.uk)