



## CHESTERTON ROAD, W10

£650,000

Own Front Door  
Two Double Bedrooms  
Separate Kitchen  
Private Garden  
Victorian Conversion  
Share Of Freehold

@marshandparsons  
marshandparsons.co.uk

MARSH &  
PARSONS



# ABOUT THE PROPERTY

A two double bedroom garden flat in a Victorian Conversion, presented in good condition throughout. An ideal purchase for anyone that loves summer entertaining and being close to amenities.

Wonderfully located on a quiet residential street just off Ladbroke Grove and close to the café's, bars, boutiques and restaurants of Portobello Road.



# STEP INSIDE CHESTERTON ROAD

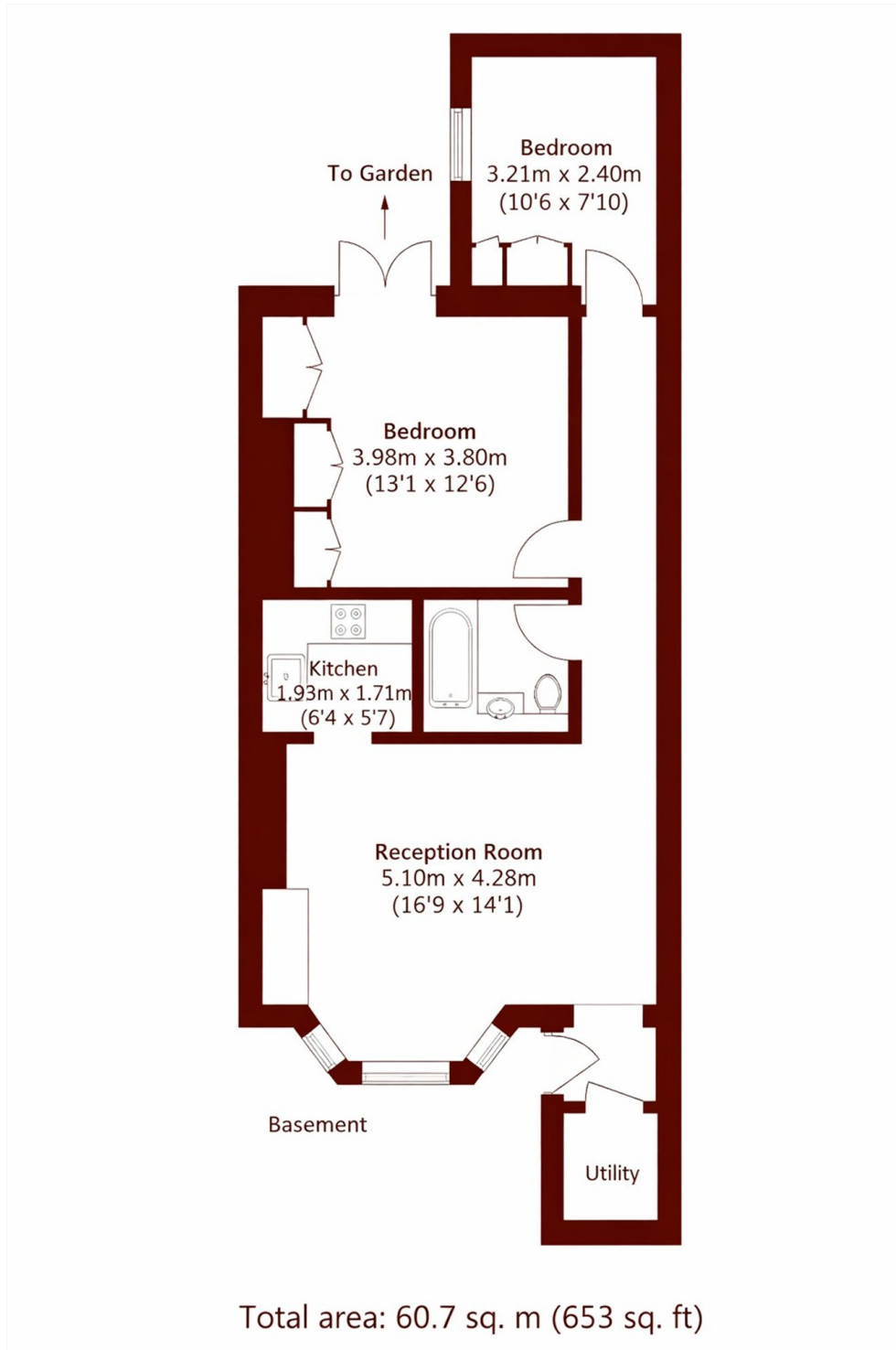

North Kensington  
020 7313 8350

Energy Rating: C We aim to make our particulars both accurate and reliable. However, they are not guaranteed; nor do they form part of an offer or contract. If you require clarification on any points then please contact us, especially if you're traveling some distance to view. Please note that appliances and heating systems have not been tested and therefore no warranties can be given as to their good working order

MARSH &  
PARSONS