



41 Brickworks Close, Bristol
£350,000



41 Brickworks Close

Bristol, Bristol

Council Tax band: C

Tenure: Freehold

EPC Energy Efficiency Rating: C

EPC Environmental Impact Rating: B

- Three bedroom modern semi-detached house
- Private garden
- Garage / carport and parking
- Modern kitchen
- French doors (garden access)
- Contemporary bathrooms
- En-suite main bedroom
- Spacious open plan living area
- Decked and patio seating areas
- Built-in storage solutions



GROUND FLOOR
404 sq.ft. (37.6 sq.m.) approx.

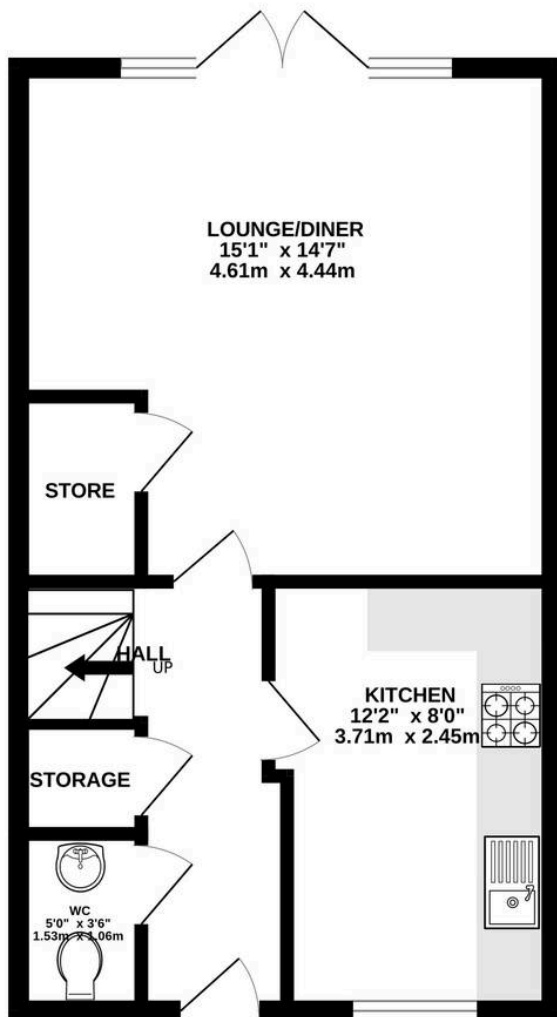

FIRST FLOOR
404 sq.ft. (37.6 sq.m.) approx.

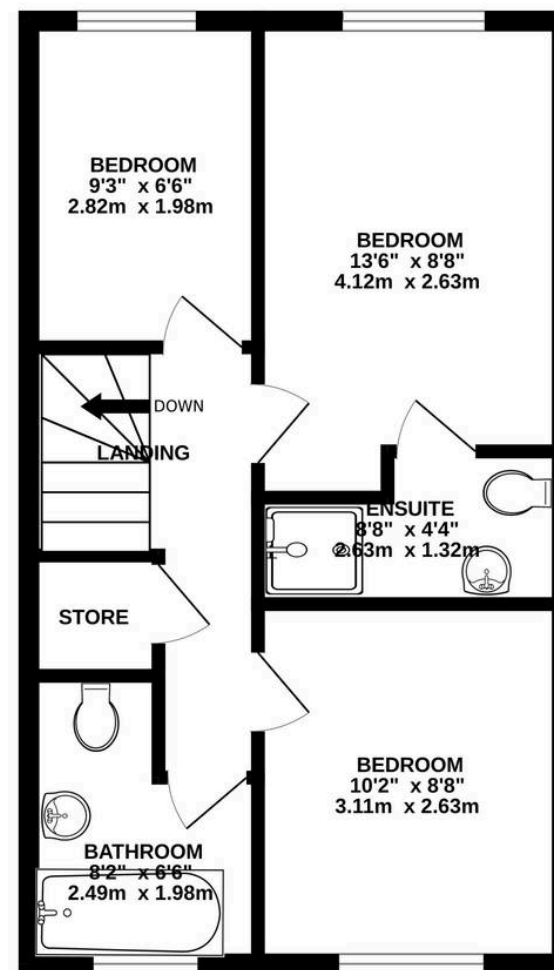

TOTAL FLOOR AREA : 809 sq.ft. (75.1 sq.m.) approx.

Whilst every attempt has been made to ensure the accuracy of the floorplan contained here, measurements of doors, windows, rooms and any other items are approximate and no responsibility is taken for any error, omission or mis-statement. This plan is for illustrative purposes only and should be used as such by any prospective purchaser. The services, systems and appliances shown have not been tested and no guarantee as to their operability or efficiency can be given.
Made with Metropix ©2025