



13 Thatcham House, Clivemont Road, Maidenhead SL6 7BW

welcome to

13 Thatcham House, Clivemont Road, Maidenhead

This beautiful two bedroom, two bathroom apartment is set within a popular modern development offering superb convenience and excellent access to the town centre, with its wide range of shops, bars, and restaurants. The property is only a 5 minutes walk to Furze Platt station, which takes you to Maidenhead station in 3 minutes; 10 minutes walk to the town centre; 20 minutes walk/5 minutes drive to Maidenhead station for both the Elizabeth line and trains going directly to London.





Clivemont Road, Maidenhead, SL6

Approximate Area = 828 sq ft / 76.9 sq m

For identification only - Not to scale

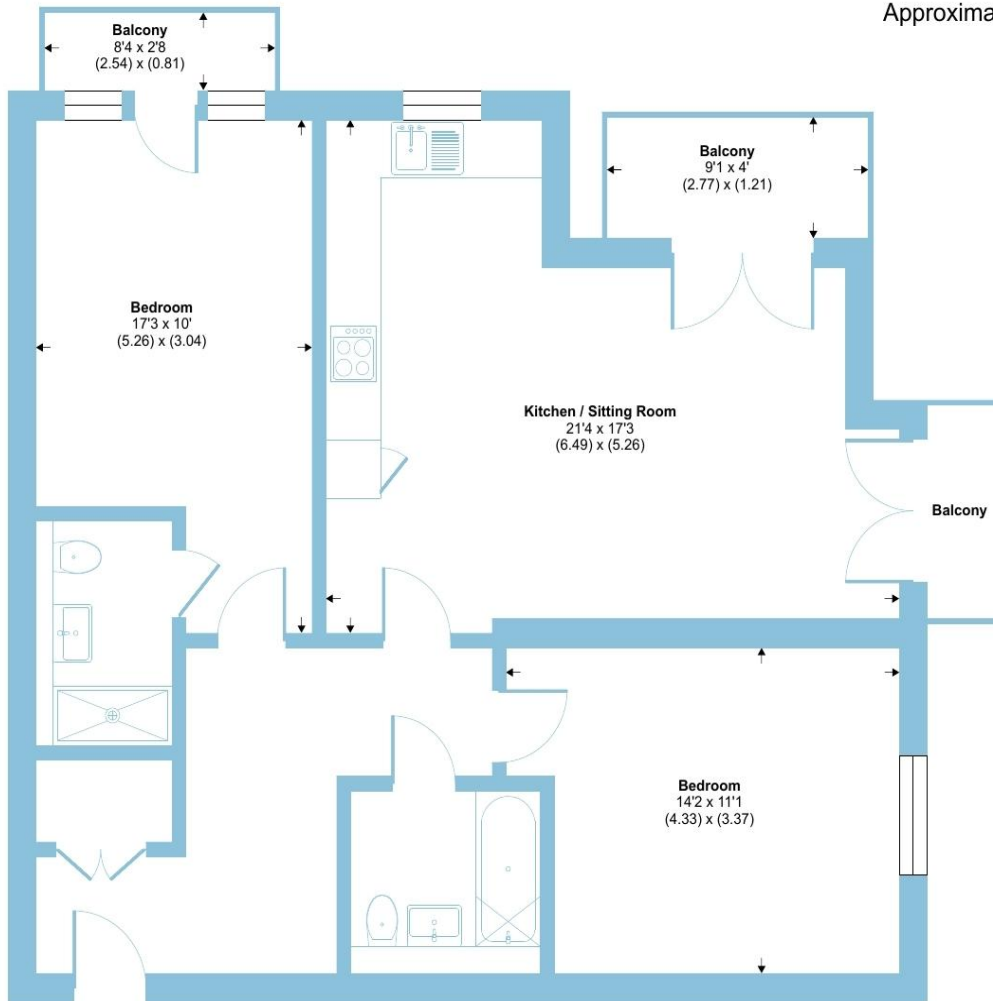

SECOND FLOOR

The apartment features a bright and spacious open-plan living area, seamlessly connecting to a contemporary kitchen complete with modern units and integrated appliances. Doors open onto the private balconies, one east-facing which allows to see a full sunrise and one north-west facing which offers a beautiful sunset view, especially in the summer time, perfect for enjoying a morning coffee or relaxing in the evening. The main double bedroom benefits from fitted wardrobes, a private balcony and an en-suite shower room. There is a second double bedroom and a modern bathroom.

Further advantages include a secure underground allocated parking space, visitor parking, lift to upper floors, low service charge and a long lease, ensuring both comfort and peace of mind. A stylish, low-maintenance home in a highly convenient location — early viewing is recommended.

welcome to

13 Thatcham House, Clivemont Road

- CLOSE TO TOWN CENTRE & STATION
- LONG LEASE
- TWO DOUBLE BEDROOMS
- THREE BALCONIES
- MODERN BATHROOM & EN-SUITE SHOWER ROOM
- SECURE UNDERGROUND ALLOCATED PARKING SPACE
- LOW SERVICE CHARGE

Tenure: Leasehold EPC Rating: B

Council Tax Band: D Service Charge: 1241.46

Ground Rent: None

This is a Leasehold property with details as follows; Term of Lease 999 years from 01 Aug 2021. Should you require further information please contact the branch. Please Note additional fees could be incurred for items such as Leasehold packs.

£400,000



Please note the marker reflects the postcode not the actual property

check out more properties at rogerplatt.co.uk



Property Ref:
MHD123617 - 0003

1. MONEY LAUNDERING REGULATIONS Intending purchasers will be asked to produce identification documentation at a later stage and we would ask for your co-operation in order that there is no delay in agreeing the sale. 2. These particulars do not constitute part or all of an offer or contract. 3. The measurements indicated are supplied for guidance only and as such must be considered incorrect. Potential buyers are advised to recheck measurements before committing to any expense. 4. We have not tested any apparatus, equipment, fixtures or services and it is in the buyers interest to check the working condition of any appliances. 5. Where an EPC, or a Home Report (Scotland only) is held for this property, it is available for inspection at the branch by appointment. If you require a printed version of a Home Report, you will need to pay a reasonable production charge reflecting printing and other costs. 6. We are not able to offer an opinion either written or verbal on the content of these reports and this must be obtained from your legal representative. 7. Whilst we take care in preparing these reports, a buyer should ensure that his/her legal representative confirms as soon as possible all matters relating to title including the extent and boundaries of the property and other important matters before exchange of contracts.

Roger Platt is a trading name of Sequence (UK) Limited which is registered in England and Wales under company number 4268443, Registered Office is Cumbria House, 16-20 Hockliffe Street, Leighton Buzzard, Bedfordshire, LU7 1GN. VAT Registration Number is 500 2481 05.

roger platt



01628 773333



Maidenhead@rogerplatt.co.uk



25-29 Queen Street, MAIDENHEAD, Berkshire,
SL6 1NB



rogerplatt.co.uk