

LEASEHOLD



Flat (EPC Rating:)

FLAT 2, BETTY ANNE COURT, 89 BATH STREET NORTH, SOUTHPORT, PR9

Offers Over

£50,000

FEATURES

- Ground Floor 50% Ownership Apartment
- Town Centre Location
- Two Double Bedrooms
- Permit Off Street Parking Available
- Quiet Well Presented Purpose Built Block
- Spacious Living and Dining Area
- Walking Distance of Local Transport Links



aj anthony james
estate agents

2 Bedroom Flat located in Southport

Full Description

Beautifully presented GROUND FLOOR apartment being sold with NO CHAIN. Ideally positioned just minutes from local shops, bars, restaurants found at Lord Street. This 50% shared ownership briefly comprises of;

Entrance Hallway - 6m x 2m (19'8" x 6'6")

Private entrance door, laminate flooring, radiator, doors to storage cupboard, both bedrooms, bathroom and living room.

Storage Cupboard - 1.82m x 1.01m (5'11" x 3'3")

Ample size storage room.

Lounge/Dining Room - 5.37m x 3.06m (17'7" x 10'0")

Spacious and bright living room with laminate flooring, radiator, window to front and door leading to kitchen.

Kitchen - 3.38m x 1.95m (11'1" x 6'4")

Range of base and wall units, fitted electric oven with four ring gas hob and extractor fan above. Space for washing machine and fridge/freezer. Window to front, radiator to side, part tiled walls and vinyl flooring.

Bedroom 1 - 3.96m x 3m (12'11" x 9'10")

Great size main bedroom with fitted wardrobes, window to rear, radiator and fitted carpet.

- 3.96m x 1.83m (12'11" x 6'0")

Also positioned to the rear, double bedroom with window to rear, radiator to side, storage and fitted carpet.

Bathroom - 1.93m x 1.95m (6'3" x 6'4")

Three piece suite comprising of; bath with shower over, wc and hand wash basin. Window to side, radiator and vinyl flooring.

Additional Information

There is gated parking at the rear, spaces must be requested via the management company and include an additional cost, if available. Communal gardens. Managed by Prima Group. Built 2005 Lease: 99 years from 1 July 2005. Service Charge: £109.84pcm Monthly Rent Charge: £392.29



SALES | CHARLOTTE HOUSE, GROUND FLOOR, 35-37 HOGHTON STREET, SOUTHPORT, MERSEYSIDE, PR9 0NS

Call us on

01704550048

sales@ajestateagents.co.uk

<https://www.ajestateagents.co.uk/properties/sale>

Council Tax Band

B

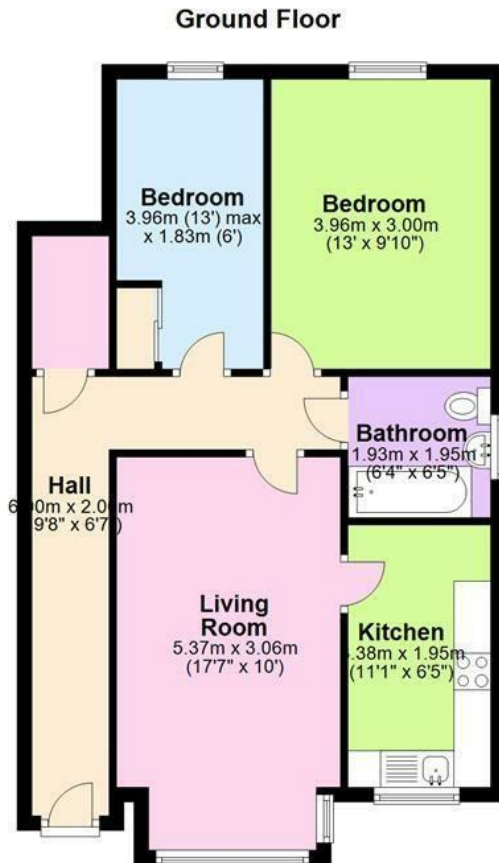

"Whilst every attempt has been made to ensure the accuracy of the floor plan contained here, measurements of doors, windows, rooms and any other item are approximate and no responsibility is taken for any error, omission, or misstatement. This plan is for illustrative purposes only and should only be used as such by any prospective purchaser.

Plan produced using PlanUp.

Energy Efficiency Rating		Current	Potential
Very energy efficient - lower running costs			
(92 plus) A			
(81-91) B			
(69-80) C			
(55-68) D			
(39-54) E			
(21-38) F			
(1-20) G			
Not energy efficient - higher running costs			
England & Wales		EU Directive 2002/91/EC	

Agents Note: Whilst every care has been taken to prepare these particulars, they are for guidance purposes only. All measurements are approximate and are for general guidance purposes only and whilst every care has been taken to ensure their accuracy, they should not be relied upon and potential buyers are advised to recheck the measurements.

