



## 20 Well Lane, Stock - CM4 9LU

£725,000 Freehold

Council Tax band: F ~ EPC Energy Efficiency Rating: E

This charming three-bedroom extended end of terrace cottage is nestled in a peaceful corner position within the sought-after 'Rumbles Green' off Well Lane, in the picturesque village of Stock. Set on a generous plot of approximately 0.2 acres, the property offers light-filled and versatile accommodation, thoughtfully designed to suit family living.



**tyler** estates

01277 626181

[www.tylerestates.co.uk](http://www.tylerestates.co.uk)



**Porch Area**

**Entrance Hall**

**Lounge**

23' 8" x 12' 2" (7.22m x 3.70m)

**Kitchen / Breakfast Room**

15' 0" x 10' 11" (4.58m x 3.32m)

**Dining Room**

15' 1" x 9' 0" (4.60m x 2.74m)

**Sitting Room/ Bedroom**

11' 5" x 10' 8" (3.47m x 3.26m)

**Cloakroom**

**Landing**

**Bedroom One**

11' 7" x 11' 4" (3.52m x 3.46m)

**En-suite**

**Bedroom Two**

10' 11" x 10' 8" (3.32m x 3.26m)

**Bathroom**

7' 6" x 6' 10" (2.28m x 2.09m)

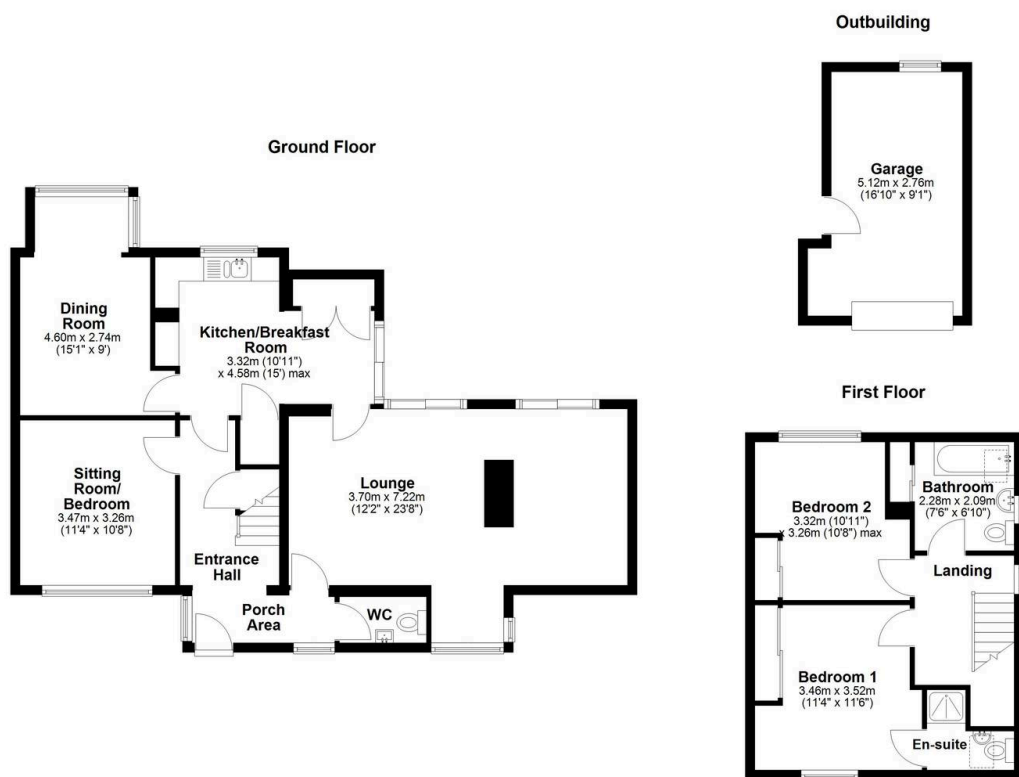

Total area: approx. 132.8 sq. metres (1429.8 sq. feet)