



Cumberland Crescent, W14

£1,295,000

A rare opportunity to purchase a three bedroom freehold house currently used as an office for St James School. Due to planning rules, the property must be sold to a residential buyer, but it could easily become a superb family home in a great location.

Cumberland Crescent is situated just off Earsby Street a popular location with buyers wanting easy access to Kensington High Street and transport links. Kensington Olympia is just moments away with local shops and popular restaurants close by.

Features

- Private Driveway
- Garden
- Three Bedrooms
- Rare To Market
- Freehold
- Three Receptions

Cumberland Crescent, London, W14

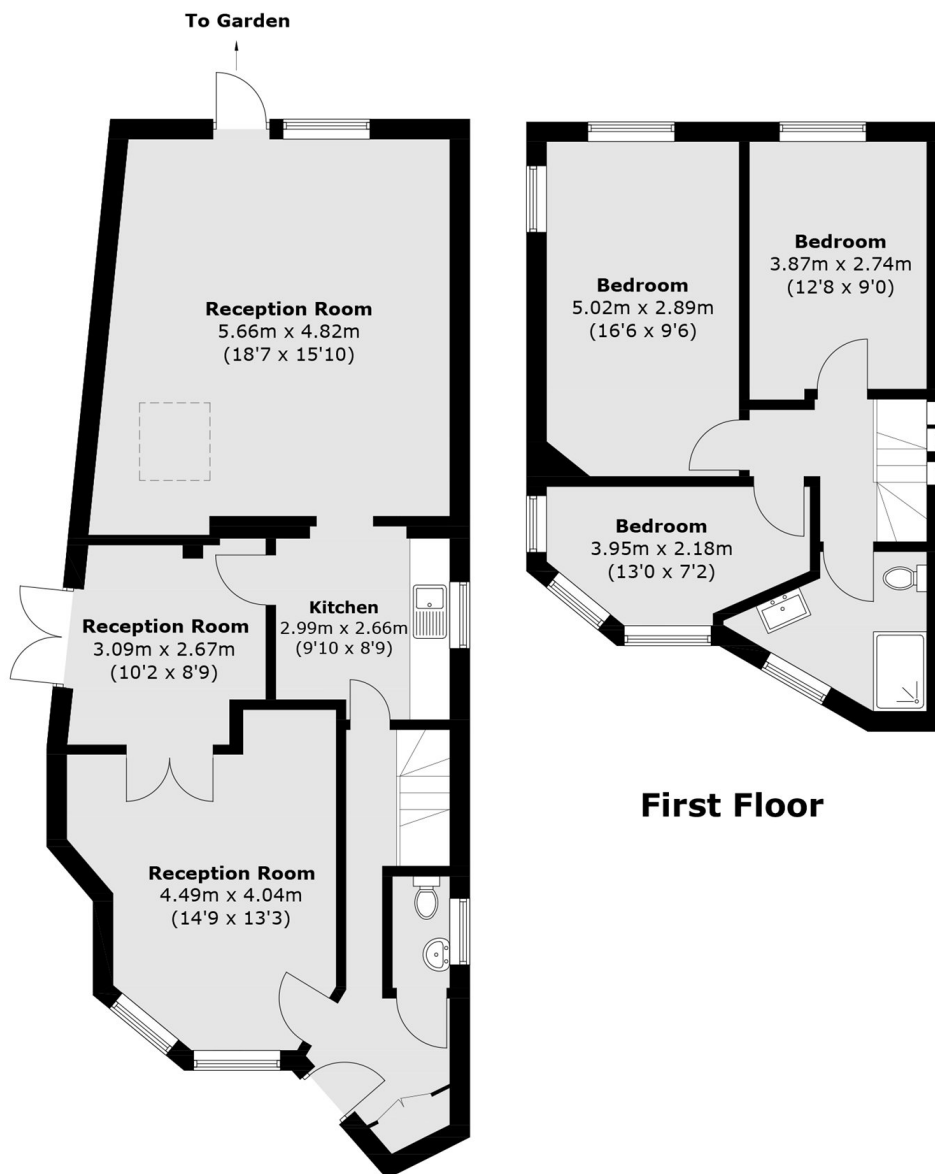

Ground Floor

First Floor

Total area (approx.): 117.7 sq. m (1266.8 sq. ft)