



## Cambridge Heath Road, E1 £250,000

One bedroom apartment that has been recently refurbished throughout in a popular Bethnal Green location. The apartment has a spacious living room with ample space to dine and a separate fully integrated kitchen. The bedroom is a good size double and has fitted storage and the apartment has a modernised shower room. Access to the apartment is via its own private entrance. The apartment has a generous amount of natural light.

Sovereign House is located directly off of Cambridge Heath Road and within a short walk of either Whitechapel (District and Hammersmith & City lines) Tube Station or Bethnal Green (Central Line) Tube Station and having multiple bus routes in to the City, West End and beyond.

### Features

- One bedroom apartment
- Private entrance
- Recently refurbished
- Generous natural light
- Sought after location

# Cambridge Heath Road, London, E1

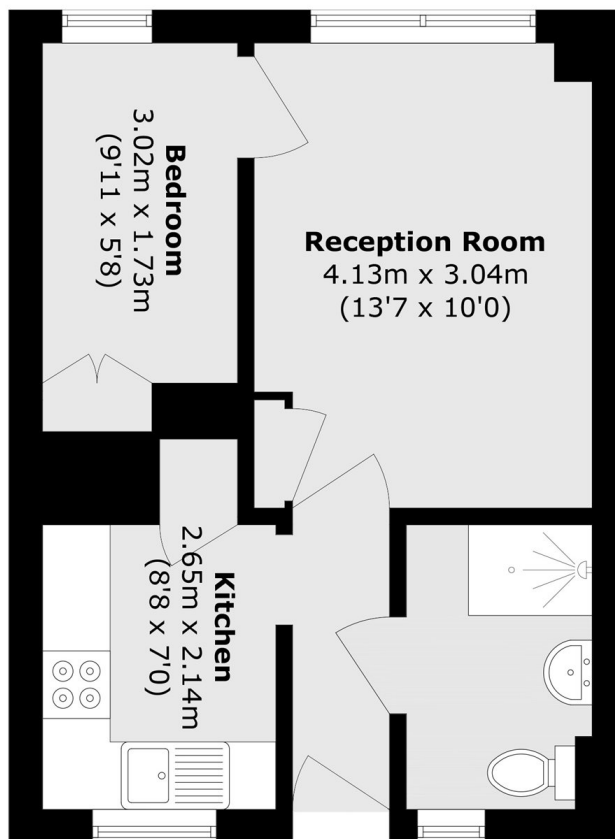

Total area (approx.): 33.2 sq. m (357.3 sq. ft)