



## Grandfield Court, London, W4 3EP

A delightful and nicely presented one-bedroomed apartment situated in this very popular residential road just moments from the open spaces of Chiswick house grounds, local shopping is close at hand whilst the more extensive boutique shopping and restaurant facilities of Chiswick High Road are within walking distance. The accommodation provides: spacious open plan living area with a modern galley style kitchen, nice size double bedroom, luxury shower room, gas-fired central heating, the apartment is located in communal grounds with surrounding gardens and undesignated parking accessed via a security barrier. Local transport links include Chiswick Park Tube station, Chiswick mainline station (to Waterloo) numerous local bus routes with easy access via A4/M4 Central London Heathrow & The West. Hounslow Council Band C. EPC: C. Offered unfurnished and available 1st June 2026

- Nice Chiswick "Grove Park" location
- Good for transport links
- Well maintained purpose built development
- Main open plan living room
- Galley style modern kitchen
- Double bedroom
- Luxury shower room
- Communal gardens
- Private parking
- Available 1st June - Unfurnished

**£1,750 Per Month**

# Grandfield Court, Park Road, W4

Approximate gross internal area

35.02 sq m / 377 sq ft

Key :  
CH - Ceiling Height

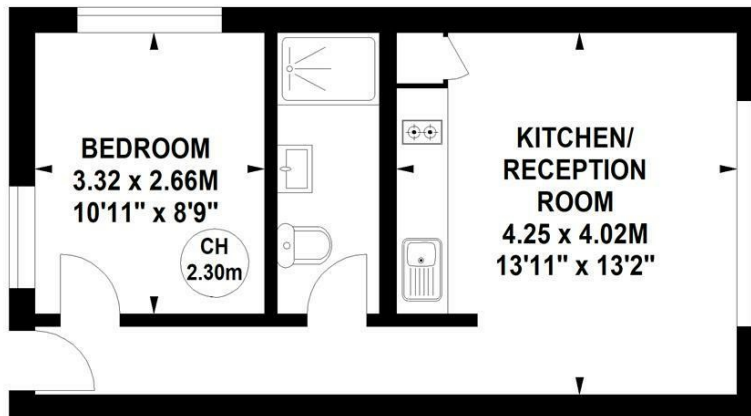

## Ground Floor

Not to scale, for guidance only and must not be relied upon as a statement of fact.  
All measurements and areas are approximate only

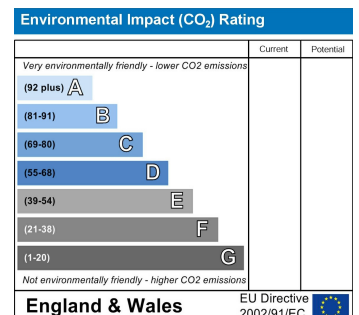
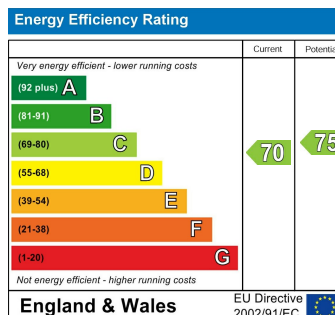

5-7 Turnham Green Terrace, Chiswick, London, W4 1RG

Tel 020 8747 8800

E-mail [lettings@whitmanandco.com](mailto:lettings@whitmanandco.com)

Website [www.whitmanandco.com](http://www.whitmanandco.com)