



MALLINSON  
& CO

INNOVATIVE PROPERTY EXPERTS

# Park Farm, Haveroid Lane, Crigglistone, Wakefield, WF4 3HD

Guide Price £600,000

🛏 4 🚿 3 🚗 3



- DETACHED FAMILY HOME
- 4-5 BEDROOMS
- CONTEMPORARY KITCHEN & UTILITY
- VERSATILE ACCOMMODATION
- 2 EN SUITES
- BEAUTIFULLY LANDSCAPED GARDEN
- GARAGE & LARGE DRIVEWAY
- HIGH QUALITY FIXTURES & FITTINGS THROUGHOUT
- LOCAL AMENITIES, SCHOOLING & TRANSPORT LINKS
- VIEWING IS HIGHLY RECOMMENDED



A BEAUTIFULLY APPOINTED FAMILY HOME OFFERING VERSATILE ACCOMMODATION, MODERN FINISHES AND GENEROUS OUTDOOR SPACE. OCCUPYING A DESIRABLE POSITION WITHIN THE SOUGHT-AFTER VILLAGE OF CRIGGLESTONE, THIS IMPRESSIVE FOUR/FIVE-BEDROOM DETACHED RESIDENCE OFFERS EXCEPTIONALLY WELL-PRESENTED ACCOMMODATION IDEALLY SUITED TO MODERN FAMILY LIVING. BOASTING TWO EN-SUITE BEDROOMS, A CONTEMPORARY BREAKFAST KITCHEN, VERSATILE GROUND FLOOR OFFICE/BEDROOM, SPACIOUS LIVING ACCOMMODATION AND A SUBSTANTIAL DRIVEWAY WITH GARAGE, THE PROPERTY COMBINES PRACTICALITY WITH STYLE. ENJOYING A PRIVATE ENCLOSED GARDEN AND CONVENIENT ACCESS TO LOCAL AMENITIES, COMMUTER LINKS AND HIGHLY REGARDED SCHOOLING, THIS OUTSTANDING HOME MUST BE VIEWED TO BE FULLY APPRECIATED.

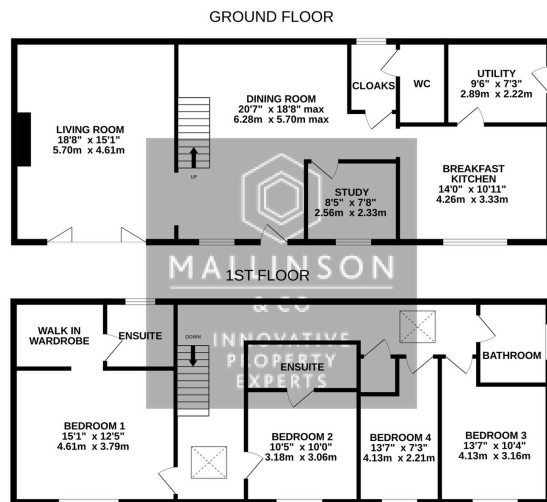

TOTAL FLOOR AREA: 1856 sq ft (172.4 sq m) approx.  
 Whilst every effort has been made to ensure the accuracy of the figures contained here, measurements of rooms, windows, doors and any other details are approximate and no responsibility is taken for any error, omission or misstatement. This plan is for illustrative purposes only and does not constitute an offer of any property. The actual floor plan may vary from the one shown here and no guarantee is given as to the accuracy or efficiency of the plan. Make all enquiries early.

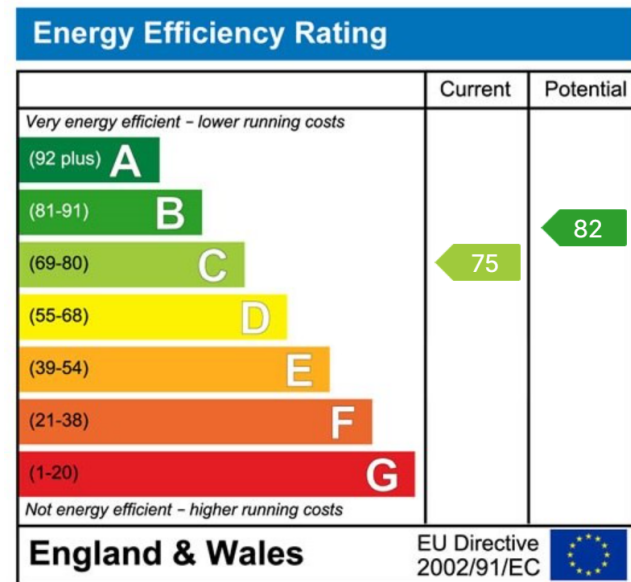

INNOVATIVE  
PROPERTY  
EXPERTS

**Mallinson & Co**

Office: 01226 414 150  
 Email: [ben@mallinsonandco.co.uk](mailto:ben@mallinsonandco.co.uk)  
 Web: [www.mallinsonandco.co.uk](http://www.mallinsonandco.co.uk)  
 Suite 6, Penistone 1, St. Mary's Street, Penistone, S36 6DT