



Cromwell Road, SW7

£550 Per week

A modern, neutrally decorated studio apartment located on the sixth floor of this popular residential building, which benefits from lift access and 24-hour portorage. The accommodation offers a spacious studio room with fitted wardrobes and a flat screen television, a separate fully fitted kitchen equipped with a washer-dryer and dishwasher, and a tiled bathroom featuring a shower over the bath.

The property is ideally located within a short walking distance of Gloucester Road Station and offers convenient access to a variety of local shops, including Waitrose and Sainsbury's.

Features

- Studio
- Sixth Floor
- Separate Kitchen
- 24-hour Porter
- Lift Access

Cromwell Road, London, SW7

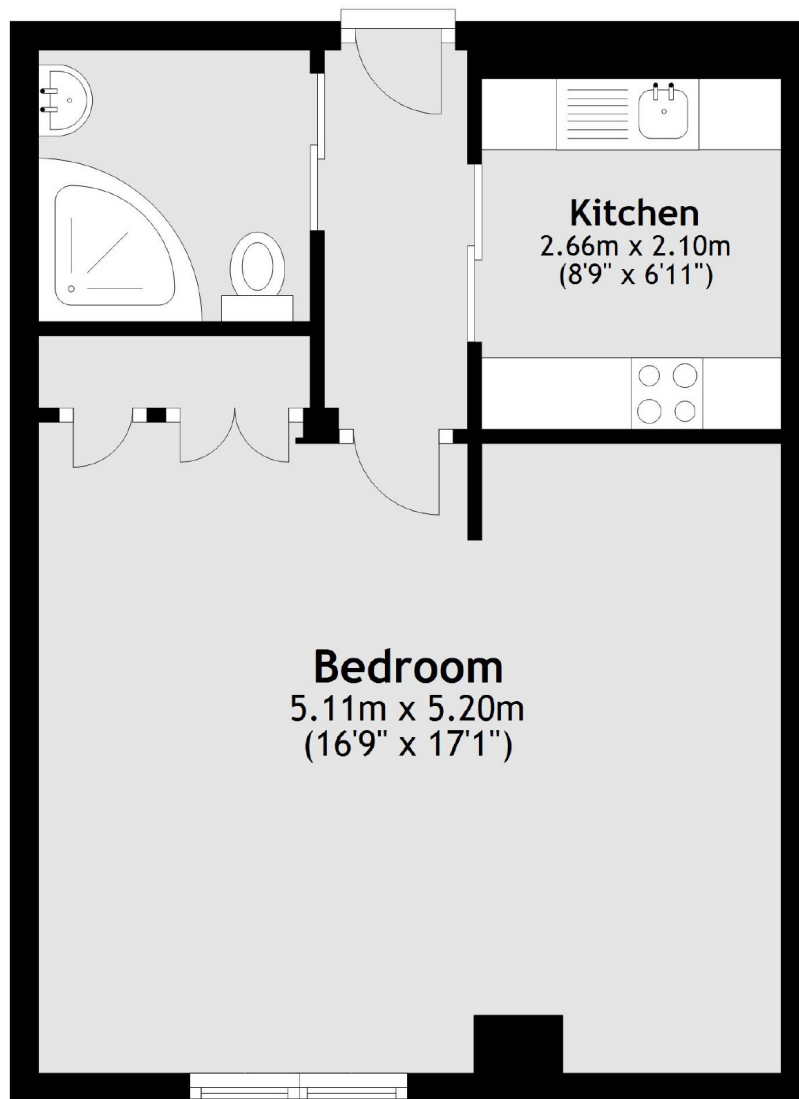

Total area: approx. 37.3 sq. metres (401.3 sq. feet)