

16 College Road, Whalley Range, Manchester, M16 8FF



JP&Brimelow
ESTATE AGENTS

Offers In The Region Of £375,000



VIDEO TOUR AVAILABLE A well-presented three-bedroom end-terrace home, situated on a highly sought-after, tree-lined residential road just off Withington Road. The property enjoys a convenient location within walking distance of excellent transport links, providing direct access to major motorway networks and cycle routes into the city centre. Alexandra Park is nearby, while a range of well-regarded primary and secondary schools are within easy reach. The accommodation briefly comprises an enclosed porch, an entrance hall, a spacious lounge/dining room overlooking the front lawned garden, and a fitted kitchen/breakfast room to the rear with direct access to the enclosed rear garden. To the first floor, there are three bedrooms, a modern three-piece family bathroom, and a separate WC. The property benefits from gas central heating via a Worcester combination boiler, well-maintained front lawned gardens, and a secure driveway to the rear leading to a useful detached garage. OFFERED WITH NO ONWARD CHAIN. Early internal viewing is highly recommended to fully appreciate the space on offer.





EPC Chart

Energy Efficiency Rating		Current	Potential
<i>Very energy efficient - lower running costs</i>			
(92 plus) A			
(81-91) B			86
(69-80) C		73	
(55-68) D			
(39-54) E			
(21-38) F			
(1-20) G			
<i>Not energy efficient - higher running costs</i>			
England & Wales		EU Directive 2002/91/EC 	



Tenure: **Freehold** Council Tax Band: **B**

Ground Floor

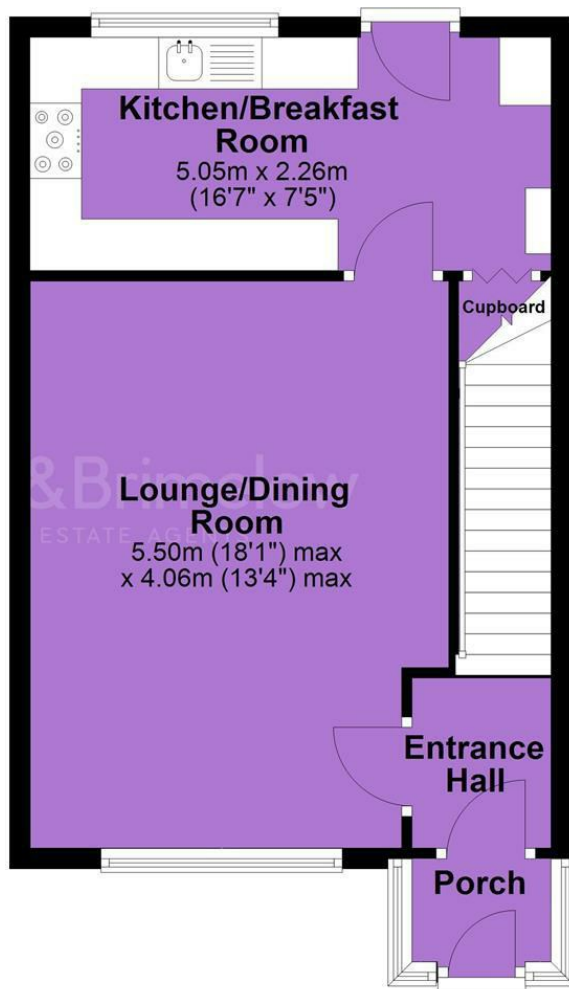

First Floor

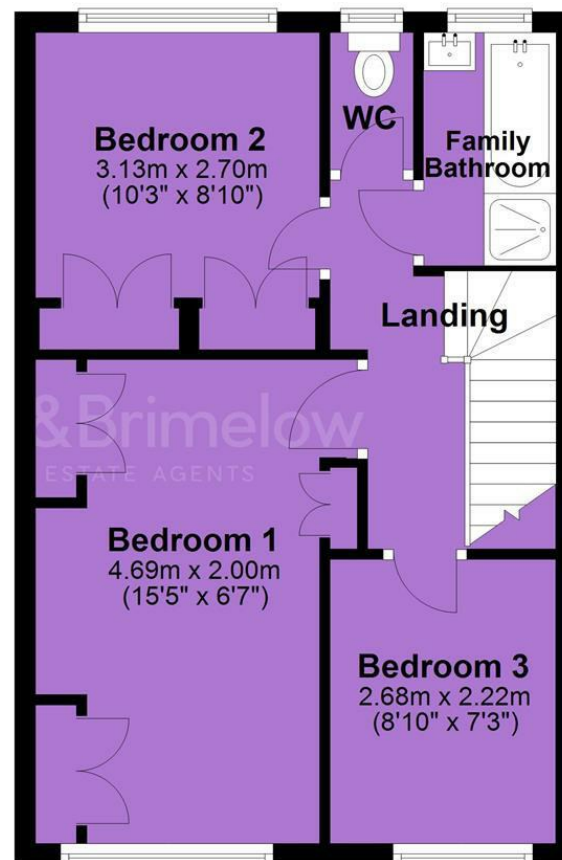

JP & Brimelow Estate Agents Ltd
430 Barlow Moor Road, Manchester, M21 8AD
Tel: 0161 8822233
E: sales@jpbrimelow.co.uk www.jpandbrimelow.co.uk

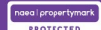

JP & Brimelow
ESTATE AGENTS

NOTICE: JP & Brimelow Estate Agents Ltd for themselves and for the vendors or lessors of this property whose agents they are give notice that:

- (i) the particulars are set out as a general outline only for the guidance of intending purchasers or lessees, and do not constitute, nor constitute part of, an offer or contract;
- (ii) all descriptions, dimensions, references to the condition and necessary permissions for use and occupation, and other details are given in good faith and are believed to be correct but any intending purchasers or tenants should not rely on them as statements or representations of fact but must satisfy themselves by inspection or otherwise as to the correctness of each of them;
- (iii) no person in the employment of JP & Brimelow Estate Agents Ltd has any authority to make or give any representation or warranty whatever in relation to this property.

jpandbrimelowstateagents

@jpandbrimelow