

First Floor

Approx. 33.2 sq. metres (357.2 sq. feet)

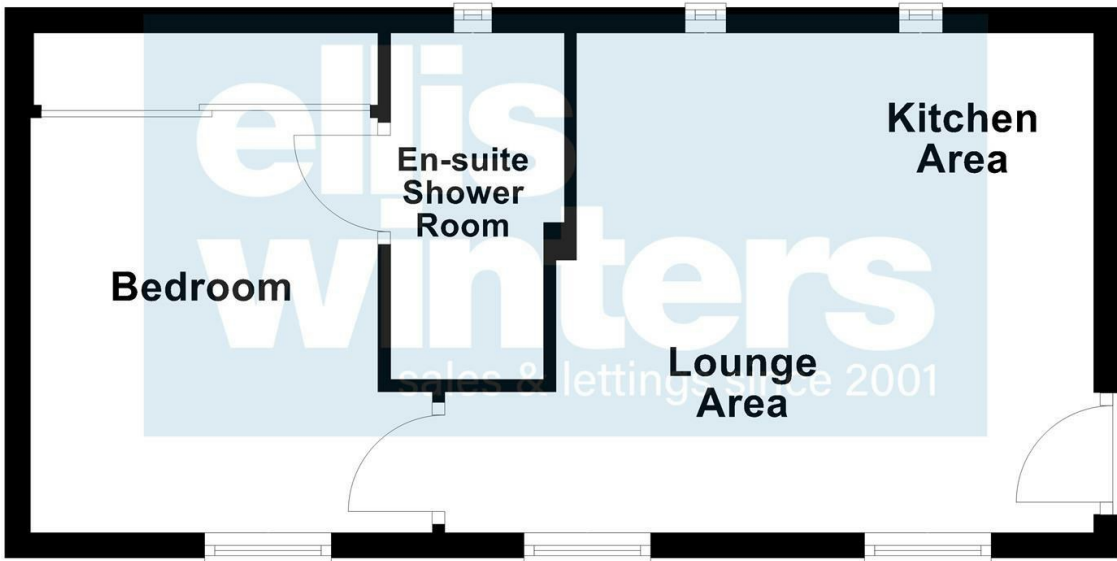

Total area: approx. 33.2 sq. metres (357.2 sq. feet)

GROUND FLOOR
Communal Entrance door to:

provided in good faith but should be independently verified.

Communal Entrance Hall
Stairs leading to first floor

FIRST FLOOR
Front entrance door to:

Lounge/Kitchen Area
5.13m (16'10") max x 3.95m (13')

Bedroom
3.50m (11'6") x 2.75m (9')

En-suite Shower Room

OUTSIDE
Off road parking space included.
Communal outdoor space for residence.

FURTHER INFORMATION
Deposit: £1,125
Council Tax Band: TBC
EPC rating: C
Minimum household income required to pass referencing: £29,250

Disclaimer
All property details, photographs, floorplans, and other marketing materials produced by Ellis Winters are for general guidance only and do not form part of any contract. While we strive for accuracy, measurements, descriptions, and other information are

Agents Note: Whilst every care has been taken to prepare these particulars, they are for guidance purposes only. All measurements are approximate and are for general guidance purposes only and whilst every care has been taken to ensure their accuracy, they should not be relied upon and potential buyers/tenants are advised to recheck the measurements

ellis winters
sales & lettings since 2001

OFFICE ADDRESS

14 Market Hill
St Ives
Cambridgeshire
PE27 5AL

OFFICE DETAILS

01480 388889
infostives@elliswinters.co.uk
www.elliswinters.co.uk

ellis winters
sales & lettings since 2001



£975 PER CALENDAR MONTH
MANCHESTER PLACE
HUNTINGDON, PE29 3DP

PROPERTY SUMMARY

A brand new first floor apartment, ideally located in the heart of Huntingdon town centre, close to all local amenities and within walking distance of Huntingdon train station. This modern property features an open-plan lounge and kitchen area, a double bedroom with a fitted wardrobe, and a en-suite shower room. Additional benefits include underfloor heating throughout, an off-road parking space, a communal outdoor area, and a secure communal entrance with a touchpad access system. Available immediately. Deposit: £1,125.

1



1



1

