



Ravenscroft Street, E2

£300,000

One bedroom apartment set within a popular development in the heart of Bethnal Green. The apartment has a spacious, bright living room with ample space to dine and a separate, modernised kitchen. The apartment has a good size double bedroom with plenty of in-built storage and a well maintained bathroom. The property also has far reaching City views.

Located close to Hoxton Rail station, this residence is a stroll away from the wonderful outdoors of Haggerston Park, Regent's Canal and London Fields. The nearby Columbia Road Flower Market is a popular London destination with a range of indie shops, artisan bakeries, cafes and restaurants. The development is an easy walk away for new office locations and amenities on Shoreditch High Street, Old Spitalfields Market and the City. The closest Underground station is Old Street.

Features

- One bedroom
- Modern interiors
- Popular development
- Sought after location
- City views
- Separate kitchen

Ravenscroft Street, London, E2

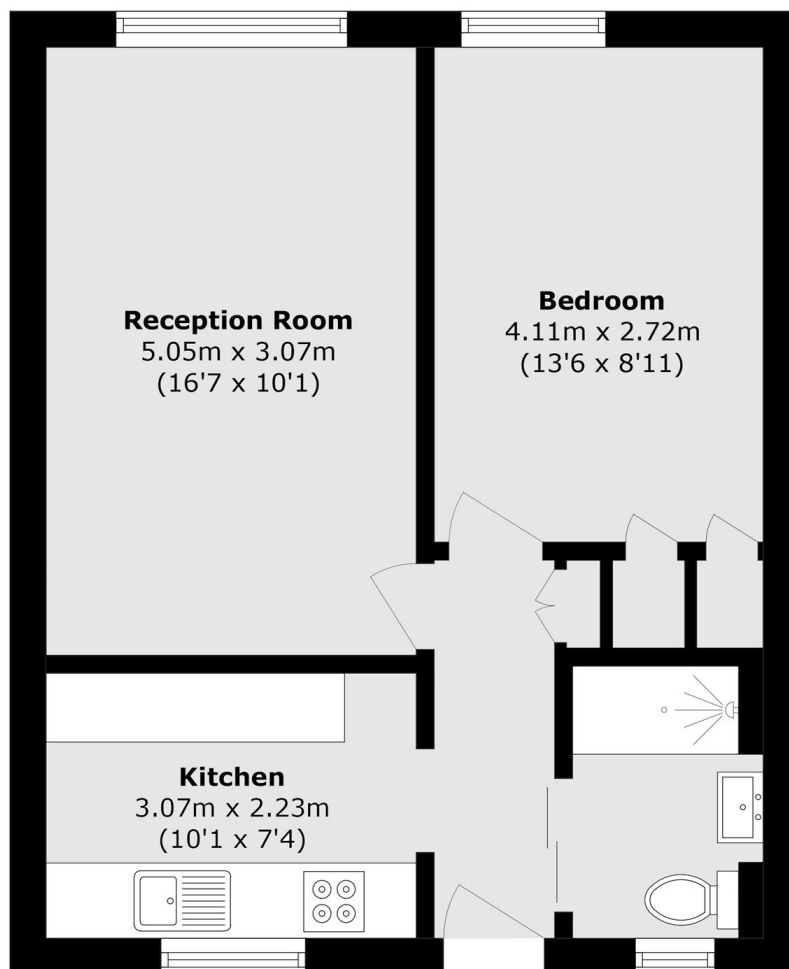

Total area (approx.): 44.0 sq. m (473.6 sq. ft)