

Frank Harris & Co.



Russell Court, WC1H

£2,050 pcm

This stylish apartment boasting a sleek modern bathroom, a charming balcony and a brand new kitchen equipped with state-of-the-art appliances, perfect for those seeking comfort and convenience. 24-hour concierge in the building, and heating and water bills included.

Situated near Russell Square, Holborn, and Kings Cross, Russell Court boasts excellent transport links, providing residents with easy access to the tube, buses, and trains. The Brunswick Centre is minutes away, offering plenty of shopping and dining options.

- Studio • Heating and Water Included • 24 Hour Porter •
- Private Balcony • Modern • Lift Access •

Frank Harris & Co.

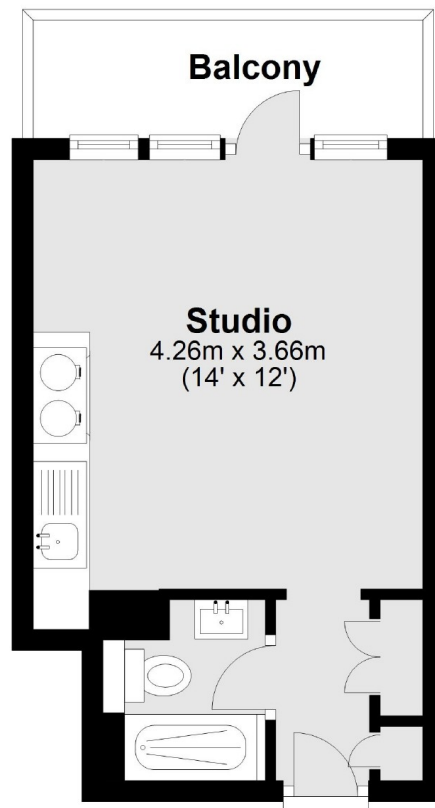

Main area: Approx. 20.4 sq. metres (219.6 sq. feet)

Plus balconies, approx. 4.4 sq. metres (47.7 sq. feet)

Frank Harris & Co. Bloomsbury and Kings Cross
81 Marchmont Street, London,
WC1N 1AL
020 7387 0077
bloomsburylettings@frankharris.co.uk

Energy Rating: C. We aim to make our particulars both accurate and reliable. However they are not guaranteed; nor do they form part of an offer or contract. If you require clarification on any points then please contact us, especially if you're traveling some distance to view. Please note that appliances and heating systems have not been tested and therefore no warranties can be given as to their good working order.

