



The Foldyard, Muxton, Telford

£194,950



Freehold | EPC rating: D

- ***NO UPWARD CHAIN***
- Open plan living room/kitchen
- Versatile mezzanine area

- Two bedroom barn conversion
- Private enclosed rear garden
- Close to local amenities

BELVOIR!

Property is personal

Email
salestelford@belvoir.co.uk

Phone
01952 248000

Description

The Foldyard - Muxton Two-Bedroom Semi-Detached Barn Conversion

Set within the charming setting of The Foldyard in the sought-after area of Muxton, this characterful two-bedroom semi-detached barn conversion blends rustic charm with modern living. With exposed beams, vaulted ceilings and unique architectural features throughout, the property offers a warm and inviting home in a convenient location close to local amenities, schools and excellent transport links.

The ground floor centres around a spacious open-plan kitchen and living area, creating a sociable and versatile living space. The kitchen is finished in a modern style and is well-equipped with a gas hob, electric oven and integrated fridge/freezer, offering both practicality and contemporary design. The living area has a wonderfully homely feel, enhanced by exposed beams, and provides direct access to the private enclosed rear garden, perfect for relaxing or entertaining.

Also on the ground floor is Bedroom Two, a generous and characterful room featuring high ceilings and a useful mezzanine area, ideal for additional storage or a creative space. The family bathroom is fitted with a corner bath and over-bath shower, providing both comfort and convenience.

Upstairs, the property features an impressive open mezzanine level which creates a unique and flexible space. Currently used as a double bedroom and home office, this area benefits from exposed beams and a distinctive porthole window, adding to the property's charm and character.

Externally, the home enjoys a private enclosed rear garden, offering a peaceful outdoor space, while its location provides easy access to local shops, schools and everyday amenities, along with excellent transport connections for commuting

Freehold / Council Tax Band B / EPC D

Floorplan

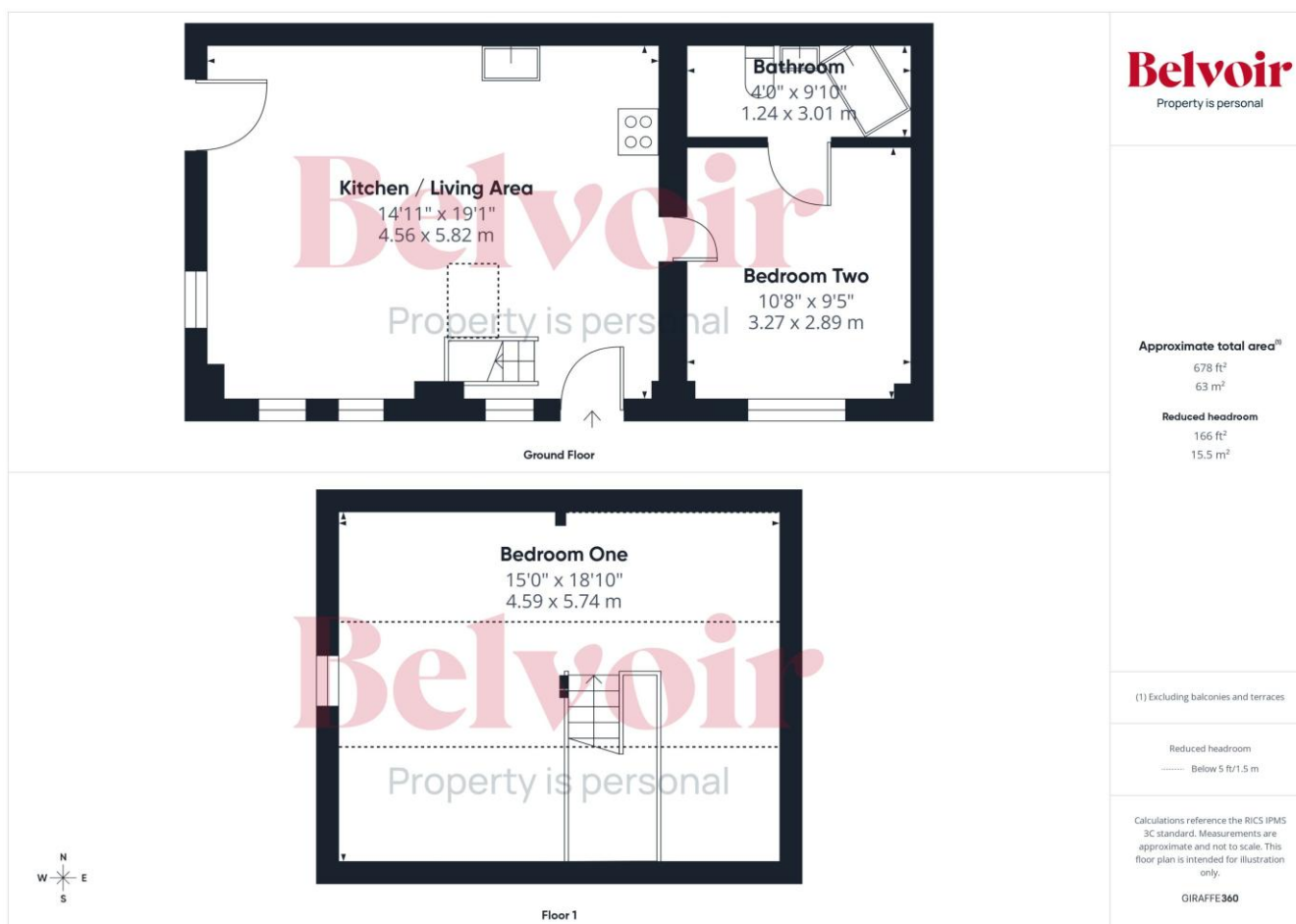

Rooms

Kitchen/Living room

5.82m x 4.56m (19'1" x 15'0")

Bedroom Two

3.27m x 2.89m (10'8" x 9'6")

Bathroom

3.01m x 1.24m (9'11" x 4'1")

Bedroom One

5.74m x 4.59m (18'10" x 15'1")

Photographs



