



7 Norfolk Drive, Farnworth

Offers in Region of £275,000

Miller Metcalfe
Every step of the way

7 Norfolk Drive

Farnworth, Bolton

This stunning, detached family home is being offered for sale with no onward chain. Internal viewing recommended to fully appreciate the standard of accommodation on offer.

Perfectly located for young families within easy walking distance of regular bus services and Moses Gate train station providing regular routes to Bolton centre and surrounding areas. The shops, supermarkets and cafes at Farnworth Town Centre are easily accessible, and there are a variety of schools within the vicinity. Farnworth Central Park is a short distance away as is Moses Gate Country Park providing green spaces suitable for everyday recreation, walking, and leisure activities.

The property features an entrance hall, two excellent size reception rooms and a beautiful fitted kitchen with integrated appliances. To the first floor are three well-proportioned bedrooms, with two spacious double bedrooms and a single, and a family bathroom with separate wc.

Externally, the property is sat on an impressive plot with a garden to the front and rear with a driveway and carport providing off street parking and leading to a detached single garage.

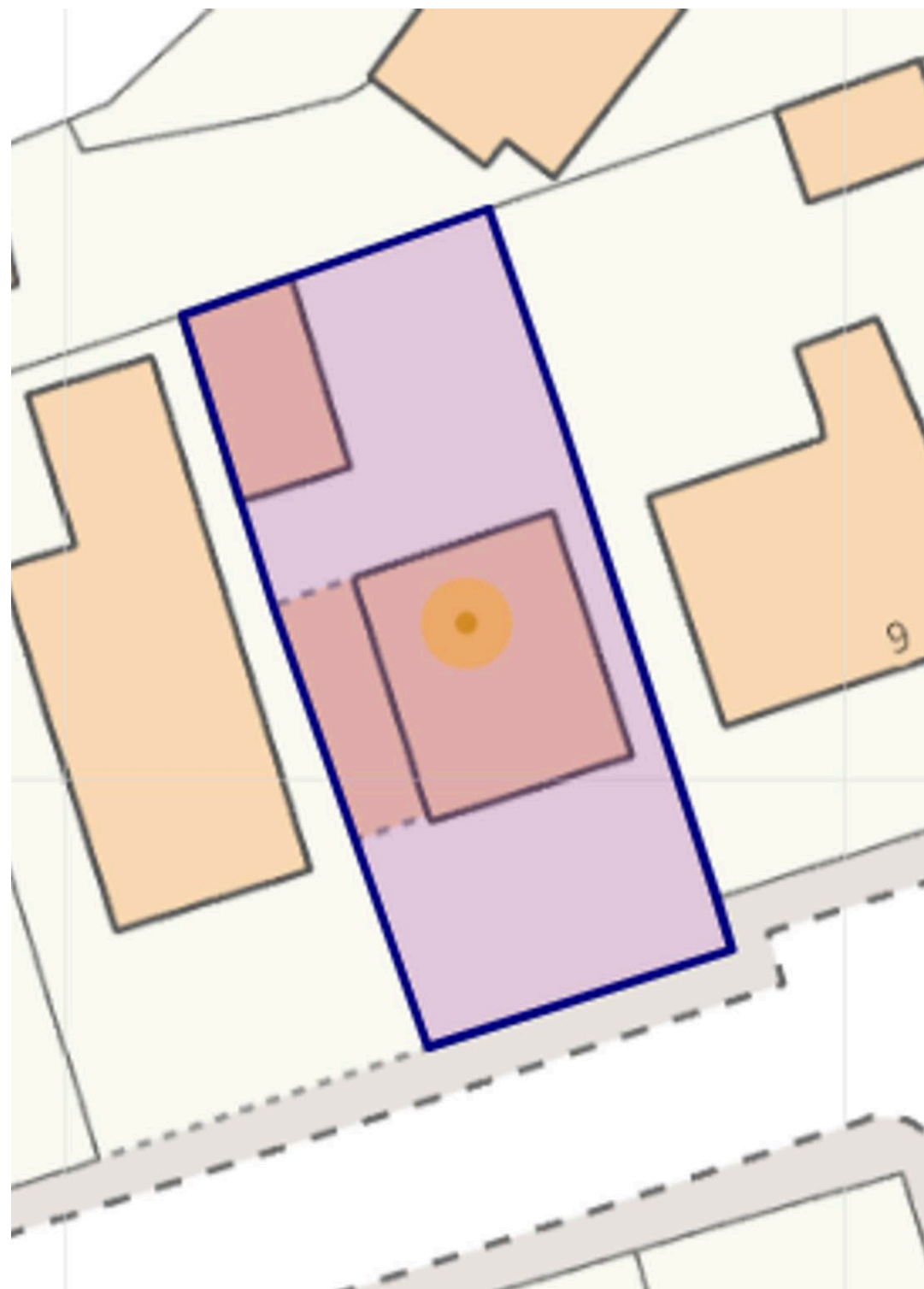



GROUND FLOOR
467 sq.ft. (43.4 sq.m.) approx.

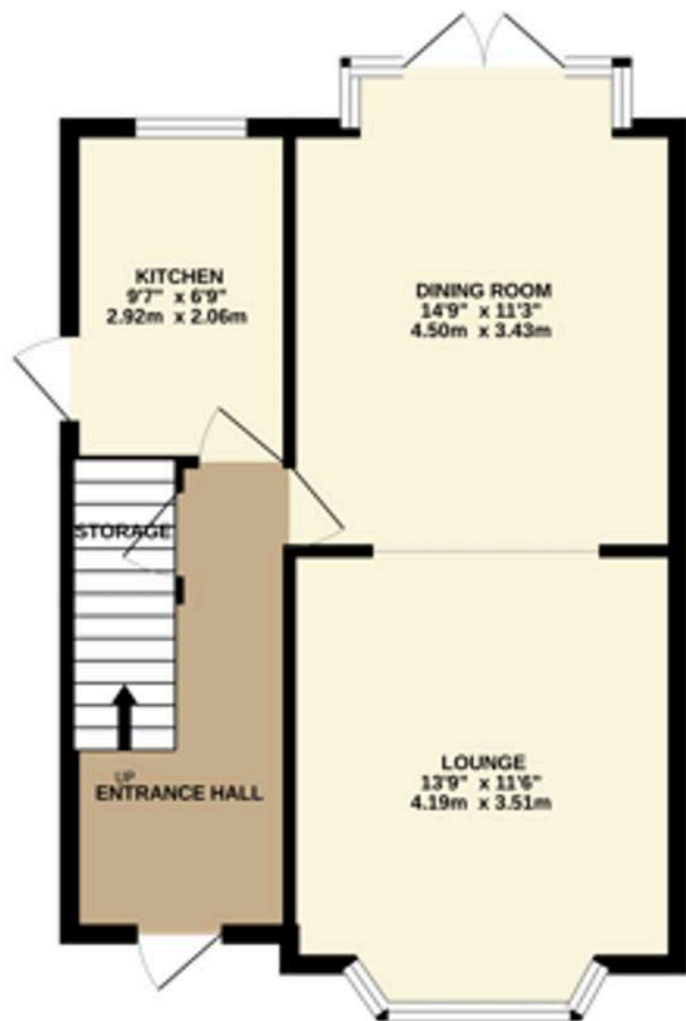

1ST FLOOR
453 sq.ft. (42.1 sq.m.) approx.

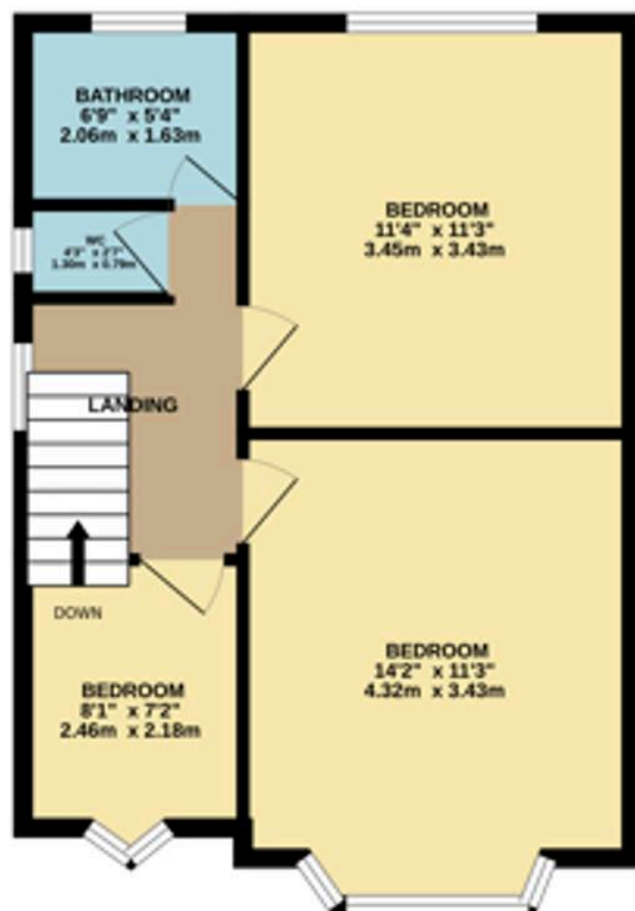

TOTAL FLOOR AREA: 921 sq.ft. (85.5 sq.m.) approx.

Whilst every attempt has been made to ensure the accuracy of the floorplan contained here, measurements of doors, windows, rooms and any other items are approximate and no responsibility is taken for any error, omission or mis-statement. This plan is for illustrative purposes only and should be used as such by any prospective purchaser. The services, systems and appliances shown have not been tested and no guarantee as to their operability or efficiency can be given.
Made with Metropix 02025