



Millfields Road, E5

£1,075,000

A three bedroom Victorian terrace in a prime Lower Clapton location with a south east facing garden and cellar. The house retains many of its original features; wooden flooring, bay window, cornicing & sash windows, and has potential to add value and extend into the loft, subject to planning.

Only half a mile from Millfields Park, Hackney Downs and the Hackney Marshes the home is surrounded by green spaces offering many opportunities for outdoor recreation. It is within the catchment area of many Outstanding primary & secondary schools and also in walking distance to the independent shops, cafés, weekend Market of Chatsworth Road and Lower Clapton Road. Clapton and Homerton Overground stations are under one mile away and there are numerous bus links on Lower Clapton Road giving you excellent transport links.

Features

- Victorian Terrace
- Three Double Bedrooms
- Cellar
- Garden
- Loft Potential, STPP
- Period Features
- Millfields Park



Millfields Road, E5

The ground floor consists of a double reception room with feature fire places and bay window. The kitchen with space to dine is to the rear of the house with skylight and access to the garden. There is also access to the basement and bathroom with shower.

Upstairs are three double bedrooms and family bathroom with separate W/C.

There is rear, basement and loft extension potential, subject to planning permission.



Millfields Road, London, E5

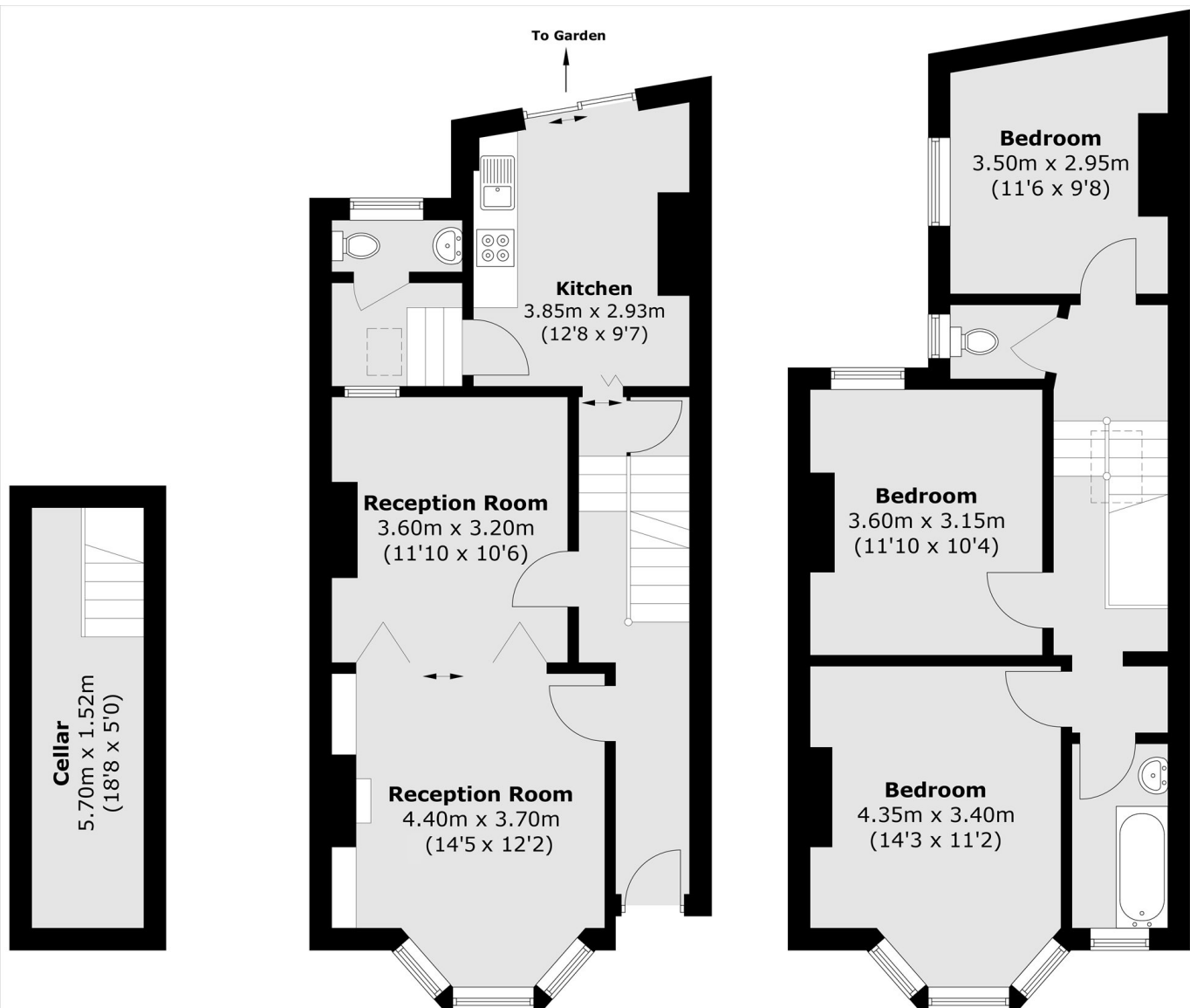

Cellar

Ground Floor

First Floor

Total area (approx.): 110.8 sq. m (1,192.5 sq. ft)
(Including Cellar)