



Highclere, Sunninghill

£675,000



Highclere, Sunninghill, Berkshire SL5 0AA

This three double bedroom bungalow is in a tucked away position conveniently located just a short walk into Sunninghill High Street.

FEATURES

- 1210 sq. ft
- Single storey bungalow
- Cul-de-sac position
- Walking distance to Sunninghill High Street
- Double glazing
- Gas central heating

ACCOMMODATION

- Entrance porch
- L shaped sitting room
- Dining room with feature floor to ceiling glass
- Kitchen
- Three double bedrooms
- Two bath/shower rooms

OUTSIDE

- Driveway parking
- South easterly facing rear garden
- Partly converted garage

EPC RATING

D

LOCAL AUTHORITY/COUNCIL TAX

Windsor and Maidenhead – Band E





Highclere

Approximate Gross Internal Area = 112.5 sq m / 1210 sq ft

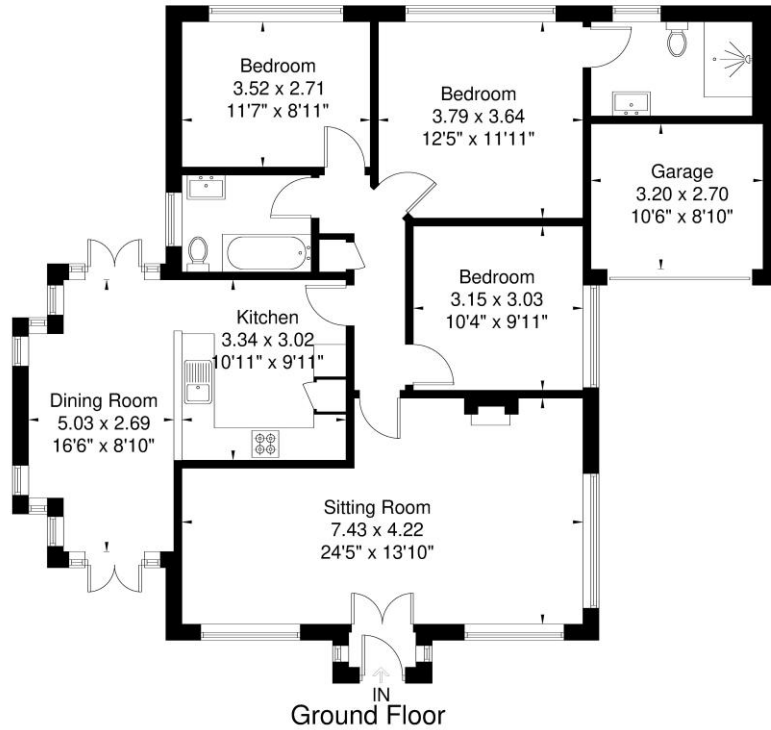

Ground Floor

Illustration for identification purposes only, measurements are approximate, not to scale.

Disclaimer: We wish to inform prospective purchasers that we have prepared these sales particulars as a general guide. We have not carried out a detailed survey, nor tested the services, appliances and specific fittings. Room sizes are approximate and rounded: they are taken between internal wall surfaces and therefore include cupboards / shelves, etc. Accordingly, they should not be relied upon for carpeting, curtains / blinds and kitchen equipment, whether fitted or not, are deemed removable by the vendor unless specifically itemized within these.



NEWTON ROWE
SALES & LETTINGS

The Old Dairy, 7 Updown Hill, Windlesham, Surrey GU20 6AF
enquiries@newtonrowe.co.uk | 01276 986900