



RICHMONDS

Shafford Meadows, Hedge End, Southampton, SO30 4SU

£335,000

Presented in immaculate order, this bright and spacious three-bedroom family home in the heart of Hedge End is ready to move into.

The property features a convenient ground floor cloakroom, a modern kitchen, and a lounge/dining room, with a private rear garden perfect for families. Upstairs, the master bedroom includes an en-suite, accompanied by two further bedrooms and a family bathroom.

Complete with off-road parking and situated in a prime location, this is an outstanding opportunity for families.

Key Features:

- Immaculate Three-Bedroom Family Home
- Master Bedroom with En-Suite
- Lounge/Dining Room & Modern Kitchen
- Ground Floor Cloakroom/W.C.
- Private Rear Garden
- Off-Road Parking to the Front
- Prime Location in Highly Desirable Hedge End
- Offered in Excellent Decorative Order

Other Information

Tenure: Freehold

Heating: Gas central heating

Windows: UPVC double glazing

Loft: Not inspected

Energy Rating: B

Sellers Position: Looking for a local property

Local Information:

Council Tax: C

Local Authority: Eastleigh Borough Council





Score	Energy rating	Current	Potential
92+	A		
81-91	B	85 B	85 B
69-80	C		
55-68	D		
39-54	E		
21-38	F		
1-20	G		

www.harprsurveyors.co.uk

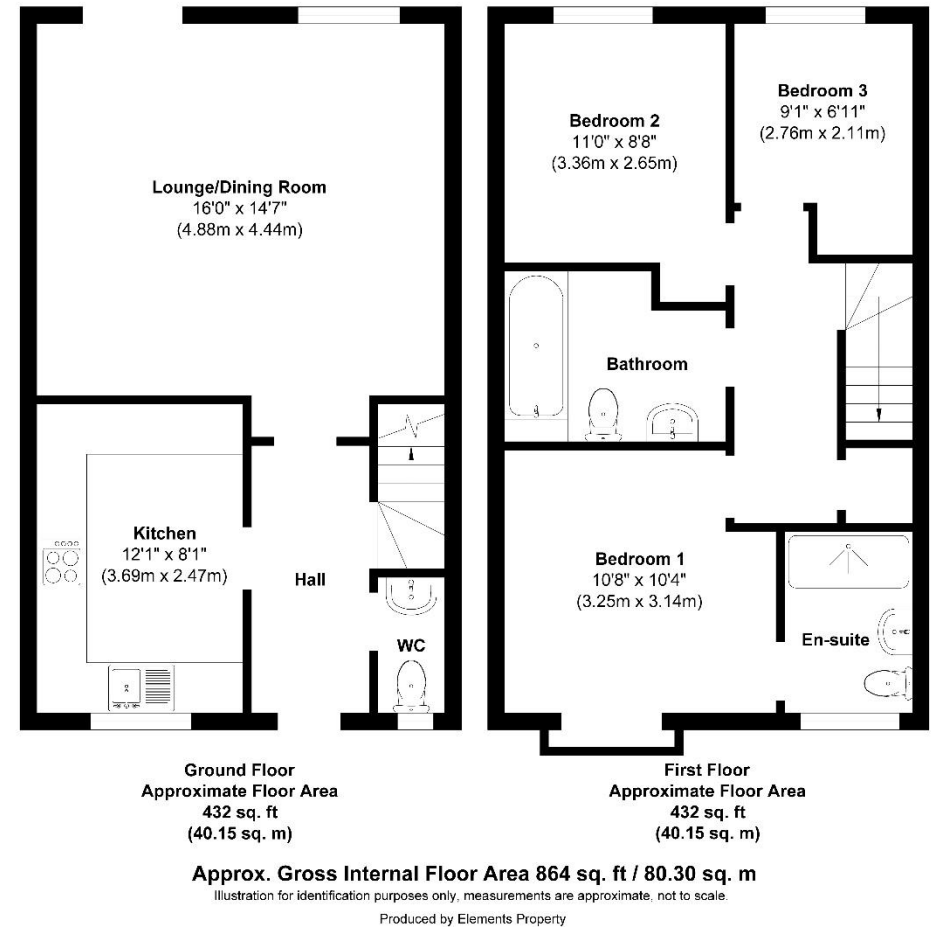

Agents Note: The sellers of the property have provided the above information to us and we are therefore reliant on them providing the correct information. The floor plan and sizes are to be used as a guide only. Please check room sizes prior to ordering carpets or furniture. If you require confirmation on any particular point for specific purposes please contact our office for further information. If you have other questions about this property, please telephone **01489 789933**

R545 Ravensworth 01670 713330

Lankester House, 1 Freegrounds Road, Hedge End, Southampton SO30 0HG • 01489 789933 • admin@richmondsproperty.co.uk

