



**Connells**

Mill Cottage Barton Mill Road  
Canterbury



### Property Description

Offered to the market with no onward chain is this very well presented two bedroom, semi detached cottage style home.

The property is ready to move in to and offers an ideal first time buy also boasting allocated parking within a secure gated development and a low maintenance courtyard garden. The property is also moments walk away from Canterbury's famous City centre with an array of shops and restaurants along with local amenities including superstores, newsagents and bus stops.

Both of Canterbury's main line train stations are also within reach with regular high speed services to London.

The property itself opens through a hall in to a spacious open plan living room with dining area and modern fitted kitchen and a downstairs cloakroom. To the first floor, there are two double bedrooms and a family bathroom.

Sold with no onward chain, this home is ready to view now.

## Entrance

11' 4" x 5' 7" ( 3.45m x 1.70m )

## Cloakroom

5' 7" x 4' 7" ( 1.70m x 1.40m )

## Lounge

15' 9" x 9' 5" ( 4.80m x 2.87m )

## Kitchen

6' 8" x 8' 1" ( 2.03m x 2.46m )

## Landing

14' 9" x 3' 6" ( 4.50m x 1.07m )

## Bedroom One

10' 6" x 9' 4" ( 3.20m x 2.84m )

## Bedroom Two

11' 7" x 11' 8" ( 3.53m x 3.56m )

## Bathroom

7' 4" x 6' ( 2.24m x 1.83m )







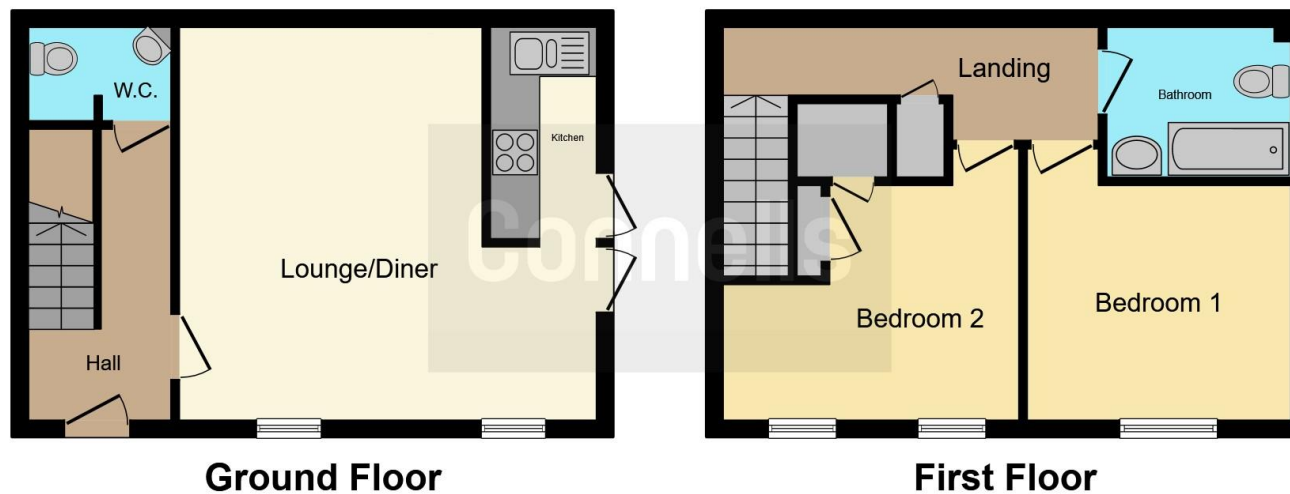

This floor plan is for illustrative purposes only. It is not drawn to scale. Any measurements, floor areas (including any total floor area), openings and orientation are approximate. No details are guaranteed, they cannot be relied upon for any purpose and they do not form part of any agreement. No liability is taken for any error, omission or misstatement. A party must rely upon its own inspection(s). Powered by [www.focalagent.com](http://www.focalagent.com)

To view this property please contact Connells on

**T 01227 764 720**  
**E [canterbury@connells.co.uk](mailto:canterbury@connells.co.uk)**

29-30 Watling Street  
 CANTERBURY CT1 2UD

EPC Rating: B Council Tax  
 Band: C

Tenure: Freehold

**view this property online [connells.co.uk/Property/CBY407013](http://connells.co.uk/Property/CBY407013)**



1. MONEY LAUNDERING REGULATIONS Intending purchasers will be asked to produce identification documentation at a later stage and we would ask for your co-operation in order that there will be no delay in agreeing the sale. 2. These particulars do not constitute part or all of an offer or contract. 3. The measurements indicated are supplied for guidance only and as such must be considered incorrect. Potential buyers are advised to recheck measurements before committing to any expense. 4. We have not tested any apparatus, equipment, fixtures, fittings or services and it is in the buyers interest to check the working condition of any appliances.

Connells Residential is registered in England and Wales under company number 1489613, Registered Office is Cumbria House, 16-20 Hockliffe Street, Leighton Buzzard, Bedfordshire, LU7 1GN. VAT Registration Number is 500 2481 05.

**See all our properties at [www.connells.co.uk](http://www.connells.co.uk) | [www.rightmove.co.uk](http://www.rightmove.co.uk) | [www.zoopla.co.uk](http://www.zoopla.co.uk)**

Property Ref: CBY407013 - 0006