





**Towers  
Wills**

Town & Country

**Willow Cottage, East Coker, Somerset, BA22 9JY**

**£550,000**

 01935 577 032 | 01460 298 530 |  [info@towerswills.co.uk](mailto:info@towerswills.co.uk)





**Features:**

**Sought after location**

**Beautiful character home**

**Versatile accommodation**

**Approx. 0.3 acre plot**

**Character features throughout**

**Three reception rooms**

**Four / Five bedrooms**

**Utility room**

**Mature gardens**

**Freehold**







Towers Wills are delighted to present Willow Cottage, a charming detached family home of great character, believed to date back to early 18<sup>th</sup> century. Rich with period features, including exposed beams, Inglenook fireplaces, and exposed stone walls, this wonderful home is set within a particularly generous plot of approximately one-third of an acre on the fringe of this sought after village, and is offered to the market with no onward chain.

The property offers three reception rooms, a kitchen/ breakfast room with utility room, cloak/ W.C, four / five bedrooms, bathroom, driveway, garage and glorious gardens.



The hallway offers a spacious reception area which instantly greets you with character features and leads to: The living room. A dual-aspect reception room with windows to both front and side, full of warmth and character, centred around a magnificent Ingle Nook fireplace with window seats and exposed beams—an impressive focal point of the home.

The dining room offers an equally impressive, elegant dual-aspect room with windows to the front and side. Window seats. Perfect for entertaining with family and friends. Featuring a second Ingle Nook fireplace, exposed beams, and a charming window seat.





A generous kitchen/breakfast room is fitted with a comprehensive range of wall, base, and drawer units, timber work surfaces. Integrated double electric oven, electric hob with cooker hood, plumbing for dishwasher, and space for a fridge-freezer. With room for a family dining table and chairs and direct access to the utility room. Housing the oil-fired boiler, tiled flooring, and door to the rear.

If you require a separate space for work, reading or similar the study offers a quiet versatile space to retreat. Also to the ground floor is a cloakroom/WC and charming rear porch with impressive timber door.

The first floor offers four / five bedrooms and a family bathroom. Bedrooms one and two being particularly generous double bedrooms with outlooks to the front and space for wardrobes. While bedrooms three and four still being double rooms enjoy glorious countryside views to the rear. Bedroom three having a convenient dressing area with wash hand basin. All bedrooms are serviced by a spacious family bathroom.



### Outside

The property occupies an exceptionally large plot approximately 1/3 of an acre plot, a true highlight of Willow Cottage. Immediately to the rear is a picturesque cottage-style garden, laid mainly to lawn with stone patio area, pond, pergola, and useful outbuilding making an ideal home office/ hobby room etc

The garden continues to a further lawn with a variety of mature plants, trees, and shrubs, and at the far end, a large vegetable plot offers opportunities for those with green fingers. To the front a sweeping driveway leads to a detached garage with up-and-over door, and an adjoining large wood store. Ample parking area.





GROUND FLOOR

1ST FLOOR

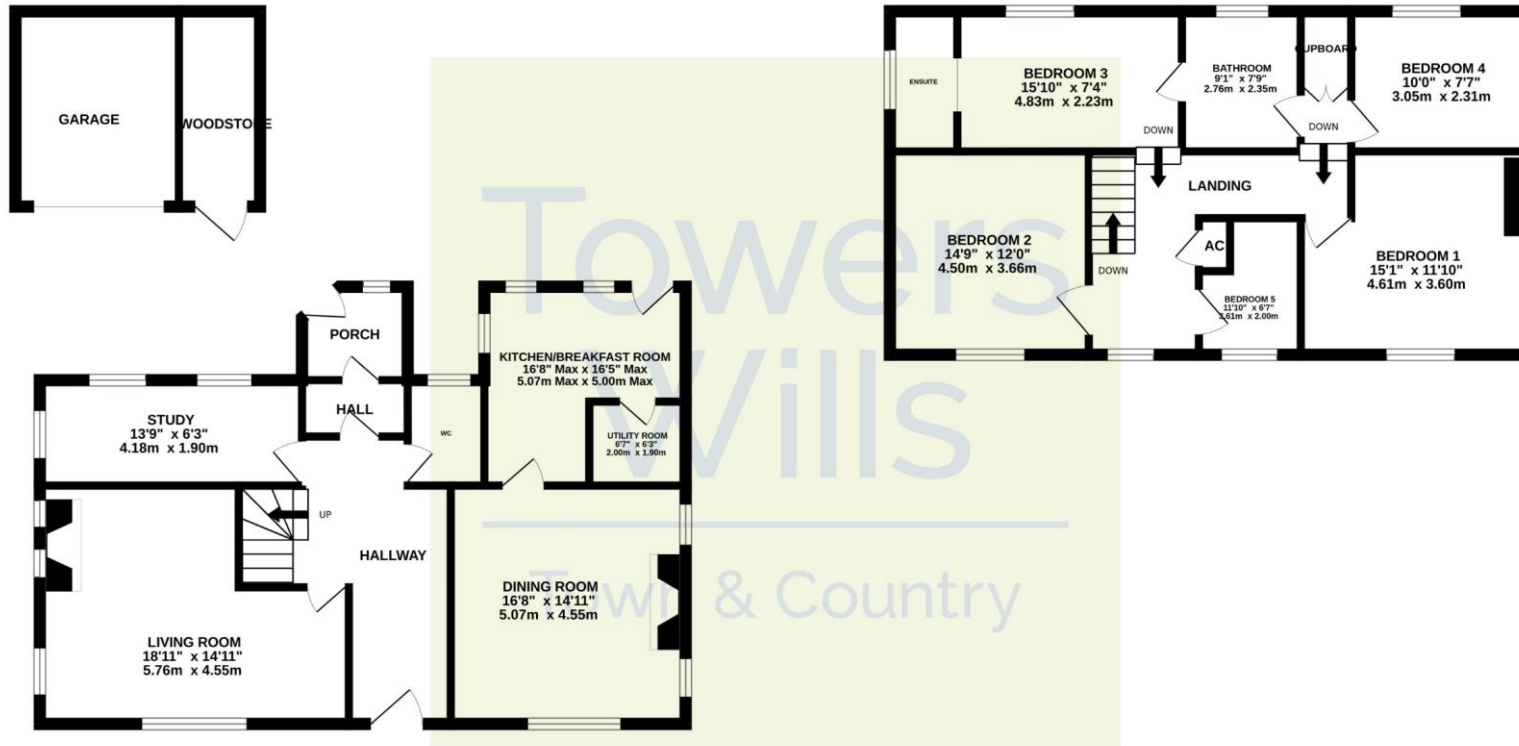

Whilst every attempt has been made to ensure the accuracy of the floorplan contained here, measurements of doors, windows, rooms and any other items are approximate and no responsibility is taken for any error, omission or mis-statement. This plan is for illustrative purposes only and should be used as such by any prospective purchaser. The services, systems and appliances shown have not been tested and no guarantee as to their operability or efficiency can be given.  
Made with Metropix ©2025

Epc-pending

**T: 01935 577032 E: [info@towerswills.co.uk](mailto:info@towerswills.co.uk)**

**The White House 114 Hendford Hill, Yeovil, Somerset BA20 2RF**

**[www.towerswills.co.uk](http://www.towerswills.co.uk)**

Please Note No tests have been undertaken of any of the services and any intending purchasers should satisfy themselves in this regard. Towers Wills Ltd for themselves and for the vendor of this property whose agents they are, give notice that, (i) these particulars do not constitute any part of an offer or contract, (ii) all statements contained within these particulars are made without responsibility on the part of Towers Wills or the vendor, (iii) whilst made in good faith, none of the statements contained within these particulars are to be relied upon as a statement of representation or fact, (iv) any intending purchaser must satisfy him/herself by inspection or otherwise as to the correctness of each of the statements contained within these particulars, (v) the vendor does not make or give either Towers Wills or any person in their employment any authority to make or give representation or warranty whatsoever in relation to this property. Photographs / Floor Plans Photographs are reproduced for general information and it must not be inferred that any item is included for sale with this property. Please note floor plans are not to scale and are for identification purposes only. The photographs used in these particulars may have been taken with the use of a wide angle lens. If you have any queries as to the size of the accommodation or plot, please address these with the agent prior to making an appointment to view.