



STEVENS PROPERTY
MANAGEMENT



Lacey Gardens, Louth

RENT £795 Per Calendar Month DEPOSIT £915

COUNCIL TAX BAND A EPC 60

- Larger than average 3 Bedroom semi detached house
- Sun lounge to the Rear
- Enclosed Rear Garden with Outbuilding
- Standard, ultrafast, superfast broadband speeds available at this property.
- Kitchen/Diner
- Residents parking (first come first serve basis)
- FTTC, Mains Drainage, GCH
- Council tax band A and EPC 60D

13 Cornmarket, Louth, Lincolnshire, LN11 9PY
01507 605 721

enquiries@stevenspropertymanagement.co.uk
www.stevenspropertymanagement.co.uk



Tucked away down a pedestrian access only footpath is this, larger than average three-bedroom semi-detached house in 'Lacey Gardens' presents an excellent opportunity for families and professionals alike. The property boasts a modern breakfast kitchen, complete with a cooker. The spacious layout of the house ensures ample room for comfortable living, with three bedrooms (some fitted furniture) that can accommodate a growing family or provide versatile space for guests or a home office. The enclosed garden offers a private outdoor retreat. Residents will appreciate the convenience of residents parking available on a first-come, first-served basis. Additionally, the property is situated within close proximity to several schools, making it an attractive option for families with children. Council tax A and EPC 60D

According to Ofcom there is standard, superfast and ultrafast broadband speeds available at this property with download speeds of 16MBPS, 66MBPS and 1000MBPS, upload speeds of 1MBPS, 18MBPS and 10000MBPS

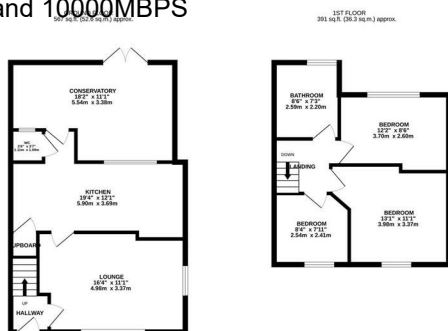

General information:

Holding Fee - A holding fee equivalent to one week's rent is required on submission of application prior to formal referencing.

More Property Information - If you would like any further specific information relating to this property please do not hesitate to email directly.

Pets Clause - No pets without express prior permission of the landlord, which shall not be unreasonably withheld.

Tenancy Length - Length of tenancy: minimum fixed term period 6 months, becoming a monthly contractual periodic tenancy thereafter. 12 month tenancies may be negotiable at the discretion of the applicant/landlord.

Tenant Protection - Tenant protection Stevens Property Management Ltd is a member of Property Mark Client Money Protection which is a client money protection scheme, and also a member of The Property Ombudsman which is a redress scheme. You can find out more details on the agent's website or by contacting the agent directly

Energy Efficiency Rating		
	Current	Potential
Very energy efficient - lower running costs		
(92 plus) A		
(81-91) B		
(69-80) C		
(55-68) D		
(39-54) E		
(21-38) F		
(1-20) G		
Not energy efficient - higher running costs		
England & Wales		
		EU Directive 2002/91/EC