



## Lime Kiln Lane, Thetford, Norfolk, IP26 4BG

**Rent - Offers In Excess Of £270,000      Deposit -**

An excellent opportunity to acquire this spacious and well presented three bedroom semi-detached bungalow situated in a non-estate position yet still conveniently located within close proximity to the village centre and its amenities. Offered to the market with viewings highly recommended.

- NON ESTATE POSITION
- OPEN PLAN LOUNGE/DINER/KITCHEN
- BATHROOM
- SOLAR PANELS
- GOOD PARKING
- ENTRANCE HALL
- THREE DOUBLE BEDROOMS
- OIL FIRED CENTRAL HEATING
- SPACIOUS ACCOMMODATION
- VIEWING RECOMMENDED



Council Tax Band: B - EPC Rating: B 85

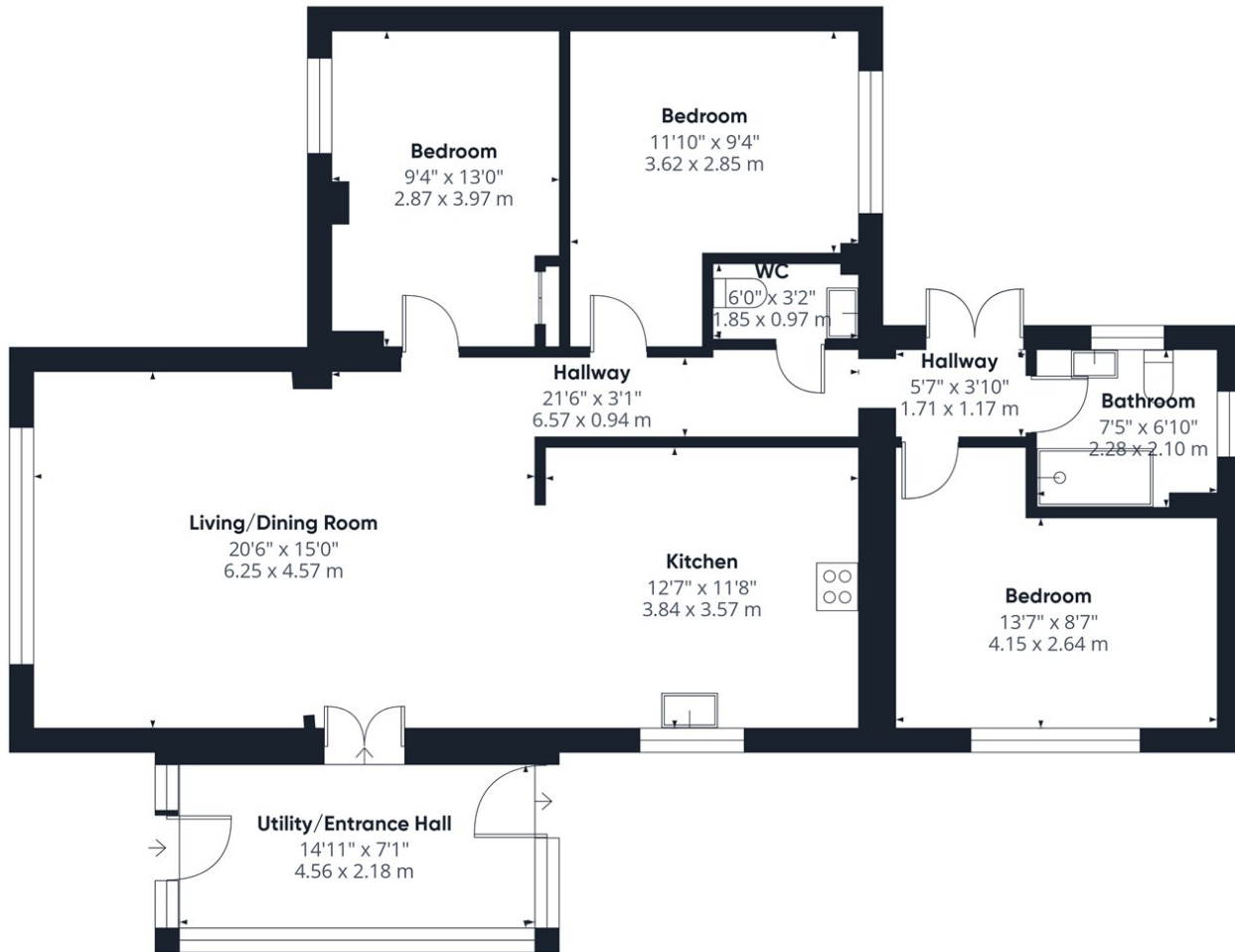

**Approximate total area<sup>(1)</sup>**  
1120 ft<sup>2</sup>  
104.1 m<sup>2</sup>

(1) Excluding balconies and terraces

While every attempt has been made to ensure accuracy, all measurements are approximate, not to scale. This floor plan is for illustrative purposes only.

Calculations were based on RICS IPMS 3C standard. Please note that calculations were adjusted by a third party and therefore may not comply with RICS IPMS 3C.

GIRAFFE 360

