



Orchard Grove, Wolverton, Milton Keynes, MK12

Milton Keynes

£300,000

expo.uk

Bedrooms: | Bathrooms: | Receptions:
2 | 1 | 1

Council Tax Band: B

Tenure: Freehold

Property Type: Semi Detached House

- Thermal solar panels supporting hot water and helping reduce energy co
- Deceptively spacious two bedroom semi detached home built to a three bedroom footprint
- Modern and well presented throughout ready to move straight into
- Stylish kitchen diner ideal for everyday living and entertaining
- Unique downstairs WC combined with a practical utility space
- Larger than a typical 2 bedroom home
- South east facing rear garden enjoying excellent natural light
- Driveway parking for one vehicle with space for two in tandem
- Well located in Wolverton close to schools, shops, leisure facilities and transport links
- EG1332



ETHAN GAULTER

exp

EG1332

A beautifully presented and deceptively spacious two bedroom semi detached home in the ever popular area of Wolverton, Milton Keynes. Built with the proportions of a three bedroom home but configured as a generous two bedroom, this property offers excellent space, modern living and fantastic value for money.

Internally, the home is finished to a high standard throughout and is ready to move straight into. The ground floor offers a bright and welcoming living room leading through to a stylish kitchen diner, perfect for both everyday living and entertaining. A real standout feature is the unique downstairs WC combined with a utility space, adding practicality rarely found in homes of this type.

Upstairs, the property continues to impress with two well proportioned bedrooms that benefit from the larger than average footprint, alongside a modern family bathroom.

One of the key benefits of this home is the inclusion of thermal solar panels, which directly support the hot water system. This helps reduce energy costs by heating water throughout the day and assisting the central heating system, making the home more efficient and cost effective to run.

Externally, the property boasts a well maintained south east facing rear garden, ideal for enjoying morning and afternoon sun. To the front, there is parking for one vehicle with the ability to accommodate two cars in tandem.

The location is equally appealing. You are approximately an 11 minute walk to Radcliffe Secondary School, around a 4 minute walk to a local convenience shop, and roughly a 12 minute walk to a popular children's play park and Wolverton Swimming and Fitness Centre. Wolverton train station is approximately a 6 minute drive away, offering direct links into London Euston, making this a great option for commuters.

This is a fantastic opportunity to secure a modern, energy efficient home in a well connected and sought after location.

Get in touch today to secure your viewing slot.

Please note: some sellers may require an agreed sale protection product to provide greater certainty for both parties once a sale is agreed. Full details are available from the agent via the virtual tour link (orange button, top right), QR code, business card or email signature.



Approx Gross Internal Area
67 sq m / 722 sq ft

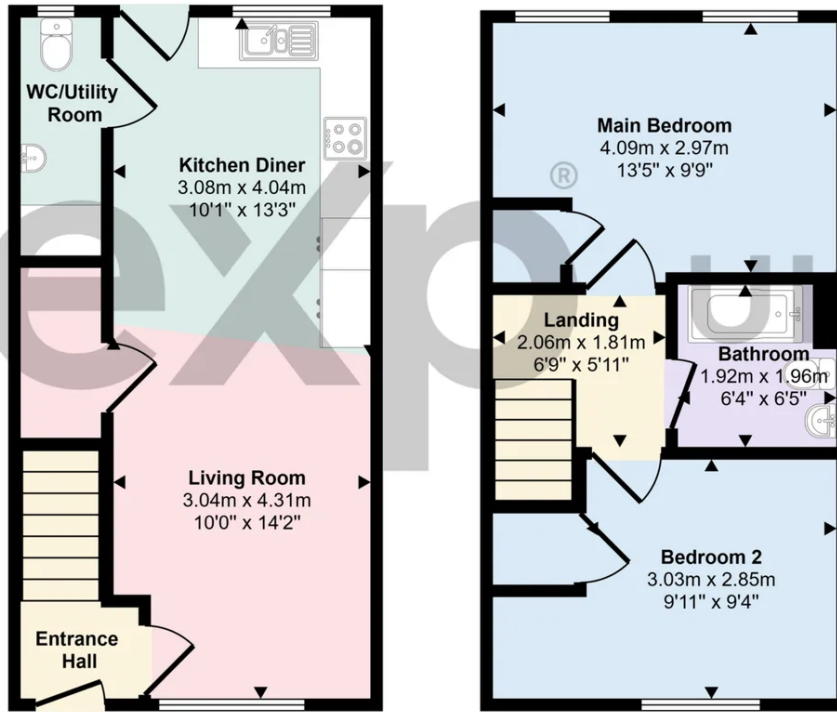

This floorplan is only for illustrative purposes and is not to scale. Measurements of rooms, doors, windows, and any items are approximate and no responsibility is taken for any error, omission or mis-statement. Icons of items such as bathroom suites are representations only and may not look like the real items. Made with Made Snappy 360.



Score	Energy rating	Current	Potential
92+	A		
81-91	B		83 B
69-80	C	78 C	
55-68	D		
39-54	E		
21-38	F		
1-20	G		

Ethan Gaulter
Local Estate Agent
01908 464 950
Ethan.Gaulter@exp.uk.com
<https://ethangaulter.exp.uk.com>

ETHAN GAULTER

