



## Maple Road, KT6

£485,000

A beautifully presented, ground floor maisonette situated in open mature grounds in central Surbiton. This property offers two large double bedrooms, a bright and beautiful dining/living room, a newly fitted stylish separate kitchen and brand new bathroom. The property further benefits from direct access onto shared gardens and unallocated parking.

Exeter Court is on Maple Road, a highly desirable place to live, offering an array of shops, bars, restaurants and the famous farmers market. Surbiton train station is less than a third of a mile away with fast links to Waterloo.

### Features

- Maisonette
- Large Apartment
- Two Double Bedrooms
- New Kitchen & Bathroom
- Communal Grounds
- Sought After Location

# Maple Road, Surbiton, KT6

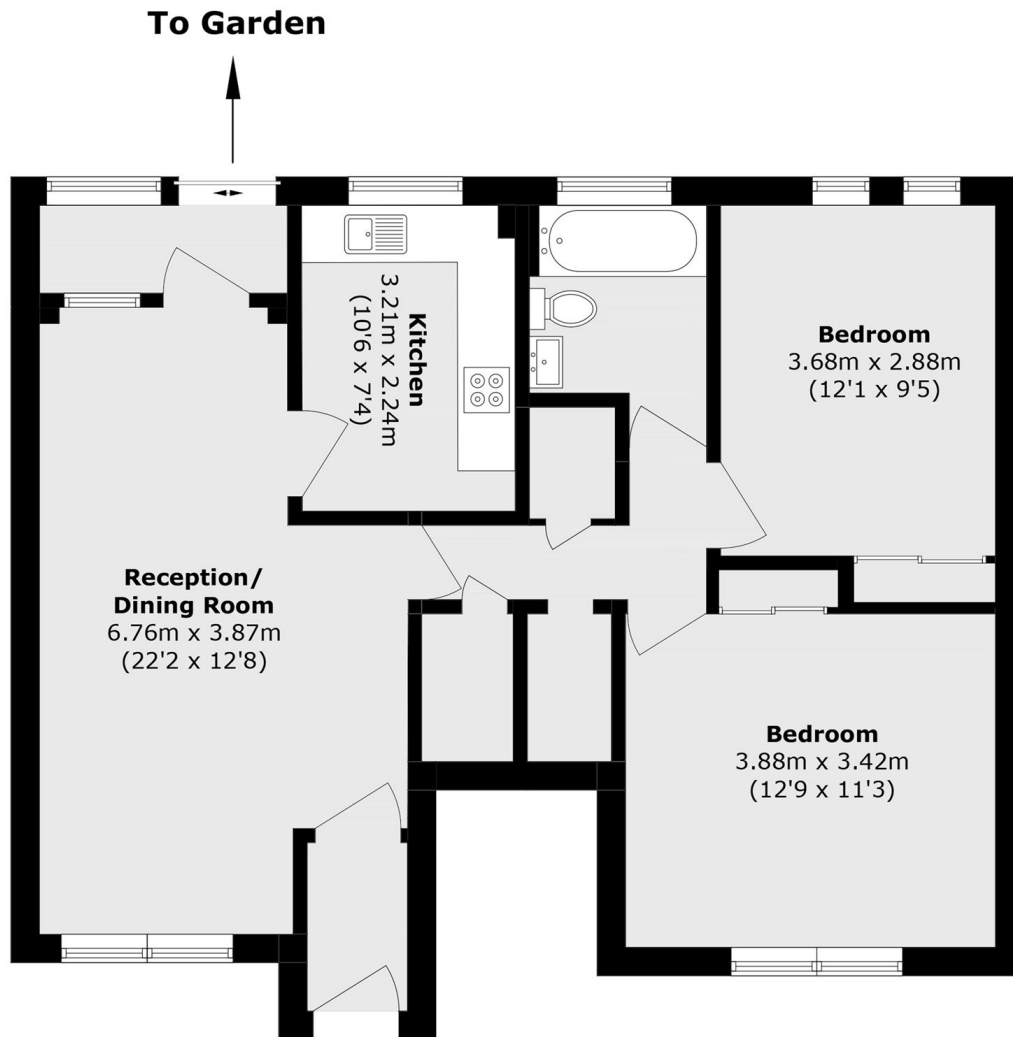

Total area (approx.): 73.9 sq. m (795.4 sq. ft)