



Chisenhale Road
London, E3 5QY

£4,200 PCM



Elms Estates are delighted to be able to offer to the market To Let this Four Bedroom Terraced House.

Chisenhale Road is superbly located with Mile End and Bethnal Green station all within walking distance, making your commute into the city effortless. The property is nestled in an attractive residential area with great independent pubs, cafes and restaurants. within a short walk are the glorious open spaces of Victoria Park along with the beautiful Regents Canal, Broadway Market and Hackney Wick.

Internally the property is bright and spacious throughout with a large reception, separate kitchen, four double bedrooms, shower room with a further separate shower and own rear garden.

Chisenhale Road is available from 29 July 2026. An early internal inspection is highly recommended in order to avoid disappointment.

For more information or to arrange a viewing please do not hesitate to call in and speak with one of our Property Consultants.



Reception

11'5" x 11'5" (3.48 x 3.48)

Kitchen

15'8" x 8'5" (4.78 x 2.57)



Bedroom One

15'5" x 11'6" (4.70 x 3.51)



Bedroom Two

15'7" x 8'9" (4.75 x 2.69)



Bedroom Three

11'6" x 9'10" (3.51 x 3.02)



Shower Room



Bedroom Four

11'3" x 9'8" (3.45 x 2.97)



Separate Shower





Chisenhale Road, E3

Approx. Gross Internal Area 1065 Sq Ft - 98.94 Sq M

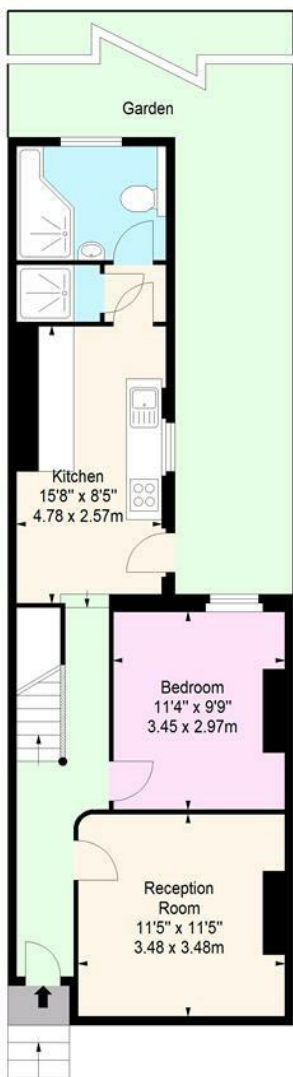

Ground Floor

Floor Area 569 Sq Ft - 52.86 Sq M



First Floor

Floor Area 496 Sq Ft - 46.08 Sq M

For Illustration Purposes Only - Not To Scale
www.londonpropertyassessments.co.uk

