



St. Mary Road, Walthamstow, London, E17

£2,150 PCM

TO LET



Furnished/unfurnished

- 2 Bedrooms Terraced House
- Kitchen/Diner
- Double Glazing
- Gas Central Heating
- Popular Walthamstow Village location
- Walthamstow Central tube station: 0.1 mile
- Deposit: £2480.76
- EPC Rating: C (72)
- Council Tax Band: C
- Internal: 613 sq ft (57.0 sq m)

A bright and spacious two bedroom house on St Mary Road. Ideally located for Walthamstow Central station, as well as all the sights and sounds of the Village, this is a property presented to a high standard throughout.

Internally, the house comprises a spacious reception room, fitted kitchen diner, three piece family bathroom and two bedrooms (one double, one single).

Shall we take a look?

St. Mary Road, Walthamstow, London, E17

DIMENSIONS

Reception Room

15'0 x 12'11 (4.57m x 3.94m)

Kitchen/Diner

17'10 x 9'4 (5.44m x 2.84m)

Bedroom One

13'0 x 9'1 (3.96m x 2.77m)

Bedroom Two

9'1 x 8'2 (2.77m x 2.49m)

First Floor Bathroom

9'1 x 6'1 (2.77m x 1.85m)

Additional Information:

Local Authority: London Borough Of Waltham Forest

Disclaimer:

We endeavour to ensure that our particulars are as accurate and reliable as possible; however, they do not constitute or form part of any offer or contract and should not be relied upon as statements or representations of fact. All measurements are approximate and provided as a guide only. Any systems, services, or appliances referred to have not been tested by us, and we are therefore unable to verify or guarantee their working condition. All photographs, floorplans and video tours are provided for guidance only. Tenants are advised to verify details relating to planning permissions, building regulations, and any works carried out at the property with their solicitor or conveyancer, as well as tenure and lease information where applicable.

FLOORPLAN

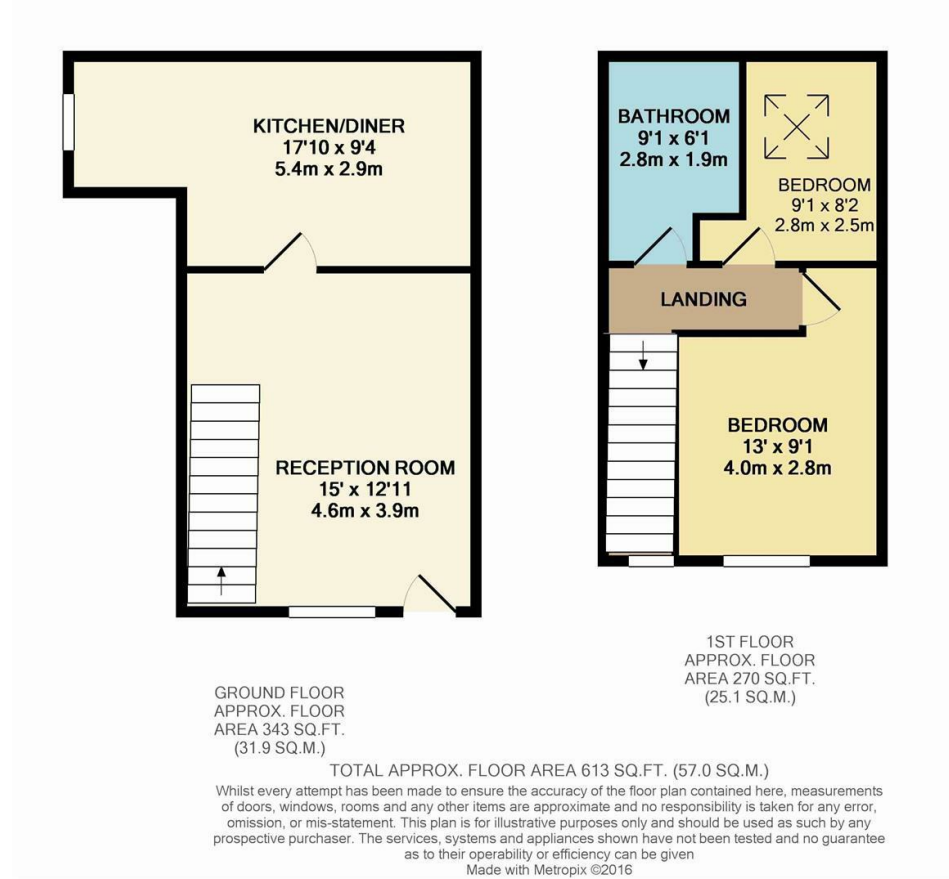

EPC RATING

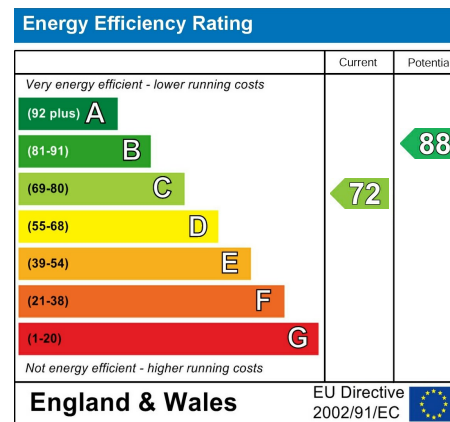

LOCATION

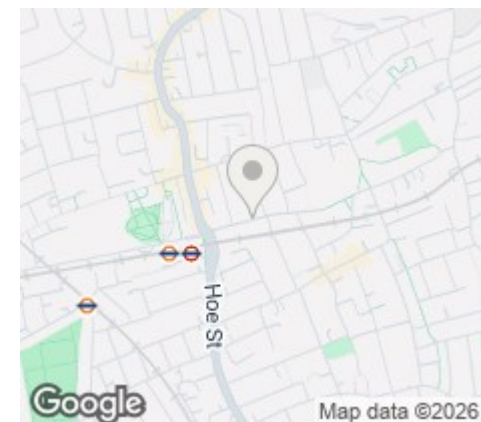

hello@estateseast.co.uk 020 8520 9300 estateseast.co.uk

