

# bear

*Estate Agents*



\* £210,000- £230,000 \* Centrally located on London Road in the charming area of Chalkwell, this impressive split-level maisonette flat offers a delightful blend of space and modern living. With three generously sized bedrooms on the top floor, this property is perfect for families or those seeking extra room for guests or a home office, thanks to the additional study or storage room. The heart of the home is undoubtedly the fully fitted kitchen breakfast room, which provides an ideal space for culinary enthusiasts to create and enjoy meals. The modern bathroom suite adds a touch of luxury, while the generous lounge diner serves as a welcoming area for relaxation and entertaining. One of the unique features of this property is the small outside roof terrace area, perfect for enjoying a morning coffee or unwinding in the evening sun. Location is key, and this maisonette does not disappoint. It is within walking distance to the beautiful Chalkwell Beach, where you can enjoy leisurely strolls along the shore, as well as Chalkwell Station, making commuting a breeze. Additionally, the property is conveniently situated on the doorstep of Chalkwell Park, offering ample green space for outdoor activities and relaxation. This maisonette flat is a rare find in a sought-after location, combining comfort, style, and convenience. It presents an excellent opportunity for those looking to embrace the coastal lifestyle while enjoying the amenities of Westcliff-on-Sea.

- Split-level maisonette
- Three good-sized bedrooms plus a large storage room (Could be used as a study or additional bathroom)
- Modern fully fitted kitchen
- White bathroom suite
- Recently double glazed windows
- Small outside roof terraced area
- No onward chain
- Great buy to let or HMO potential
- Fantastic location on the doorstep to Chalkwell Park
- Short walking distance to Chalkwell Beach and Station

## London Road

Westcliff-on-Sea

**£210,000**

Price Guide



# London Road



## Externally

Concrete steps leading up to the first floor entrance, outside area that could be used as a garden area or a storage, door to:

## Hallway

Smooth ceiling with a pendant light, carpeted stairs to the top floor landing, UPVC entrance door to the front with an inset coconut rug, lino flooring, understairs storage, radiator, door to:

## Kitchen

11'10" x 10'2"

Double glazed window to the front, modern white gloss kitchen comprising of; wall and base level units with a roll edge laminate worktop, stainless steel sink and drainer, space for a washing machine, space for a fridge freezer, integrated oven and grill with a four ring gas hob and an extractor fan above, wall mounted ideal independent boiler, lino flooring.

## Bathroom

7'3" x 6'3"

Obscured double glazed window to the front, smooth ceiling, p-shaped bath with a drenched head and a shower hose, combined low-level WC and wash basin vanity unit, lino flooring, radiator.

## Lounge-Diner

21'7" x 13'3" x 10'4"

Smooth ceiling with two pendant lights, double glazed windows to the front and side aspects, feature fireplace area, radiator, carpet.

## Top Floor Landing

Smooth ceiling with a pendant light, double glazed window to the side, loft hatch.

## Bedroom One

13'4" into the bay x 10'4"

Double glazed window to the front, smooth coved ceiling with a pendant light, radiator, carpet.

## Bedroom Two

11'2" into the bay x 10'5"

Double glazed window to the rear, smooth ceiling with a pendant light, radiator, carpet.

## Bedroom Three

10'11" into the bay x 8'5"

Double glazed bay window to the front, smooth ceiling with a pendant light, radiator, carpet.

## Large Storage Cupboard

8'4" x 4'9" > 3'10"

Smooth ceiling with a pendant light, carpet.



# Floor Plan

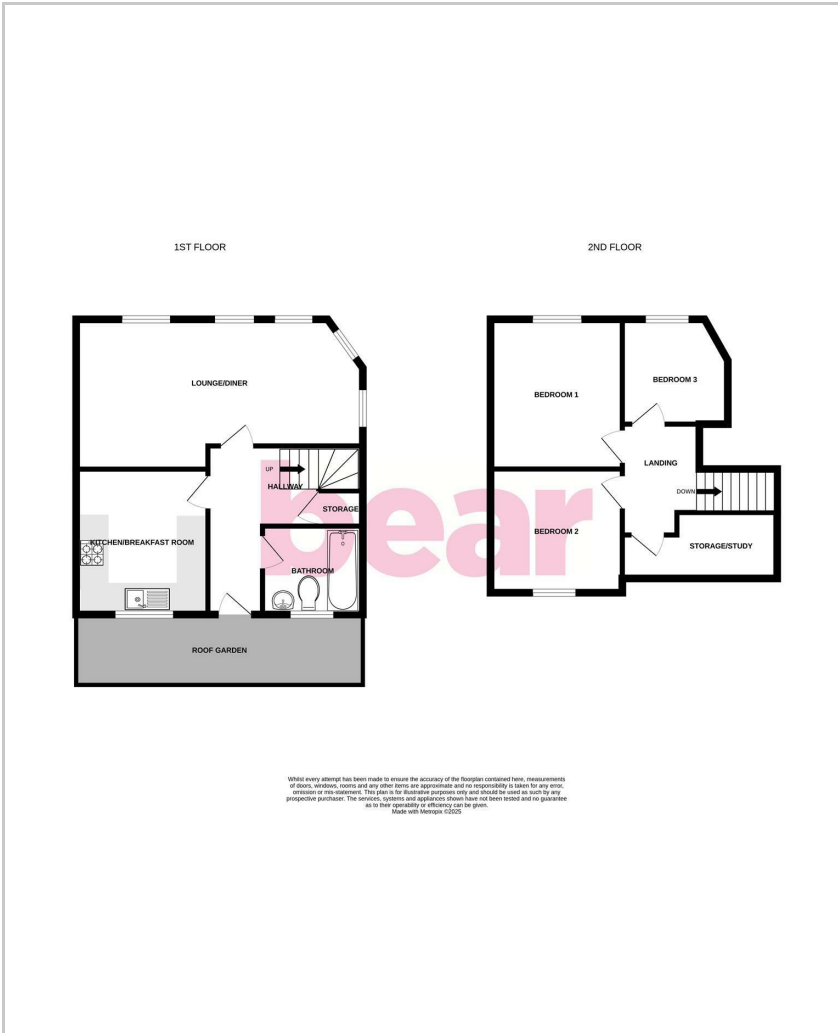

## Area Map

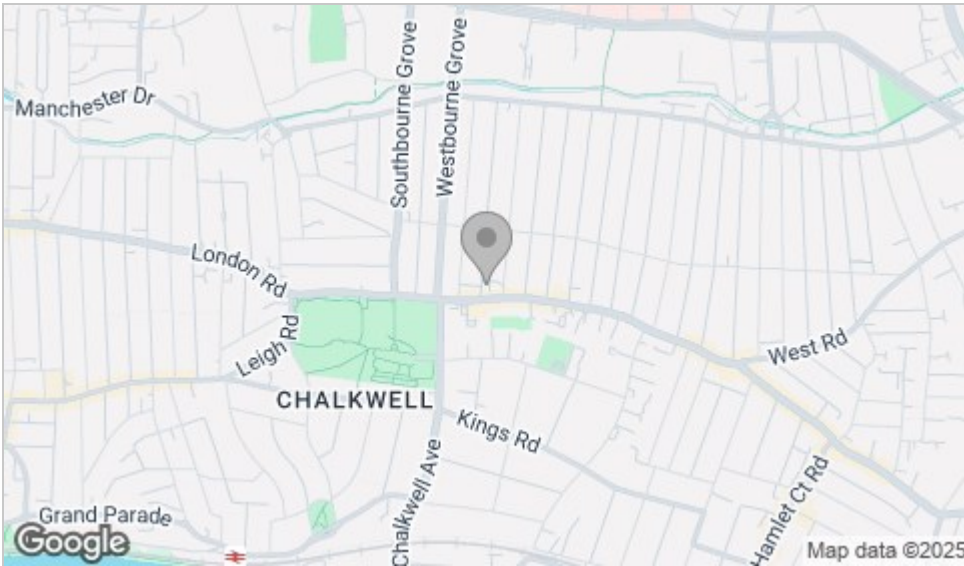

## Viewing

Please contact our Leigh-on-Sea Office on 01702 887 496 if you wish to arrange a viewing appointment for this property or require further information.

These particulars, whilst believed to be accurate are set out as a general outline only for guidance and do not constitute any part of an offer or contract. Intending purchasers should not rely on them as statements of representation of fact, but must satisfy themselves by inspection or otherwise as to their accuracy. No person in this firm's employment has the authority to make or give any representation or warranty in respect of the property.

1336 London Road, Leigh-on-Sea, Essex, SS9 2UH

Office: 01702 887 496 [los@bearestateagents.co.uk](mailto:los@bearestateagents.co.uk) <http://www.bearestateagents.co.uk/>

## Energy Efficiency Graph

