

## **Westcroft Gardens Morden, SM4 4DJ**

**Asking Price £675,000 Freehold**



Offered to the market with no onward chain and situated in a sought-after residential location. This well-maintained 1930s “Blay style” three-bedroom mid-terrace home offers spacious and comfortable living. The property comprises two separate reception rooms, a modern, well proportioned kitchen. Low-maintenance 70ft east-facing garden with shed and rear access. Upstairs features three generously sized bedrooms and a modern family bathroom with both shower and bathtub. Enviably located within easy reach of excellent schools, numerous recreation grounds and a myriad of transport links including Morden Northern Line Tube and South Merton Thameslink.



## WESTCROFT GARDENS, SM4

Approx. Gross Internal Floor Area

1077 Sq. ft/100.06 Sq. m

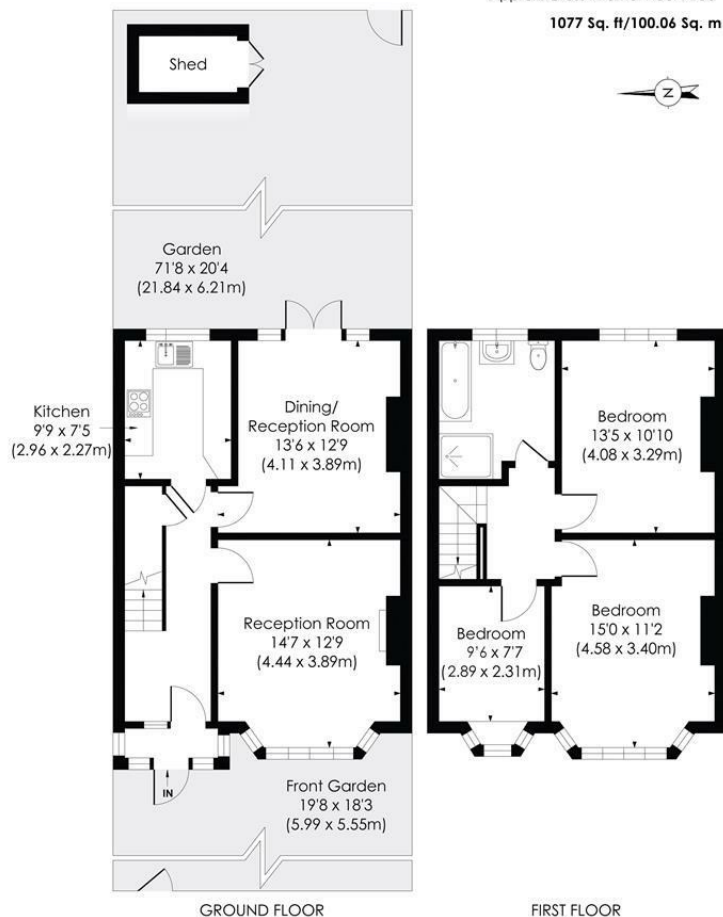

© Pixangle Property Marketing Ltd. info@pixangle.com Tel: 0208 870 2118

pixangle  
PROPERTY MARKETING

This floor plan has been prepared for the purpose of illustration only in accordance with the latest RICS code of measuring practice and is not to scale. All measurements and areas are approximate and whilst every effort has been made to ensure the accuracy of the plan contained here, no responsibility is taken for any error, omission or misstatement.

- Three Bedroom Terraced Family Home
- In Great Condition Throughout
- No Onward Chain
- Potential to Extend (STPP)
- 70ft Landscaped Garden
- Walking Distance to Various Transport Links
- Desirable Schools Nearby
- Freehold
- EPC Rating - D
- Merton Council Tax Band - E

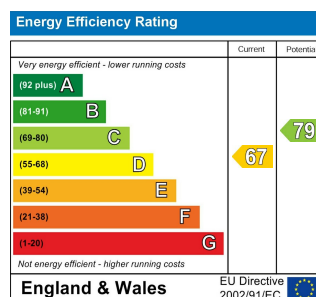

For Free Mortgage Quote and Best Mortgage Rates, call Ellisons Mortgage Advisor on 0208 543 1166



Although these particulars are believed to be correct, their accuracy is not guaranteed and they do not form part of any contract.

Celebrating 30 years  
of successful Sales and  
Lettings in Merton

