



# CROMWELL ROAD, SW5

£370,000

Studio  
Separate Kitchen  
Wooden Floors Throughout  
Lift and Porter  
Great Kensington Location  
Leasehold

@marshandparsons  
marshandparsons.co.uk

MARSH &  
PARSONS



# ABOUT THE PROPERTY

A ground floor studio apartment, with a separate kitchen in a centrally located portered block.

Transport is excellent being within easy walking distance of Gloucester Road, High Street Kensington and Earls Court underground stations (District, Circle and Piccadilly Lines). It is also superbly located for access to both Heathrow and the West via the A4(M).



# STEP INSIDE CROMWELL ROAD

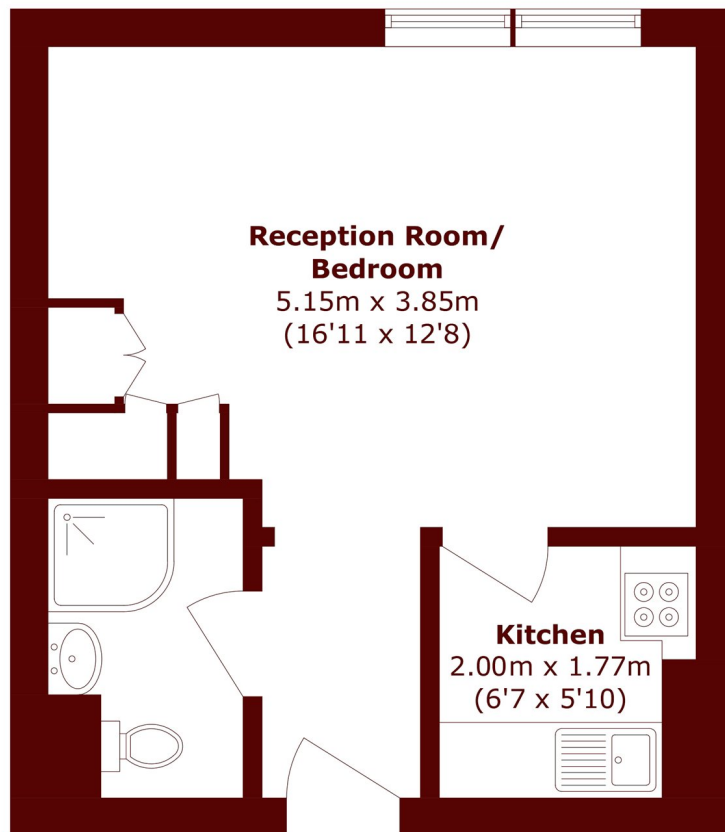

## Ground Floor

Total area (approx.): 30.7 sq. m (330.9 sq. ft)

Kensington  
020 7368 4450

Energy Rating: C We aim to make our particulars both accurate and reliable. However, they are not guaranteed; nor do they form part of an offer or contract. If you require clarification on any points then please contact us, especially if you're traveling some distance to view. Please note that appliances and heating systems have not been tested and therefore no warranties can be given as to their good working order

MARSH &  
PARSONS