



W  
WHITES

9 Woodland Drive, Winterslow, Salisbury, Wiltshire, SP5 1SZ

£325,000 Freehold

## About The Property

Situated in a quiet close in the heart of this popular village with it's great community feel, local shop, school, public house and sports ground is this modern end terrace house with a large corner garden, garage and parking. There is huge potential for further additions to either side or rear. The windows are double glazed and there is a lovely view to the front. There is no onward chain.

The property is situated in a slightly elevated position with a grass bank to the front. Steps lead to a pathway to the front porch which opens into the hall. This has a built in coats cupboard and stairs to the first floor with storage beneath. There is a cloakroom with a white suite. The double aspect living room has a dining area to front and sitting area to rear with sliding doors to the garden. The kitchen has a good range of worksurfaces and fitted units with built in oven, hob and extractor, integrated dishwasher, space and plumbing for washing machine, one and a half bowl sink unit and tiled floor. This is open to the conservatory which is currently used as an extension to the kitchen but would also make a great sun room. From here there is a door to the garden.

On the first floor are two double bedrooms, a single bedroom and a bathroom.

The rear garden has a sitting area and is laid to lawn with numerous mature shrubs and some trees. The garden stretches round to the side where there is a rear pedestrian access path and another pathway leading to the single parking space. Beside this is a garage with light and power and electric roller door.



- Large Garden
- Garage and Parking
- Conservatory
- Three Bedrooms
- Quiet location
- Views to front
- Double Glazing
- No Chain





### Ground Floor

Approx. 45.0 sq. metres (484.7 sq. feet)



### First Floor

Approx. 39.6 sq. metres (426.2 sq. feet)

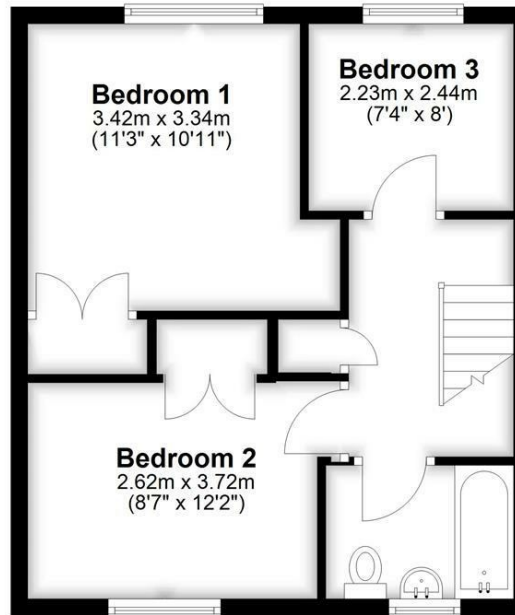

Total area: approx. 84.6 sq. metres (910.9 sq. feet)

## Further Information

Local authority: Wiltshire Council

Council Tax: C - £2096.03 (2025/2026)

Tenure: Freehold

Services: Mains electricity, water and drainage.

Heating: Oil heating with radiators

Directions: From Salisbury take the A30 London Road and after about four miles turn right to Firsdown and Winterslow. Take the first turning left into The Plantation and continue into the village. Continue into Middleton and bear sharp right into Middleton Road. Woodland Drive will then be seen on the right.

What3words: ///enclosing.admit.slows

| Energy Efficiency Rating                    |  | Current                 | Potential |
|---|--|-------------------------|-----------|
| Very energy efficient - lower running costs |  |                         |           |
| (92 plus) <b>A</b>                          |  |                         |           |
| (81-91) <b>B</b>                            |  |                         |           |
| (69-80) <b>C</b>                            |  |                         |           |
| (55-68) <b>D</b>                            |  |                         |           |
| (39-54) <b>E</b>                            |  |                         |           |
| (21-38) <b>F</b>                            |  |                         |           |
| (1-20) <b>G</b>                             |  |                         |           |
| Not energy efficient - higher running costs |  |                         |           |
| <b>England &amp; Wales</b>                  |  | EU Directive 2002/91/EC |           |