



**St Michaels Court, Cheltenham Road, Bishops Cleeve, Cheltenham**  
**£95,000**

**ADAM  
HALLIWELL**  
property

exp UK

**Bedrooms:** 1

**Bathrooms:** 1

**Receptions:** 1

A one bedroom, first floor apartment in this over 55's development within half a mile radius of Bishops Cleeve's amenities. The well presented accommodation offers a good sized lounge with dining area, kitchen with fitted appliances and bedroom with built in wardrobe. There is also a shower room with walk in shower. Communal facilities are provided, parking and grounds to enjoy. Sold with no onward chain.

A one bedroom, first floor apartment in this over 55's development within half a mile radius of Bishops Cleeve's amenities. The well presented accommodation offers a lounge with natural dining area. There is a bright, floor to ceiling window in this room. The lounge leads onto kitchen with fitted oven, fridge and freezer. There is a double bedroom with large mirrored built-in wardrobes. The living room and bedroom is fitted with a modern, updated convector heater, allowing control of temperature to compliment the electric fire. Next to the bedroom is the shower room with large walk in shower (no bath). The hallway has a large store cupboard and also an airing cupboard in the shower room. This is a walk in room and very useful. In addition to the large mirror fronted wardrobe in the bedroom, there is plenty of space. The property is sold with no onward chain.

The communal parking space is generous and the grounds well maintained. There are areas to sit on benches in the grounds and there is an outdoor seating area with table and chairs. The main entrance door is covered by CCTV and is security protected. Once inside you walk through the communal lounge and kitchen area. This lovely room feels like a living room of a grand home and is a place for residents to meet informally for a chat by the fire, or formally for the meetings and functions. The Scheme managers office is here to pop in and see during working hours. There is a laundry room on site, a social place to catch up and meet also. The lift takes you to the apartment.

There is also a guest suite that can be booked with the scheme manager on site





### Property Type: Retirement

A one bedroom, first floor apartment in this over 55's development within half a mile radius of Bishops Cleeve's amenities. The well presented accommodation offers a lounge with natural dining area. There is a bright, floor to ceiling window in this room. The lounge leads onto kitchen with fitted oven, fridge and freezer. There is a double bedroom with large mirrored built-in wardrobes. The living room and bedroom is fitted with a modern, updated convector heater, allowing control of temperature to compliment the electric fire. Next to the bedroom is the shower room with large walk in shower (no bath). The hallway has a large store cupboard and also an airing cupboard in the shower room. This is a walk in room and very useful. In addition to the large mirror fronted wardrobe in the bedroom, there is plenty of space. The property is sold with no onward chain.

The communal parking space is generous and the grounds well maintained. There are areas to sit on benches in the grounds and there is an outdoor seating area with table and chairs. The main entrance door is covered by CCTV and is security protected. Once inside you walk through the communal lounge and kitchen area. This lovely room feels like a living room of a grand home and is a place for residents to meet informally for a chat by the fire, or formally for the meetings and functions. The Scheme managers office is here to pop in and see during working hours. There is a laundry room on site, a social place to catch up and meet also. The lift takes you to the apartment.

There is also a guest suite that can be booked with the scheme manager on site

The complex is off Cheltenham Road which has bus stops offering links into Cheltenham Centre and into Bishops Cleeve. Bishops Cleeve offers doctors, pharmacy, dentists, cafe's, two supermarkets a post office and more.



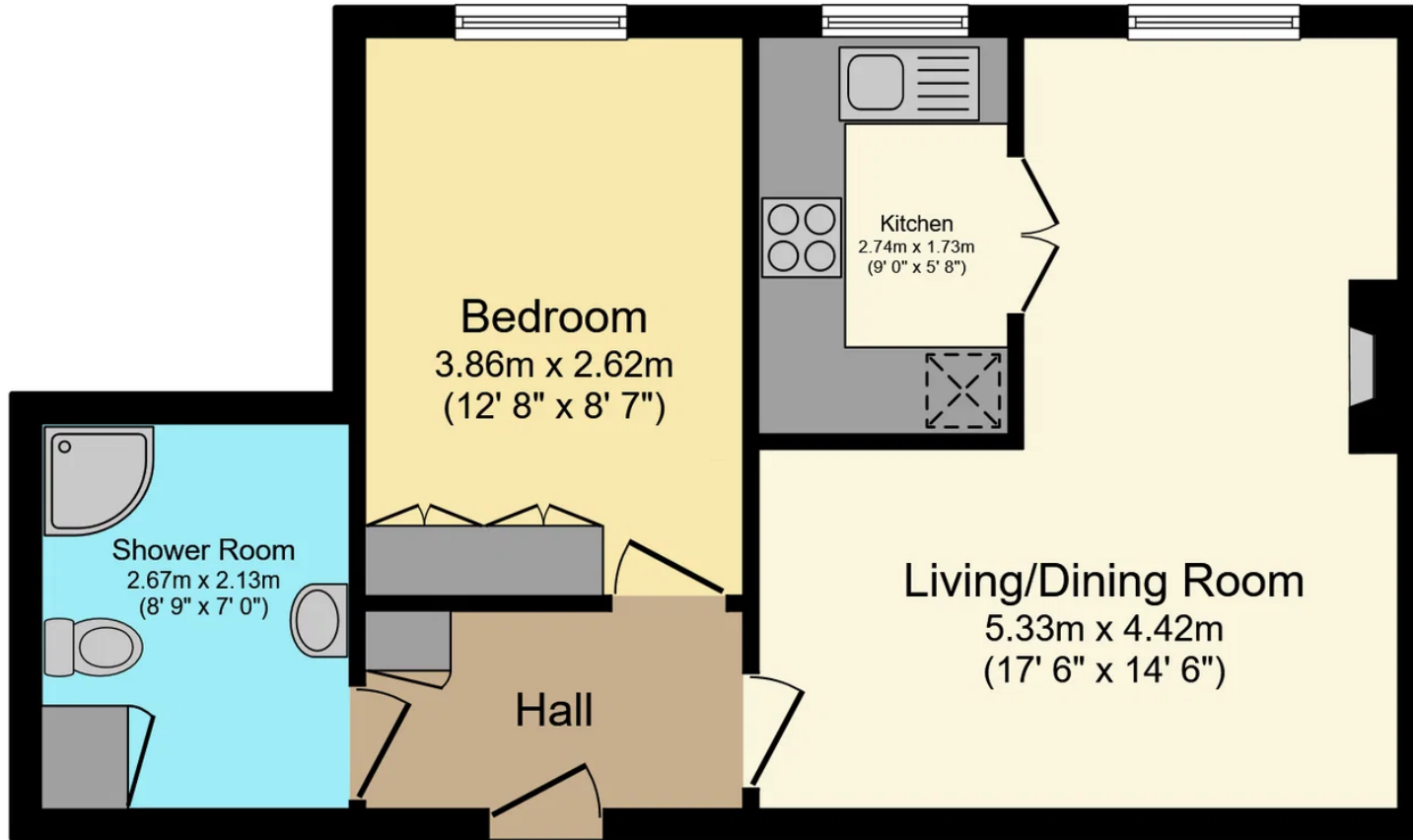

### Floor Plan

Floor area 44.0 sq.m. (474 sq.ft.)

Total floor area: 44.0 sq.m. (474 sq.ft.)

This floor plan is for illustrative purposes only. It is not drawn to scale. Any measurements, floor areas (including any total floor area), openings and orientations are approximate. No details are guaranteed, they cannot be relied upon for any purpose and do not form any part of any agreement. No liability is taken for any error, omission or misstatement. A party must rely upon its own inspection(s). Powered by [www.Propertybox.io](http://www.Propertybox.io)

**St Michaels Court, Cheltenham Road, Bishops Cleeve, Cheltenham**  
**£95,000**

**ADAM  
HALLIWELL**  
property

exp UK