



STEPHENSON BROWNE

George Street,

CW11 3BL



£800 PCM

Description

Nestled in the heart of a popular location of George Street in Elworth, this charming two-bedroom end-terrace home offers a delightful blend of comfort and convenience. With two spacious reception rooms, this property is perfect for both relaxation and entertaining guests. There is a fitted kitchen with appliances and also a well-appointed shower room, adding to the practicality of the home.

The two double bedrooms provide ample space, plus a family bathroom makes it an ideal choice for couples or small families. There is a good sized rear yard and off road parking available. Situated within walking distance of Sandbach train station, ensuring easy access to local amenities and transport links. Available August 2026.

Pets considered via written application only.



Viewing

Please contact our office using the details provided on the final page if you are interested in booking a viewing or require further information.

Floorplans

1 George Street, Elworth, Sandbach, CW11 3BL

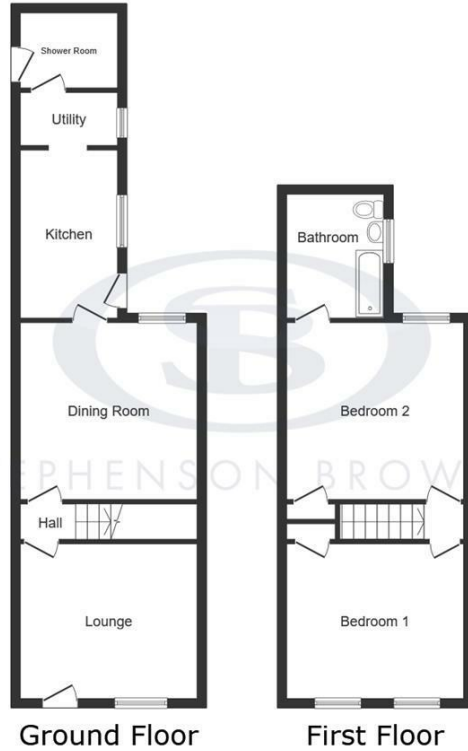

Total floor area: 89.8 sq.m. (966 sq.ft.)

This floor plan is for illustrative purposes only. It is not drawn to scale. Any measurements, floor areas (including any total floor area), openings and orientations are approximate. No details are guaranteed, they cannot be relied upon for any purpose and do not form any part of any agreement. No liability is taken for any error, omission or misstatement. A party must rely upon its own inspection(s). Powered by www.Propertybox.io



Area Map



Energy Efficiency Rating		Environmental Impact (CO ₂) Rating	
	Current	Potential	
Very energy efficient - lower running costs			Very environmentally friendly - lower CO ₂ emissions
(92 plus) A			(92 plus) A
(81-91) B			(81-91) B
(69-80) C			(69-80) C
(55-68) D			(55-68) D
(39-54) E			(39-54) E
(21-38) F			(21-38) F
(1-20) G			(1-20) G
Not energy efficient - higher running costs		Not environmentally friendly - higher CO ₂ emissions	
England & Wales		England & Wales	
	EU Directive 2002/91/EC		EU Directive 2002/91/EC

	Current	Potential
67		85

	Current	Potential

NOTICE: Stephenson Browne for themselves and for the vendors or lessors of this property whose agents they are give notice that: (1) the particulars are set out as a general guideline only for the guidance of intending purchasers or lessees, and do not constitute, nor constitute part of, an offer or contract; (2) all descriptions, dimensions, references to condition and necessary permissions for use and occupation, and other details are given in good faith and are believed to be correct but any intending purchasers or tenants should not rely on them as statements or representations of fact but must satisfy themselves by inspection or otherwise as to the correctness of each theme; (3) no person in the employment of Stephenson Browne has any authority to make representation or warranty whatever in relation to this property. (4) fixtures & fittings are subject to a formal list supplied by the vendors solicitors. **Referring to:** Move with Us Ltd **Average Fee:** £123.64

T: 01270 763200 opt 2 E: sandbachlettings@stephensonbrowne.co.uk

www.stephensonbrowne.co.uk