

est 1979

Jeremy
Leaf & Co.



Nether Street, North Finchley

£599,000

- Two Bathrooms (One en suite)
- Current Rental income £1,850pcm
- 0.5miles to Woodside Park Tube Station
- Reception Room
- Kitchen
- New share of freehold lease to be granted
- Three Bedrooms

863 High Road, London, N12 8PT
020 8446 4295

property@jeremyleaf.co.uk
<https://www.jeremyleaf.co.uk/>

Nether Street, North Finchley, N12 7NP

A well-presented three bedroom, two bathroom (one ensuite) flat on the first floor of a three-storey conversion. Located 0.5 miles to Woodside Park (Northern Line) station, this property would make a good first time buy or rental investment. Current rental income of £1,850pcm. Click on the virtual tour for more information.



Council Tax Band: D





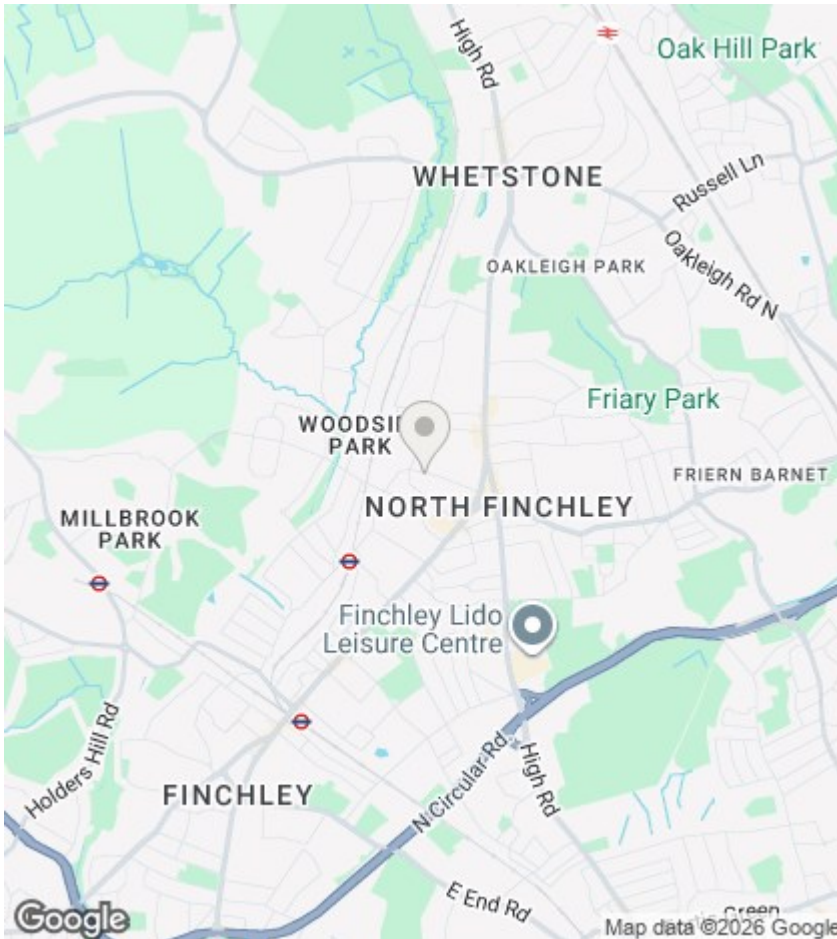

Directions

Viewings

Viewings by arrangement only. Call 020 8446 4295 to make an appointment.

EPC Rating:

Energy Efficiency Rating		
	Current	Potential
Very energy efficient - lower running costs		
(92 plus) A		
(81-91) B		
(69-80) C		
(55-68) D		
(39-54) E		
(21-38) F		
(1-20) G		
Not energy efficient - higher running costs		
England & Wales	EU Directive 2002/91/EC	

Approx Gross Internal Area
59 sq m / 639 sq ft

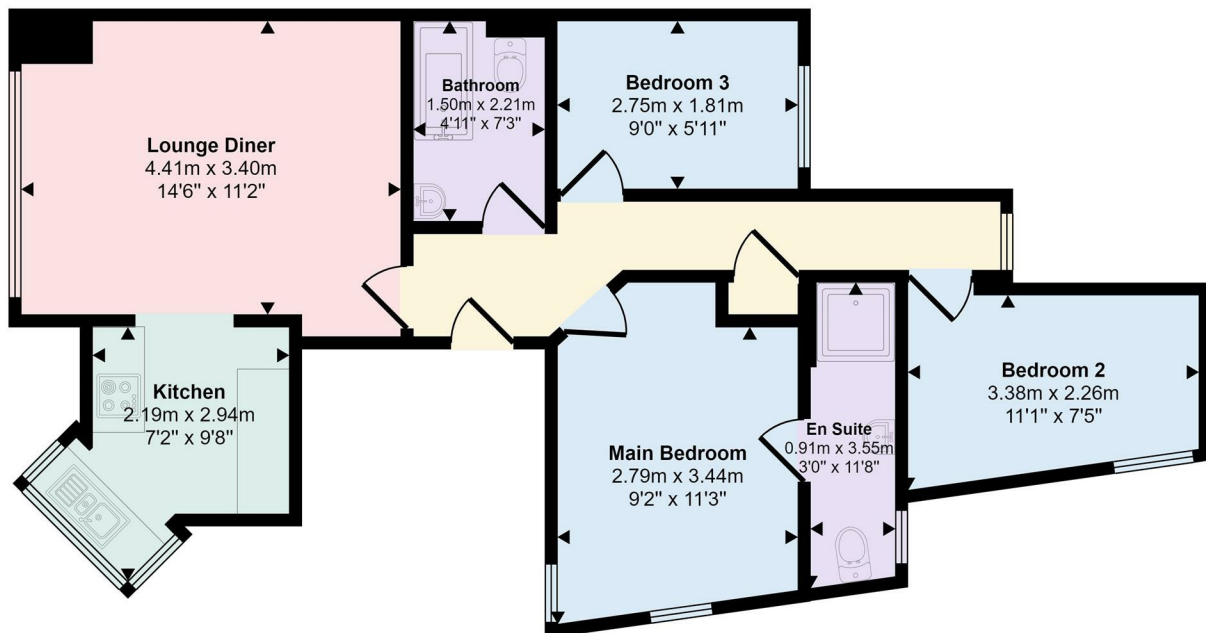

Floorplan

This floorplan is only for illustrative purposes and is not to scale. Measurements of rooms, doors, windows, and any items are approximate and no responsibility is taken for any error, omission or mis-statement. Icons of items such as bathroom suites are representations only and may not look like the real items. Made with Made Snapov 360.