



**48, CANMORE  
CRESCENT, GREENOCK, PA16 7LX**



 **neillclerk**  
ESTATE AGENTS



## Description

Occupying a popular location this three bedroom SEMI DETACHED VILLA offers an ideal family home. This is the first time this house has been on the market and just one family have lived here since the property was built in 1962. Enclosed lawned gardens extend to the front and rear. There are two store rooms accessed from the exterior of the house. A degree of upgrading and redecoration is required which is reflected in the asking price.

Specification includes: double glazing and gas central heating. Loft accessed by hatch from the upper landing. Conveniently positioned for local shops, schooling and transport facilities. There are views beyond surrounding properties towards the countryside and distant aspects towards the mountains on Arran.

Apartments comprise: Entrance Porch by double glazed sliding door with side panel leads in turn by further UPVC double glazed door with single glazed side panel to the Hallway which has an understair cupboard. There is a bright front facing Lounge with fireplace (NB the gas fire is not operational).

The rear facing Kitchen overlooks the garden featuring white fitted units and high gloss marble style work surfaces. Appliances include: stainless steel gas hob, electric oven, fridge/freezer, washing machine and tumble dryer. A UPVC double glazed door leads to the garden.

Stairs lead to the Upper Landing with side window and hatch to the loft. There are two double sized Bedrooms and 3rd single Bedroom. The front facing bedrooms benefit from views towards Spango Valley with the Isle of Arran in the far distance. The Wet Room with rear window offers a pedestal wash hand basin, wc and "Mira" shower. There is a wet floor, plus wet wall panelling.

Early inspection essential for this affordable three bedroom family home. EPC = D

## Measurements

Entrance Porch

Hallway

Lounge

5.00m x 3.94m (16'5 x 12'11)

Kitchen

4.75m x 2.08m (15'7 x 6'10)

Upper Landing

Bedroom 1

3.43m x 3.89m (11'3 x 12'9)

Bedroom 2

3.78m x 3.15m (12'5 x 10'4)

Bedroom 3

2.92m x 2.46m (9'7 x 8'1)

Wet Room

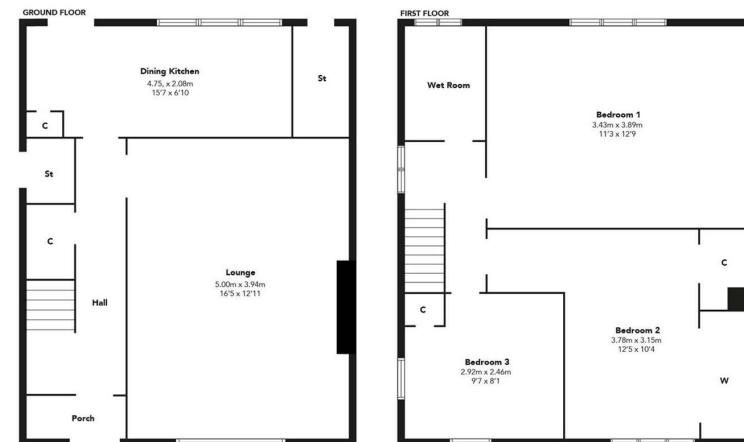

Floorplans are indicative only - not to scale  
Produced by Plusplans 







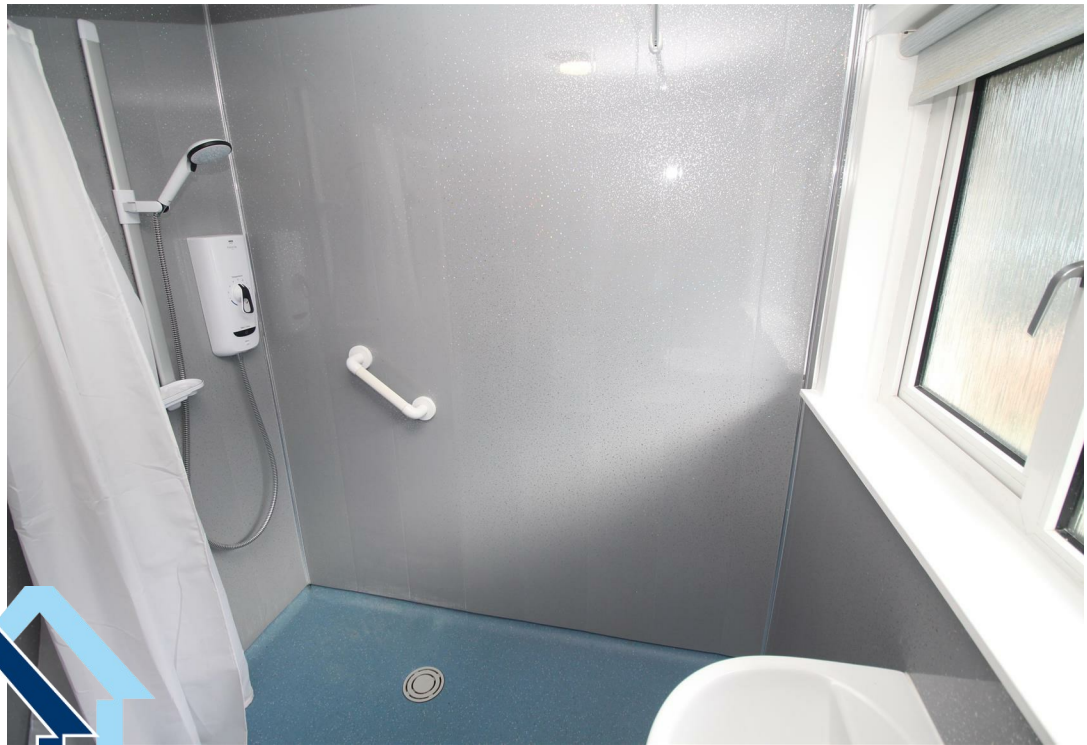



The  
next  
step..



To view call 01475 888400. Speak to us 7 days a week until 11pm every day to book your viewing appointment.

**House to sell or rent?**

Call 01475 888400 to book your free market appraisal.

**Require a solicitor?**

Ask us to supply a free legal quotation from Neill Clerk & Murray, Solicitors.  
[www.neillclerkmurray.co.uk](http://www.neillclerkmurray.co.uk)

Stay fully up-to-date by following Neill Clerk on:



**60 West Blackhall Street  
Greenock  
Renfrewshire  
PA15 1UY**

**t: 01475 888400**

**e: [sales@neillclerk.co.uk](mailto:sales@neillclerk.co.uk)**

**w: [www.neillclerk.co.uk](http://www.neillclerk.co.uk)**



**Agents Notes:**

These sales particulars are set out as a general outline only, issued in good faith, but do not constitute representations of fact and do not form part of any offer or contract. Any services, equipment, appliances, fittings or central heating systems have not been tested and no warranty is given or implied that these are in working order. All measurements are approximate and for guidance only.

Neither Neill Clerk Estate Agents nor any of its employees or agents has any authority to make or give any representation or warranty whatever in relation to this property.

Find all our properties at: [rightmove](https://www.rightmove.co.uk) [Zoopla](https://www.zoopla.co.uk) [onTheMarket.com](https://www.onthemarket.com) [s1homes.com](https://www.s1homes.com)