



Connells

Ermine Street North
Papworth Everard



Set back from the road, this welcoming four-bed townhouse offers bright, comfortable living spaces with gardens to front and back. Spacious bedrooms, one with ensuite, and a part converted garage space offering the perfect opportunity for a home office.

Entrance Hall

Door to front, stairs to first floor landing, radiator.

Cloakroom

Wash hand basin, WC, tiled splash back, tiled flooring, extractor fan, radiator.

Kitchen/Diner

Windows to rear and side, fitted kitchen with a range of wall and base units, complementary work surface, stainless steel sink with one and a half bowl and drainer, tiled splash back, electric oven, gas hob, stainless steel cooker hood, extractor fan, plumbing for dishwasher, french door to rear.

Utility Room

Base units, work surface, stainless steel sink and drainer, tiled splash back, tiled floor, extractor fan, plumbing for washing machine, space for drier.

Lounge

Window to front, television point, under stairs cupboard, radiator, restricted head height.

First Floor Landing

Stairs to ground floor and second floor landing, airing cupboard, radiator.



Bedroom One

Window to rear, double built in wardrobe, television point, telephone point, radiator.

Ensuite

Shower cubicle, wash hand basin, WC, part tiled, extractor fan, heated towel rail.

Bedroom Two

Window to front, double built in wardrobe, two fitted bedside units, radiator.

Bathroom

Bath with mixer taps and shower over, glass screen, wash hand basin, WC, shaver point, extractor fan, part tiled, radiator.

Second Floor Landing

Stairs to first floor landing, loft access, radiator.

Bedroom Three

Window to rear, radiator, restricted head height, radiator.

Bedroom Four

Window to front, radiator, restricted head height, radiator.

Rear Garden

Patio area, artificial lawn, path to garage, outside light, outside tap, gate to side.

Garage And Parking

Single garage with up and over door, light and power, part converted ideal for home office, loft access, radiator.







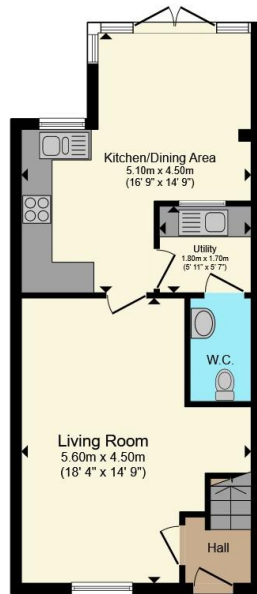

Ground Floor

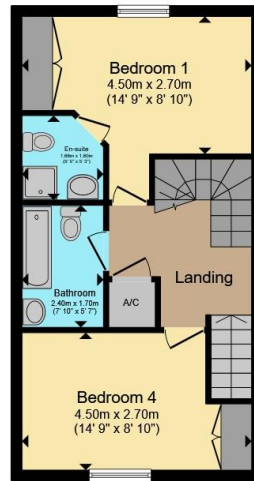

First Floor

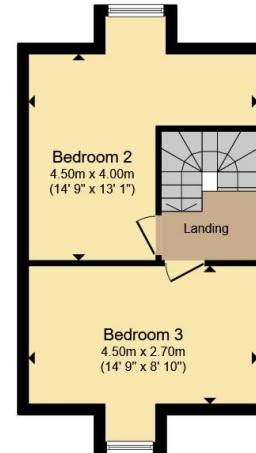

Second Floor

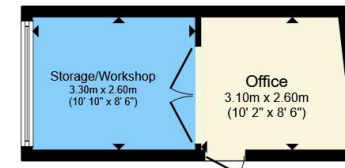

Outbuilding

Total floor area 134.5 m² (1,447 sq.ft.) approx

This floor plan is for illustrative purposes only. It is not drawn to scale. Any measurements, floor areas (including any total floor area), openings and orientation are approximate. No details are guaranteed, they cannot be relied upon for any purpose and they do not form part of any agreement. No liability is taken for any error, omission or misstatement. A party must rely upon its own inspection(s). Powered by www.propertybox.io



To view this property please contact Connells on

T 01954 714900
E cambourne@connells.co.uk

Unit 2 Caxton House Broad Street Great Cambourne
 CAMBRIDGE CB23 6JN

EPC Rating: C Council Tax
 Band: D

Tenure: Freehold

view this property online connells.co.uk/Property/CBN306634



1. MONEY LAUNDERING REGULATIONS Intending purchasers will be asked to produce identification documentation at a later stage and we would ask for your co-operation in order that there will be no delay in agreeing the sale. 2. These particulars do not constitute part or all of an offer or contract. 3. The measurements indicated are supplied for guidance only and as such must be considered incorrect. Potential buyers are advised to recheck measurements before committing to any expense. 4. We have not tested any apparatus, equipment, fixtures, fittings or services and it is in the buyers interest to check the working condition of any appliances.

Connells Residential is registered in England and Wales under company number 1489613, Registered Office is Cumbria House, 16-20 Hockliffe Street, Leighton Buzzard, Bedfordshire, LU7 1GN. VAT Registration Number is 500 2481 05.

See all our properties at www.connells.co.uk | www.rightmove.co.uk | www.zoopla.co.uk

Property Ref: CBN306634 - 0004