



Guide Price
£240,000

Freehold

3x  1x  2x 

**Rose Street, Rochester,
Kent, ME1**

OVER 60?

Secure this property
for up to **59% less!**

Wards
Helping you move forwards



Main features

- Perfect first time buy or investment opportunity
- Modern kitchen and bathroom
- Low maintenance rear garden
- Ready to move straight into!
- Close to the historic High Street and high speed station

Accommodation

GROUND FLOOR

- Lounge: 11'3 x 10'11 (3.43m x 3.33m)
- Dining Room: 11'3 x 10'11 (3.43m x 3.33m)
- Kitchen: 8'5 x 5'7 (2.57m x 1.70m)
- Bathroom: 6'6 x 5'6 (1.98m x 1.68m)

SPLIT LEVEL FIRST FLOOR

- Landing
- Bedroom 1: 11'4 x 10'11 (3.46m x 3.33m)
- Bedroom 2: 10'11 x 9'11 (3.33m x 3.02m)
- Bedroom 3: 7'8 x 5'9 (2.34m x 1.75m)

OUTSIDE

- Rear Garden

Ground Floor

Approx. 36.9 sq. metres (396.7 sq. feet)

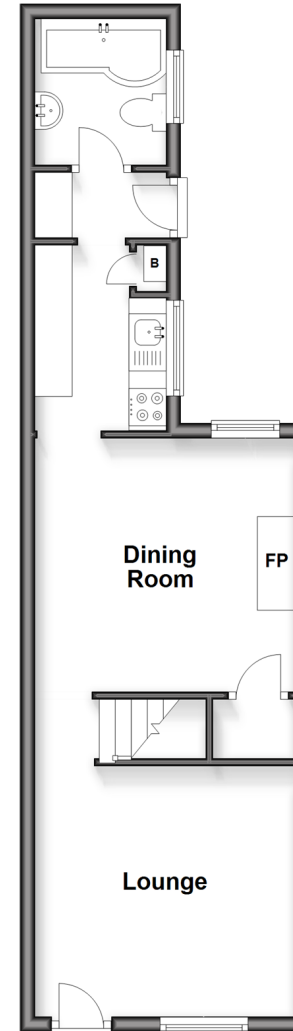

Split Level First Floor

Approx. 31.5 sq. metres (339.3 sq. feet)

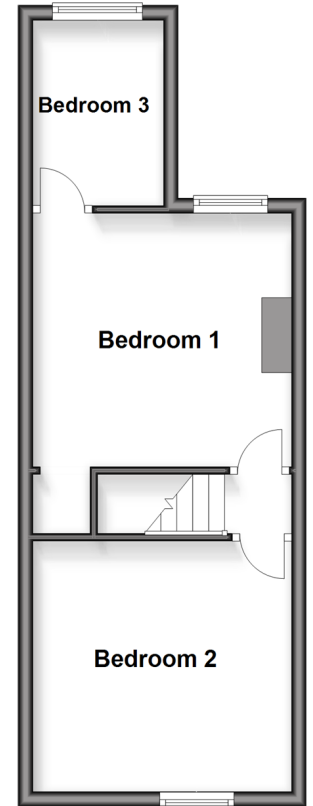

Call Rochester - 01634 830925 ■ wardsokent.co.uk

■ Through a Homewise Home For Life Plan people aged 60+ can secure this property for up to 59% less, by purchasing a Lifetime Lease



11530305/20260318/SN/SN